



| Table of Content | Chapter | Page |
|---|----------------|--------------|
| History of the MP40 | D-01 | 03 |
| Product Description | D-02 | 04-05 |
| General Instructions / Safety Regulations | D-03 | 06 |
| Technical Data of the GSG-MP40 Carbine | D-04 | 07 |
| Technical Data of the GSG-MP40 Pistol | D-05 | 08 |
| Main Parts / Assembly Groups of the GSG-MP40 Carbine | D-06 | 09 |
| Main Parts / Assembly Groups of the GSG-MP40 Pistol | D-07 | 10 |
| Safety Arrangement | D-08 | 11 |
| Transporting the Gun | D-09 | 12 |
| Handling the Gun | D-10 | 12 |
| General | D-11 | 12 |
| Ammunition | D-12 | 12 |
| Loading the Magazine | D-13 | 13 |
| Loading the Gun (ready for firing) | D-14 | 14 |
| Firing | D-15 | 15 |
| Reloading during Firing | D-16 | 16-17 |
| Unloading the Gun (Magazine not empty) | D-17 | 18 |
| Unloading the Gun (Magazine empty) | D-18 | 19 |
| Decocking the Rifle | D-19 | 20 |
| Setting the Rear Sight | D-20 | 21 |
| Exchange the Front Sights | D-21 | 22 |
| Maintenance of the Gun | D-22 | 23 |
| Disassemble of the Gun | D-23 | 23 |
| Cleaning the Breech System | D-24 | 25 |
| Fold up the Buttstock | D-25 | 26 |
| Adjust Trigger Pull Weight | D-26 | 27 |
| Care of the Gun | D-27 | 28 |
| Trouble Shooting, Fault Removal | D-28 | 28 |
| Servicing | D-29 | 29 |
| Safekeeping and Storage of the Gun | D-30 | 30 |
| Shipping the Gun | D-31 | 30 |
| Accessories | D-32 | 31 |
| Disposal | D-33 | 31 |
| Spare-Parts List | D-34 | 31 |

D-01: History of the MP40

The MP 40 (MP designates Maschinenpistole.) was a submachine gun developed in Nazi Germany and used extensively by Fallschirmjäger (paratroopers), platoon and squad leaders, and other troops during World War II. Both weapons were often erroneously called the Schmeisser, despite Hugo Schmeisser's non-involvement in their design and production.

The MP 40 descended from its predecessor, the MP 38, which was in turn based on the MP 36, a prototype made of machined steel. The MP 36 was developed independently by Erma Werke's Berthold Geipel with funding from the German Army. It took design elements from Heinrich Vollmer's VPM 1930 and EMP. Vollmer then worked on Berthold Geipel's MP 36 and in 1938 submitted a prototype to answer a request from the German Armament services for a new submachine gun, which was adopted as MP 38. The MP 38 was a simplification of the MP 36, and the MP 40 was a further simplification of the MP 38, with certain cost-saving alterations, notably in the more extensive use of stamped steel rather than machined parts.

The MP 40 was often called the "Schmeisser" by the Allies, after weapons designer Hugo Schmeisser. Schmeisser had designed the MP 18, which was the first mass-produced submachine gun, and saw extensive service at the end of the First World War. He did not, however, design the MP 40, although he held a patent on the magazine. He later designed the MP 41, which was an MP 40 with a wooden rifle stock and a selector, identical to those found on the earlier MP 28 submachine gun. The MP 41 was not introduced as a service weapon with the German Army, but saw limited use with some SS and police units. They were also exported to Germany's ally, Romania. The MP 41's production run was brief, as Erma filed a successful patent infringement lawsuit against Schmeisser's employer, Haenel.

Despite the impression given by popular culture, particularly in war films and video games, MP 40s were generally issued only to paratroopers and platoon and squad leaders; the majority of German soldiers carried Karabiner 98k rifles. However, later experience with Soviet tactics - such as the Battle of Stalingrad where entire units armed with submachine guns outgunned their German counterparts in short range urban combat - caused a shift in tactics, and by the end of the war the MP 40 and its derivatives were being issued to entire assault platoons on a limited basis.

There were never enough MP 40s to go around, because raw material and labor costs made it expensive to produce alongside the Kar98 rifles, which, for troops finding themselves more and more in assault roles, meant that the Russian PPSH-41 was sometimes scavenged from the battlefield to fill the need. Examples of this are visible in more than a few wartime photos. Starting in 1943, the German army moved to replace both the Kar-98k rifle and MP 40 with the new MP 43/44 assault rifle, also known later as the StG 44.

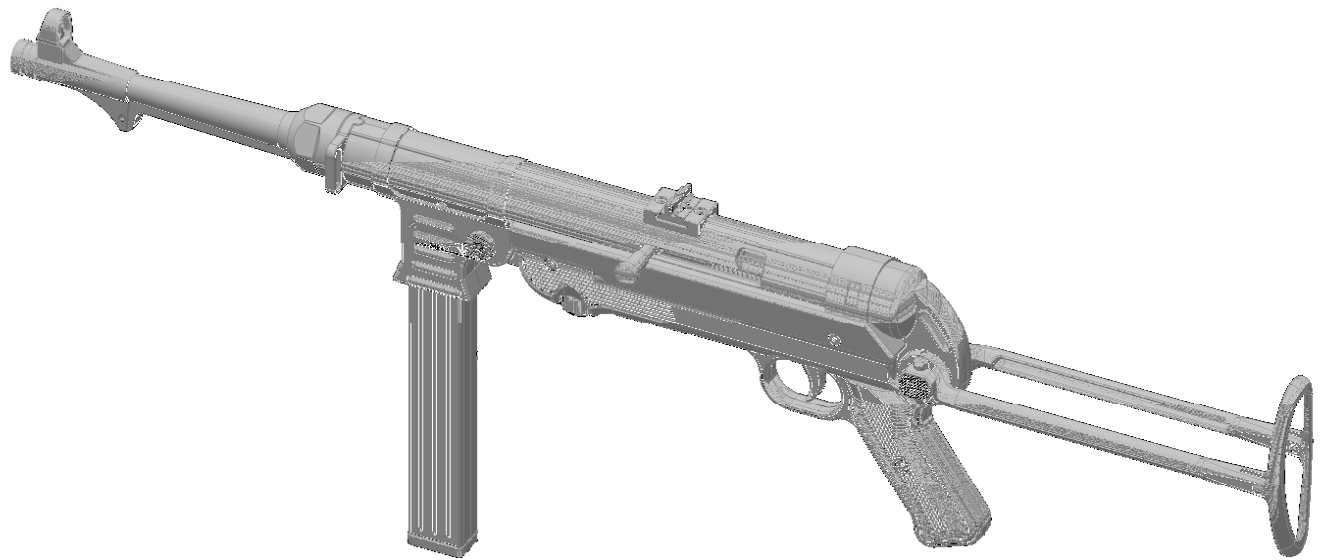
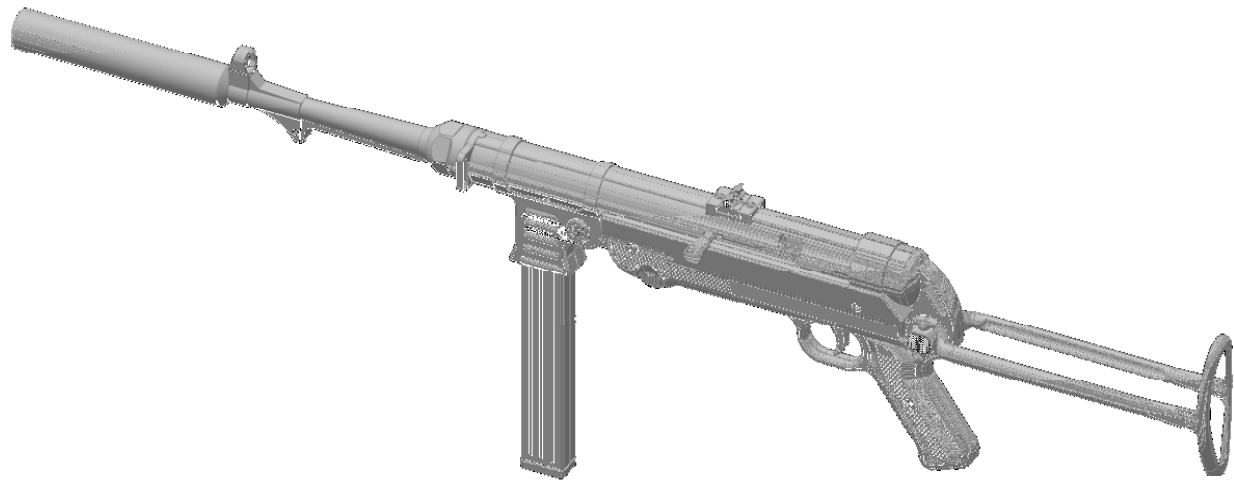

D-02: Product Description:

Dear Customer,

This Gun has been constructed for the sub-caliber ammunition „cal. 22 Long Rifle HV“. Because of the huge scope of ammunition for caliber 22, we have decided to adjust the GSG-MP40 to standard and HV-ammunition.

There will be an accessories kit with extension and modification parts, which will be available at your specialist retailer. This allows you to accommodate the GSG-MP40 to your individual needs.

We wish you a lot of pleasure with our product.

info@germansportguns.de

www.gsg-mp40.de

D-03: General instructions / Safety regulations

Never use the gun under the influence of drugs or alcohol, while ill or suffering other such difficulties.

These conditions can impair your powers of judgment and reflexes.

Always think of the gun as being loaded and with the safety off until you have established the opposite through the unloading procedure.

Always keep the muzzle of the gun in a safe direction when handling. A safe direction is towards an area where there are no people, other life forms or property that is not a recognized target.

Never point the gun at doors, panes of glass, walls, concrete, stone or flat surfaces (water included).

A bullet can penetrate such surfaces or be ricocheted in an unsafe direction.

Never aim at yourself or other life forms.

Never rely on safety mechanisms alone. Safety mechanisms are not a substitute for careful, correct and secure handling of the gun.

Always treat your gun as if the safety mechanisms were not functioning. The best safety precaution is a correct, well-trained and safe handling of the gun.

Never shoot with a gun which has been penetrated by water, sand, dirt or other foreign bodies.

Never decock the hammer by holding on to the hammer and pulling the trigger at the same time.

Never let a loaded gun out of your hand.

Always unload the gun immediately after firing, before putting the gun away, putting into a holster or handing to another authorized person.

Never give the gun to a person who has not thoroughly familiarized himself or herself with the safety instructions and handling of gun, by reading the corresponding instructions.

Never leave the gun lying unattended and protect the gun from unauthorized access.

Never store the gun loaded, but rather remove the magazine and ensure that no cartridge is left in the chamber of the barrel.

Always keep the gun and the ammunition separated from each other, and ensure that neither is obtained by unauthorized persons or children.

Always wear safety glasses and hearing protection while shooting. The same counts for every other person near you.

D-04: Technical Data of the GSG-MP40 Carbine:

GSG-MP40 Carbine

Caliber .22 Long Rifle HV

Overall Length = 986 mm / 38,8 inch

Overall Height = 219 mm / 11,5 inch

Width = 79 mm / 3,1 inch

Barrel Length = 414 mm / 16,3 inch

Twist Length = 406 mm / 16 inch

Length between Sights = 397 mm / 15,6 inch

Weight without magazine = 3,46 kg

Weight of empty magazine = 150 gram

Trigger Pull = ca. 3,2 kg / 32 N

Content of Magazine = 24 / 10 Rounds

What's Included:

1 Rifle

1 Magazine

1 Manual

1 short, snapped off Brush

3 Allen key

1 Snap Cap

4 additional Front Sights

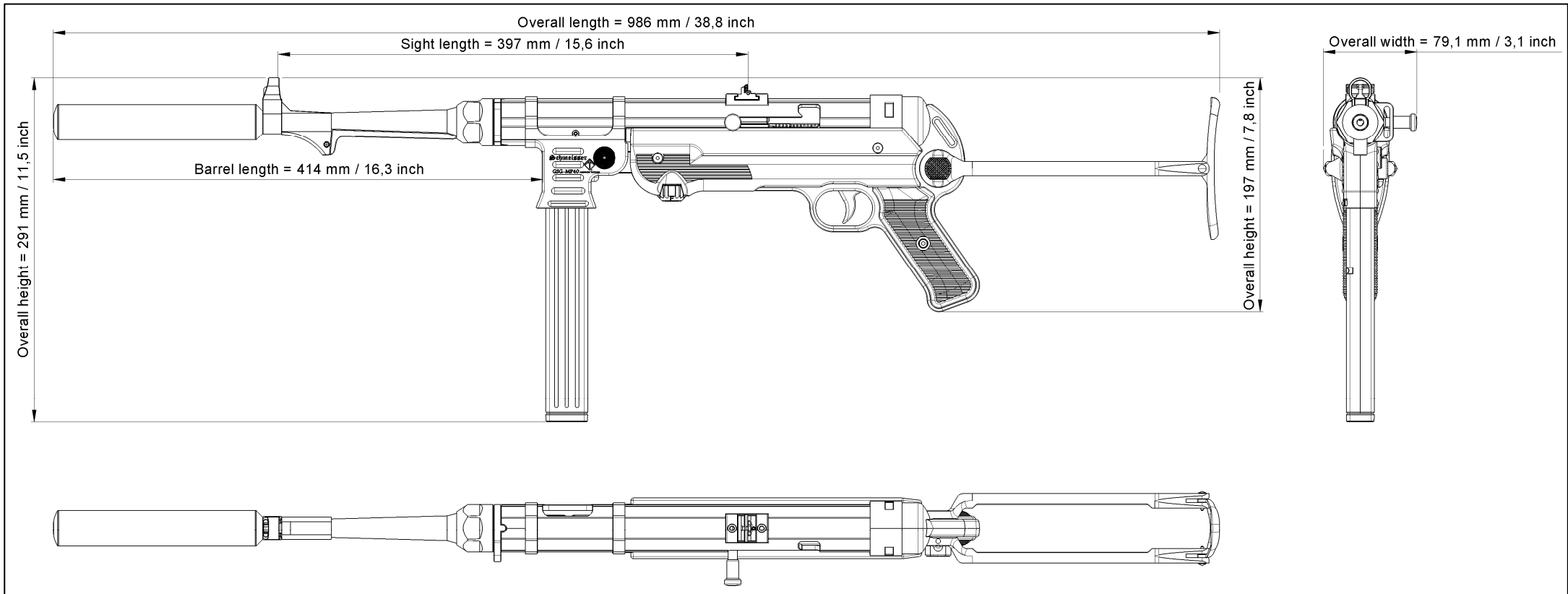

D-05: Technical Data of the GSG-MP40 Pistol:

GSG-MP40 Pistol

Caliber .22 Long Rifle HV

Overall Length = 595 mm / 23,4 inch

Overall Height = 219 mm / 11, 5 inch

Width = 79 mm / 3, 1 inch

Barrel Length = 253 mm / 10 inch

Twist Length = 406 mm / 16 inch

Length between Sights = 397 mm / 15, 6 inch

Weight without Magazine = X, X kg

Weight of the empty Magazine= 150 gram

Trigger Pull = ca. SA 3, 2 kg / 32 N

Content of the Magazine = 24 / 10 Rounds

What's Included:

1 Rifle

1 Magazine

1 Manual

1 short, snapped off brush

3 Allen Key

1 Snap Cap

4 additional Front Sights

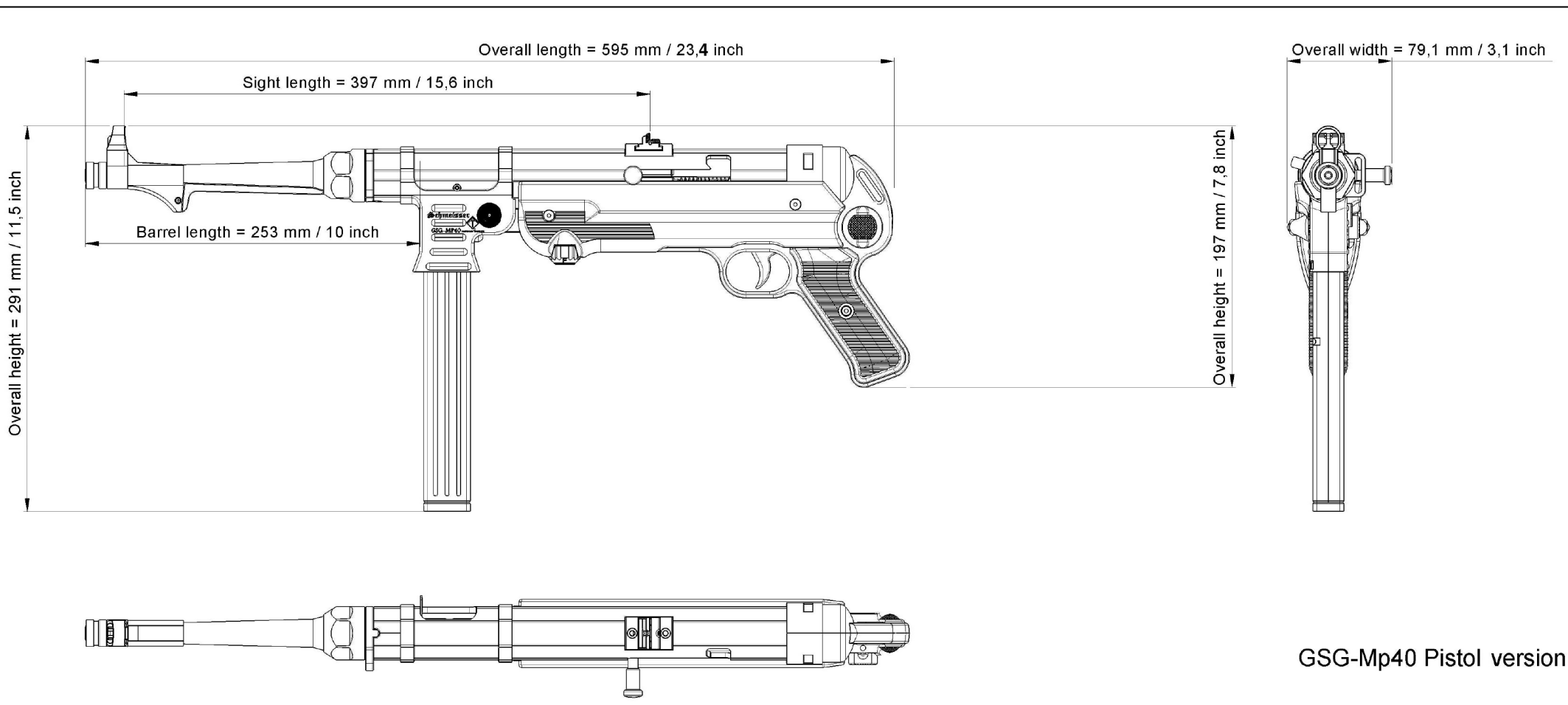

D-06: Main Parts / Assembly Groups of the GSG-MP40 Carbine:

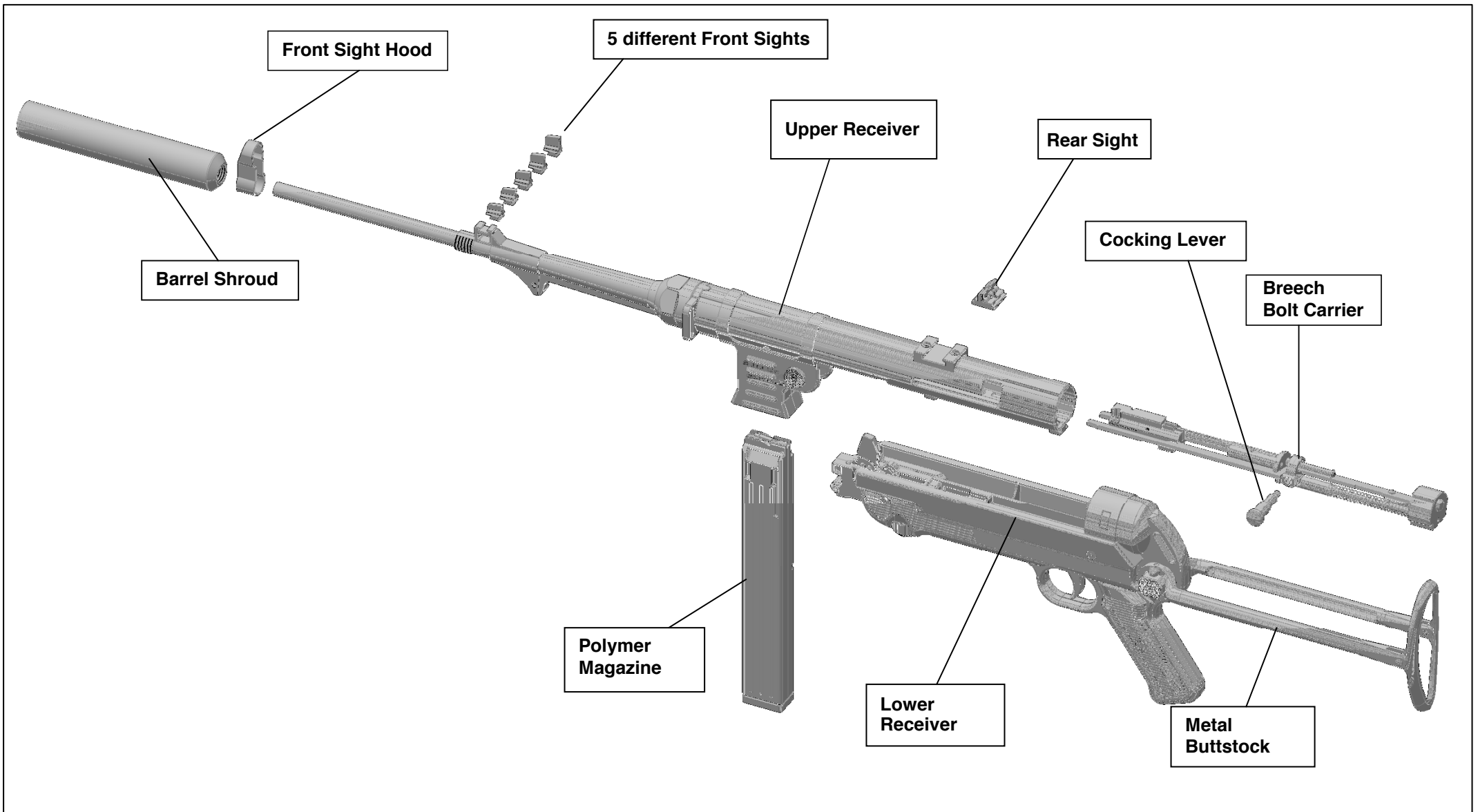

D-07: Main Parts / Assembly Groups of the GSG-MP40 Pistol:

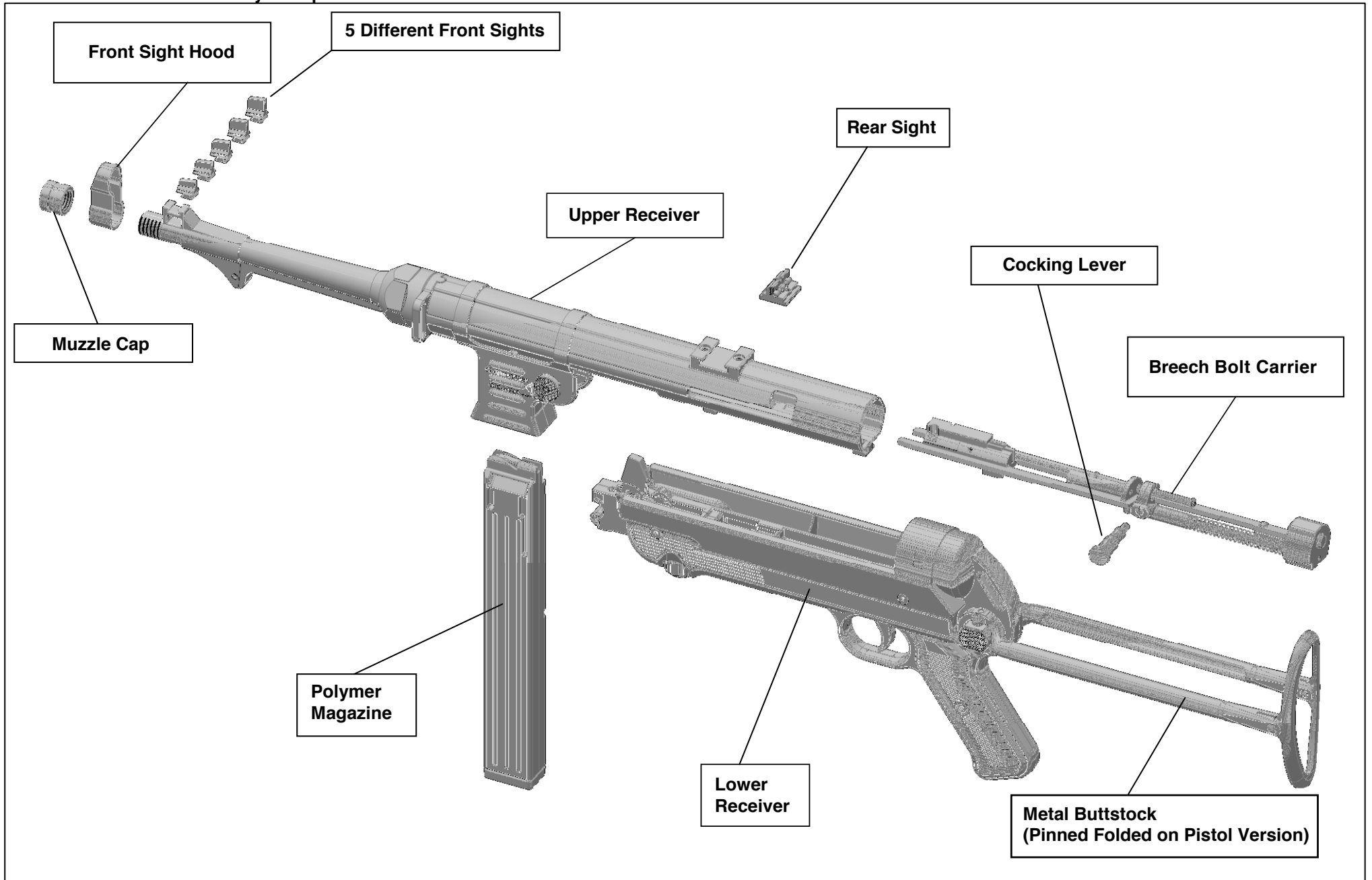

D-08: Safety Mechanism:

Advice:

GSG-MP40 is disposed of a safety lever, which blocks the trigger, so that the gun can not be fired anymore.

Procedure:

- Turn the safety lever into position "S" to block the trigger (Arrow across the direction of firing). "Safe"- Position.
(ill. 1, p. 11)
- Turn the safety lever into position "F" to set the trigger free. (Arrow shows into the direction of firing). "Fire"- Position.
(ill. 2, p. 11)

„S“= SAFE / „F“= FIRE

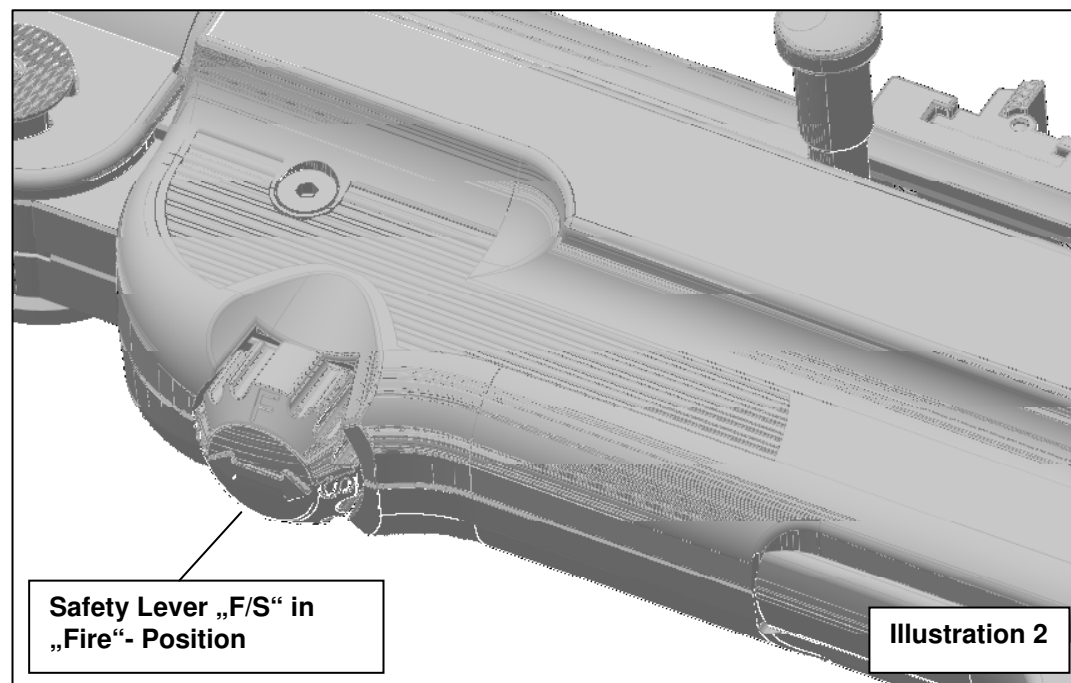
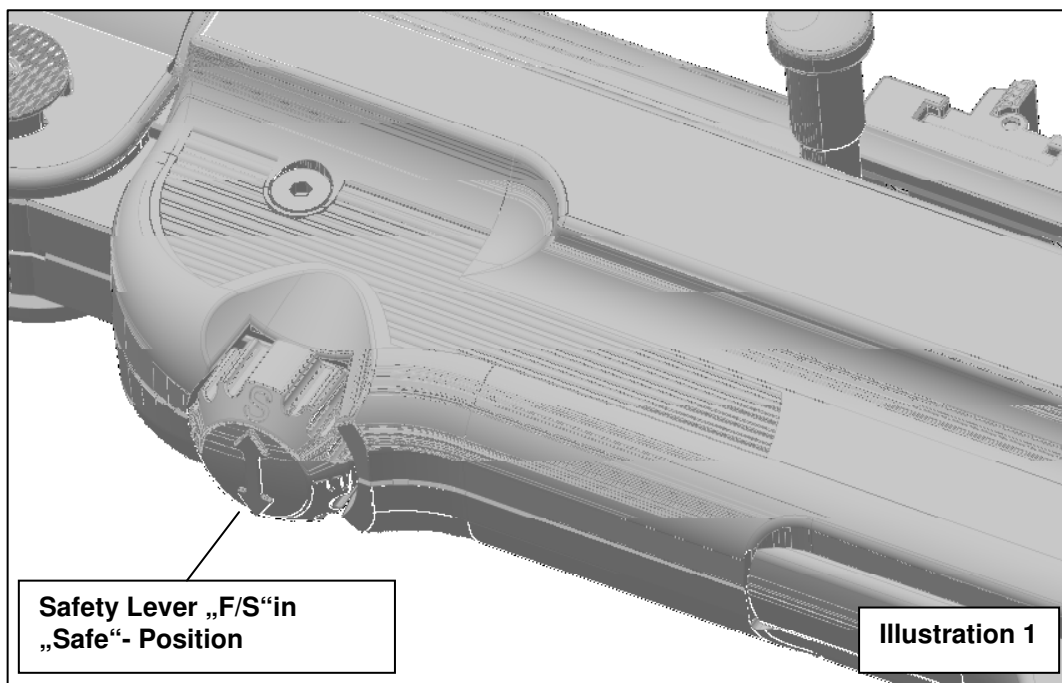

D-09: Transporting the Gun:

- For your own safety and the safety of others, always transport the gun unloaded, decocked and closed with the snap cap inside of the chamber.
- Never carry a gun with you that has already been cocked and which has a round in the chamber.
- Always transport the gun in such a way, that you can control the muzzle in case you slip or fall
- Transport the gun and its ammunition separated from each other.
- Make sure that you obey all regional and national laws governing the transportation of firearms.

D-10: Handling the Gun:

- Never carry a gun with you that has already been cocked and which has a round in the chamber.
- Always transport the gun in such a way, that you can control the muzzle in case you slip or fall

D-11: General:

The gun is generally delivered preserved with a thin, protective grease and oil coating.

D-12: Ammunition:

For your gun, use only commercial grad ammunition in its original packaging, that corresponds with the caliber of the gun. The correct caliber is imprinted on the gun.

Never use reloaded, restored, hand-loaded or non standard ammunition of a different caliber.

Never use dirty, wet, corroded, bent, damaged or oiled ammunition.

Never leave the ammunition lying unattended

Information about the sorts of ammunition:

The .22 ammunition spectrum ranges from very light loads for single loader guns to sport load, utility load and on through to high speed rounds. Unfortunately, however, it is not possible to adjust a semi-automatic gun to all loads. We have therefore decided to make an adjustment to the loads that have priority for use with the GSG-MP 40 which are high quality standard and HV rounds.

D-13: Loading the magazine:

Procedure:

1. Put the round on the feeder near the magazine slice (ill. 1, p. 13)
2. Pull down on the thumb piece.
3. Insert the round into the backside of the magazine. (ill. 2, p. 13)
4. Insert only as many rounds in the magazine as you want to fire.
(max. 24 / 10 rounds)

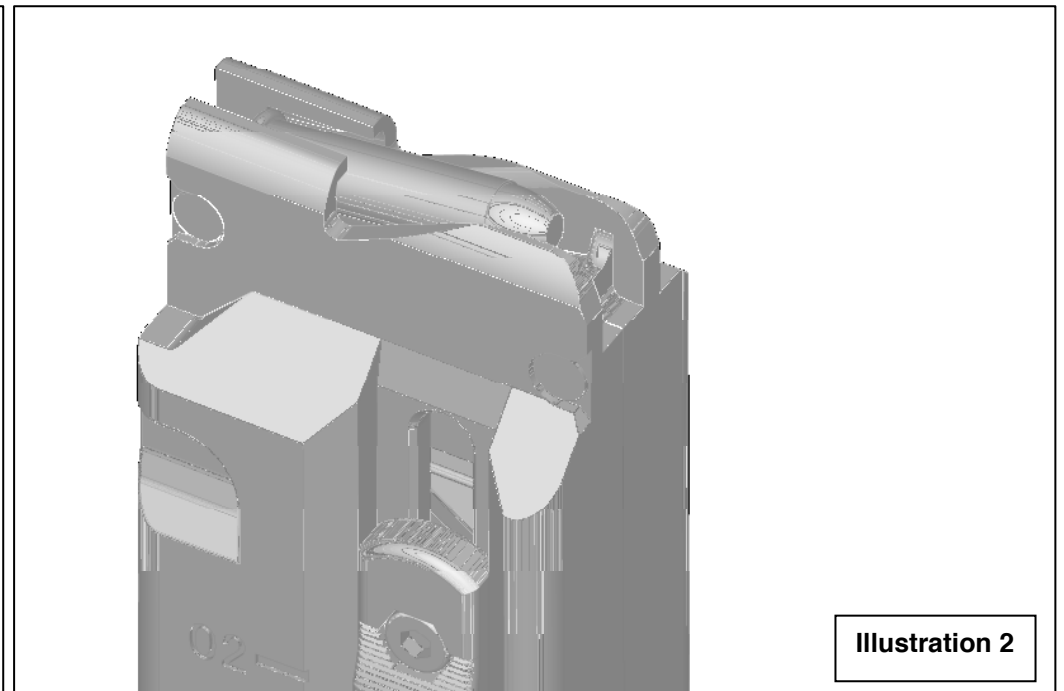
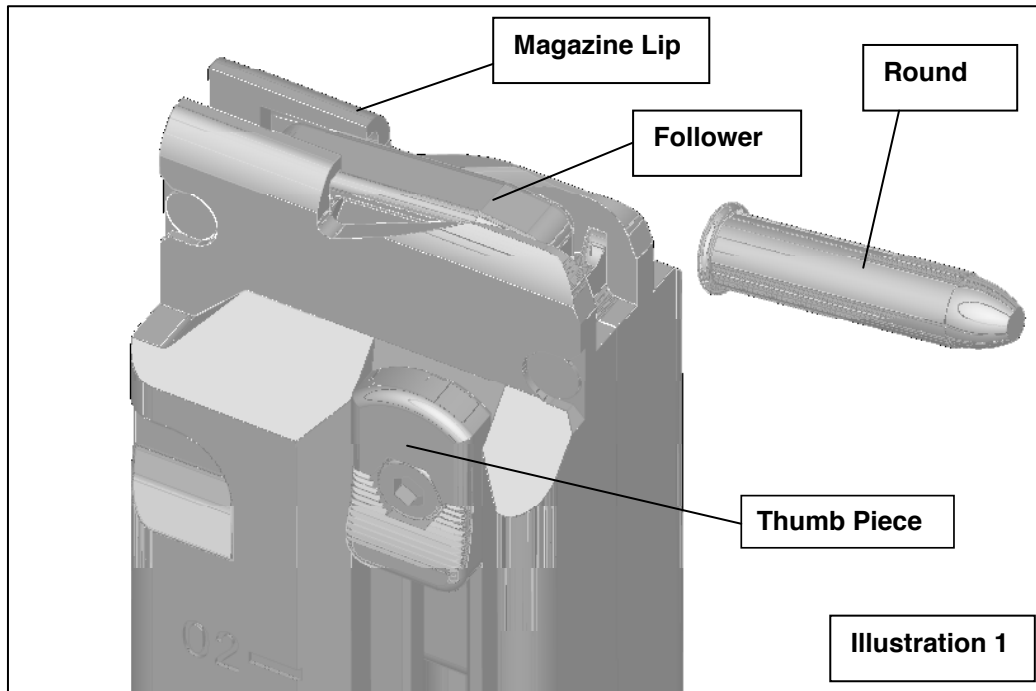

D-14: Loading the Gun (ready to fire):

Advices:

Never load the gun in a vehicle, a room or other small area.

(Except a shooting range).

Before loading always wipe off any surplus grease and oil and check to see if there are any foreign objects in the barrel.

Always keep the muzzle of the gun pointed in a safe direction.

Do not put your finger on the trigger. Keep your finger outside the trigger guard.

Load the gun by pushing in the magazine only directly before firing.

Pull the cocking lever to load the first bullet.

Never rely on the safety mechanisms alone. Safety mechanisms cannot substitute a careful and correct handling of the gun.

Never let a loaded gun out of your hand.

Procedure:

After the last round is fired, the breech bolt gets caught and the ejection port is open.

1. Point the gun in a safe direction.

2. Put the safety lever into position "S". (ill. 1, p. 11)

3. Remove the empty magazine and refill it with ammunition.

4. Insert full magazine.

5. Pull the cocking lever back until it stops and allow it to fly forward (ill. 2, p. 17)

6. The breech bolt will spring frontward and supply the first round of the new inserted magazine. The ejection port is now closed again (ill. 1, p. 12). Now the gun is loaded and ready for firing.

7. Put the safety lever back into position "F" to fire. (ill. 2, p. 11)

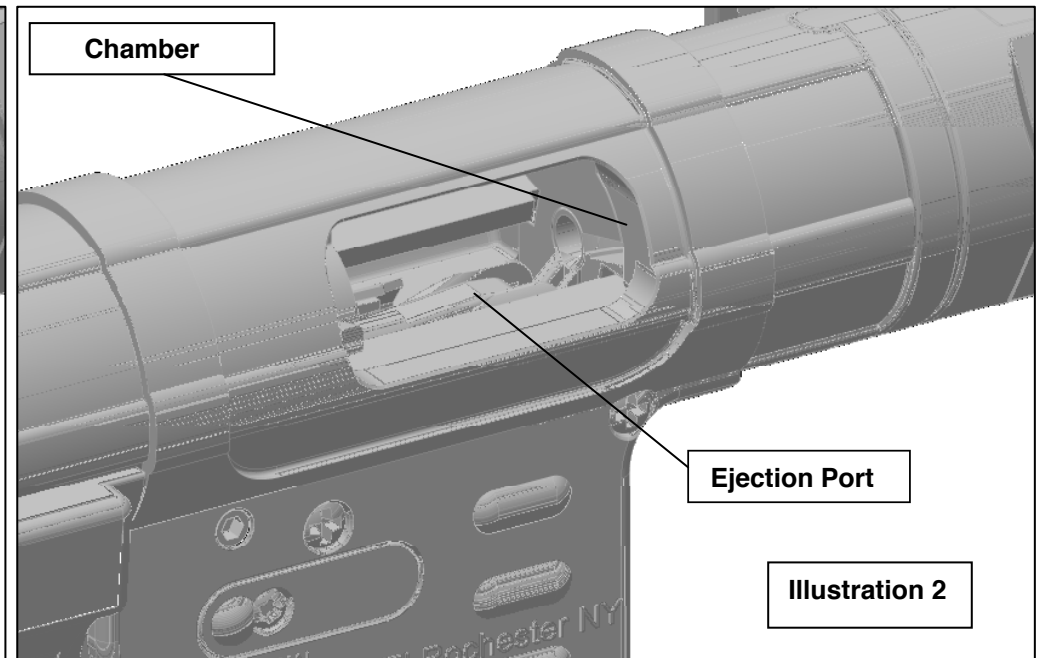
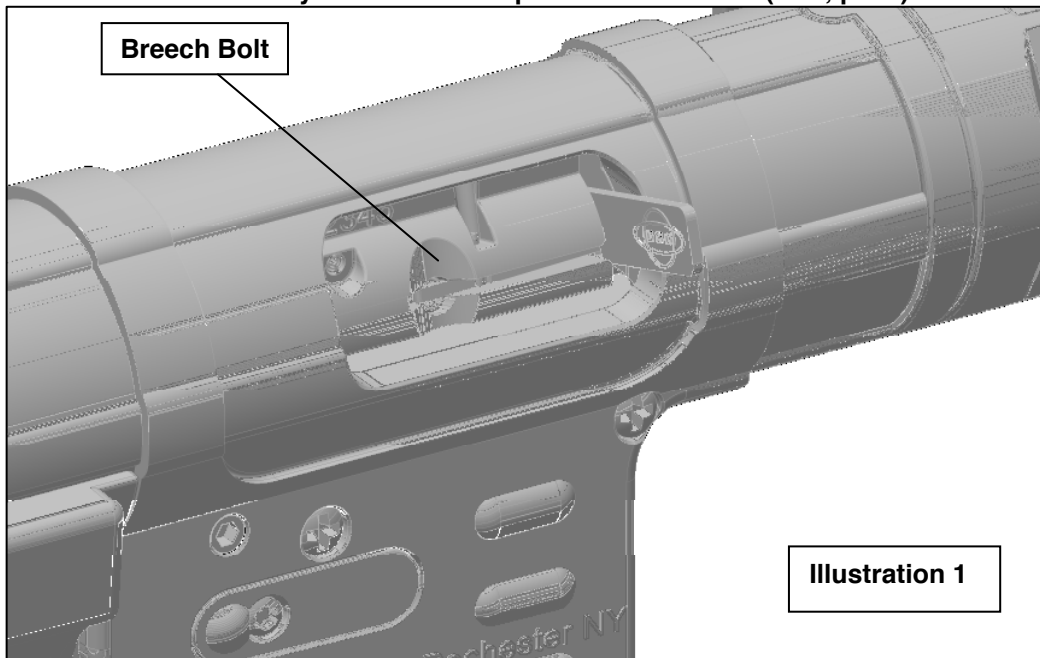

D-15: Firing:

- 1. Ensure that the target and surroundings allow shots to be fired without danger.**
- 2. Make sure, while shooting the gun, that your fingers, hands or other parts of your body are not in front of, above or beside the barrel muzzle or the ejection port.**
- 3. Never allow other persons to stand in a unsafe position where they could be hit by ejected cases.**
- 4. While shooting, always wear hearing protection and shooting glasses. Inform others near you about the need to wear this protective equipment.**
- 5. Interrupt shooting immediately and unload the gun if you suspect that a round is not inserted correctly, a case is jammed, a round may have blocked the barrel or when a shot sounds or feels weak or unusual. In order to do so, pull back the cocking lever and push it into the locked position. After doing so, put the safety lever into position "S". Now the ejection port is open and can be checked.**
- 6. If there is a blockage inside the barrel, never try to dislodge it by firing another round.**

D-16: Reloading during firing:

The breech bolt is held in the open position after the last shot.

Advice:

- Never let the gun out of your hand.
- Keep the gun directed toward a safe target.
- Remove the finger from the trigger.

Procedure:

1. Put the safety lever into position "S"
1. Remove the empty magazine.
2. The ejection port will stay open after firing, because it is caught by the bolt catch after the last shot. If this is not the case, pull the cocking lever all the way back, to make sure that the breech will be held back by the bolt catch (ill. 2, p. 17)
3. Now you can insert a full magazine.
4. Pull back the cocking lever and let it slide forward into battery. The breech bolt will pick up a new round and transport it into the chamber.
5. Put the safety lever back into position "F".
6. Now the gun is loaded and ready to fire.

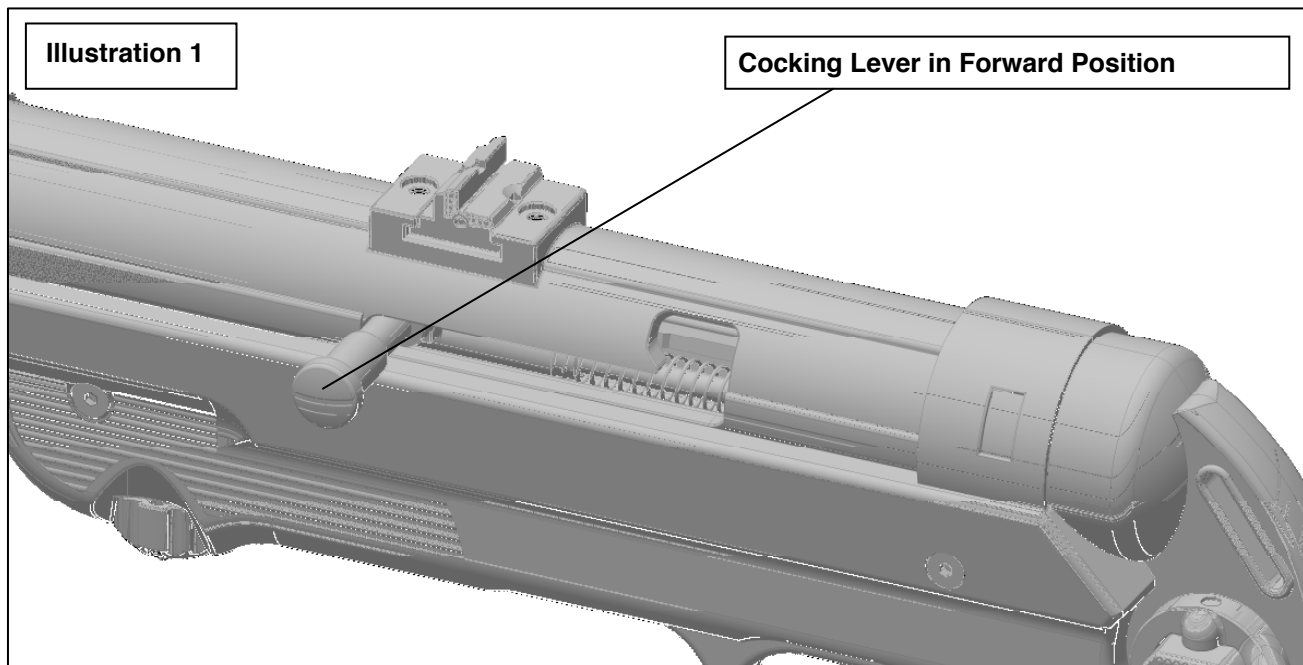

Illustration 2

Cocking Lever in most rearward position

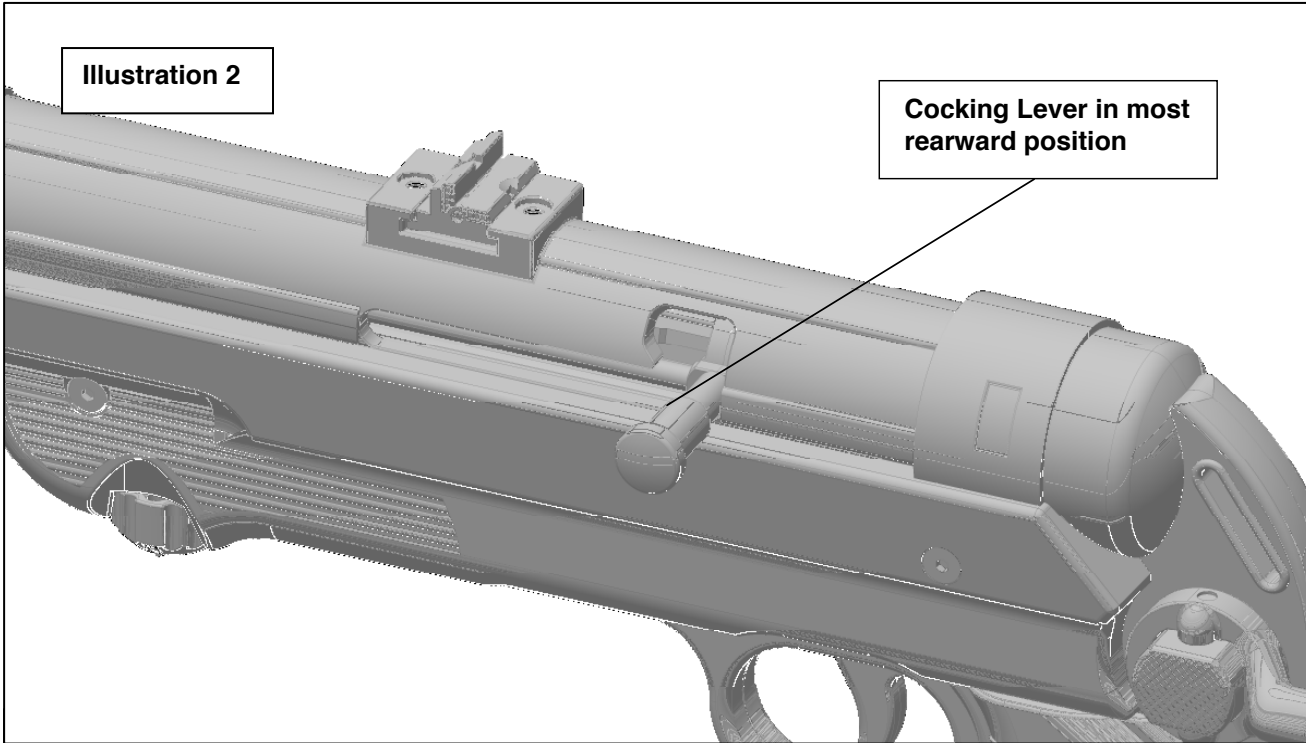
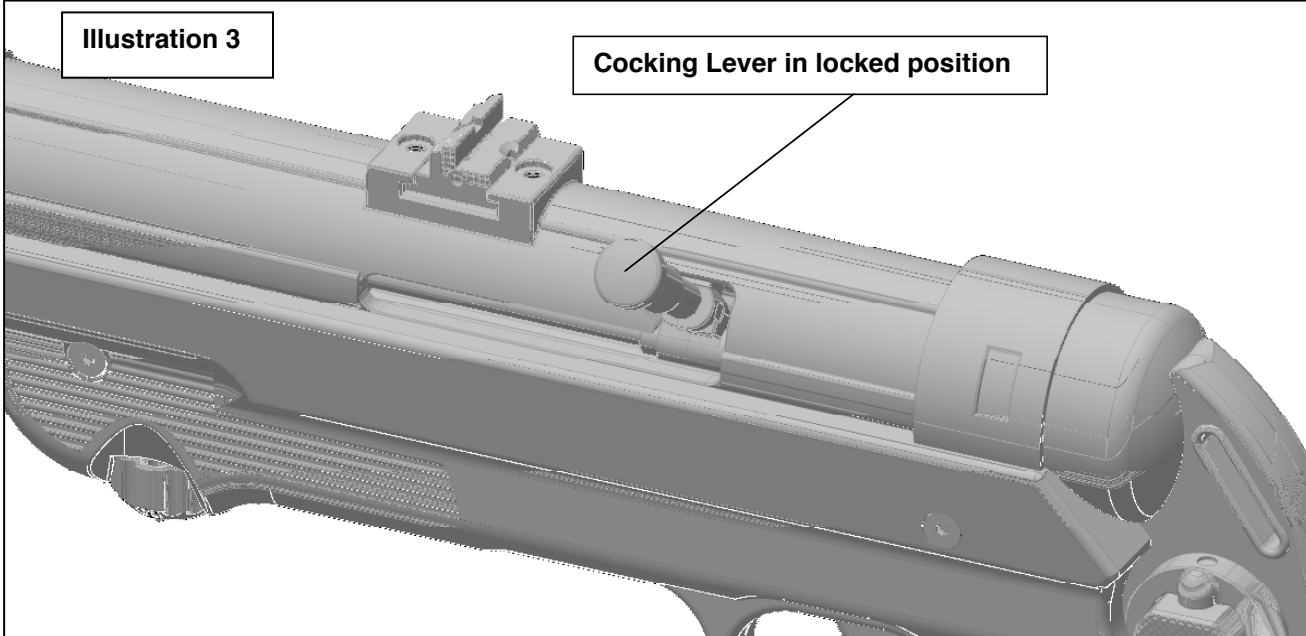

Illustration 3

Cocking Lever in locked position



D-17: Unloading the gun, Magazine not empty

Advice:

- _ Never let the gun out of your hands before it is unloaded.
- _ The gun is loaded, a round is in the chamber.

Procedure:

1. Press the Magazine release button, to remove the magazine. Store it safely. (ill. 1, p.18)
2. Keep the muzzle of the gun in a safety direction
3. Pull the cocking lever back into the safety notch (locked position). The round is ejected and the breech stays open.
5. Check (visually and manually with the help of the snap cap) that the round has been ejected and that there is no round left in the chamber (ill.1, p.19).
6. Empty the magazine.
7. Pick up ejected round and clean the gun.

Important: The gun is unloaded, but not decocked!

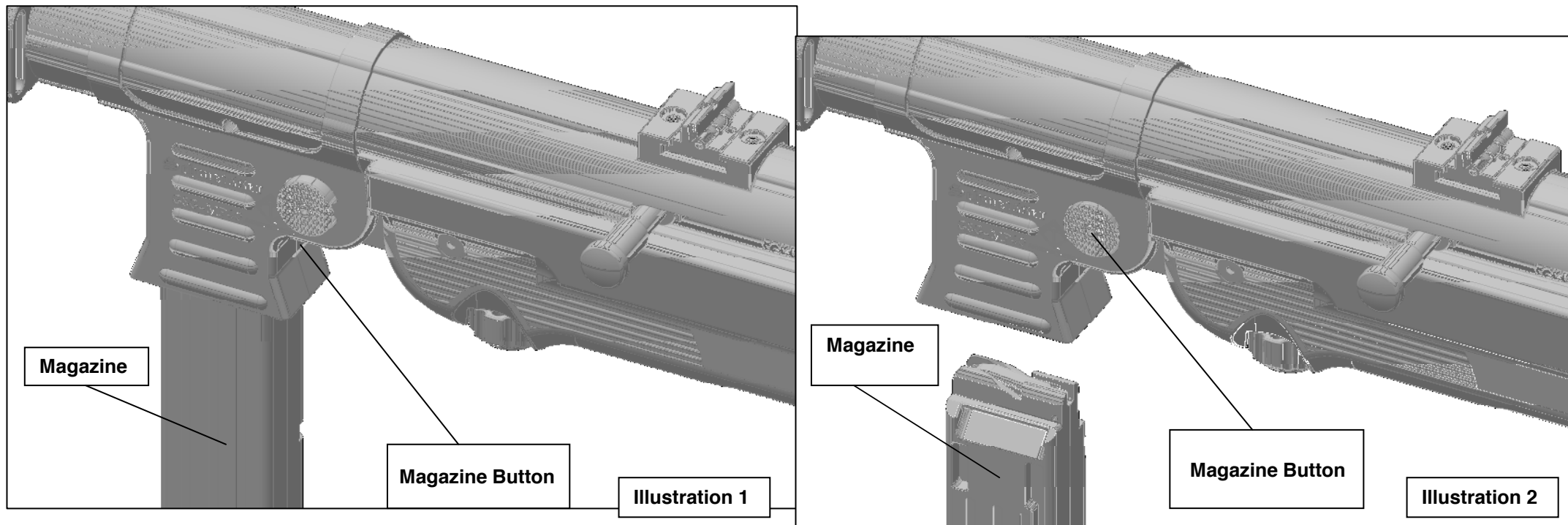

D-18: Unloading the gun, Magazine is empty

Advices:

- Do not let the gun out of your hand until the magazine has been removed and the gun is unloaded.

Procedure:

1. Keep the gun muzzle pointed in a safe direction.
2. Put the safety lever into position "S".
3. Press the magazine release button to remove the magazine.
4. The Ejection Port should be open after the last round was fired, the bolt catch will keep it in this position.
5. Check (visually and manually with the help of the snap cap), that no round is left in the chamber (ill. 1, p. 19)

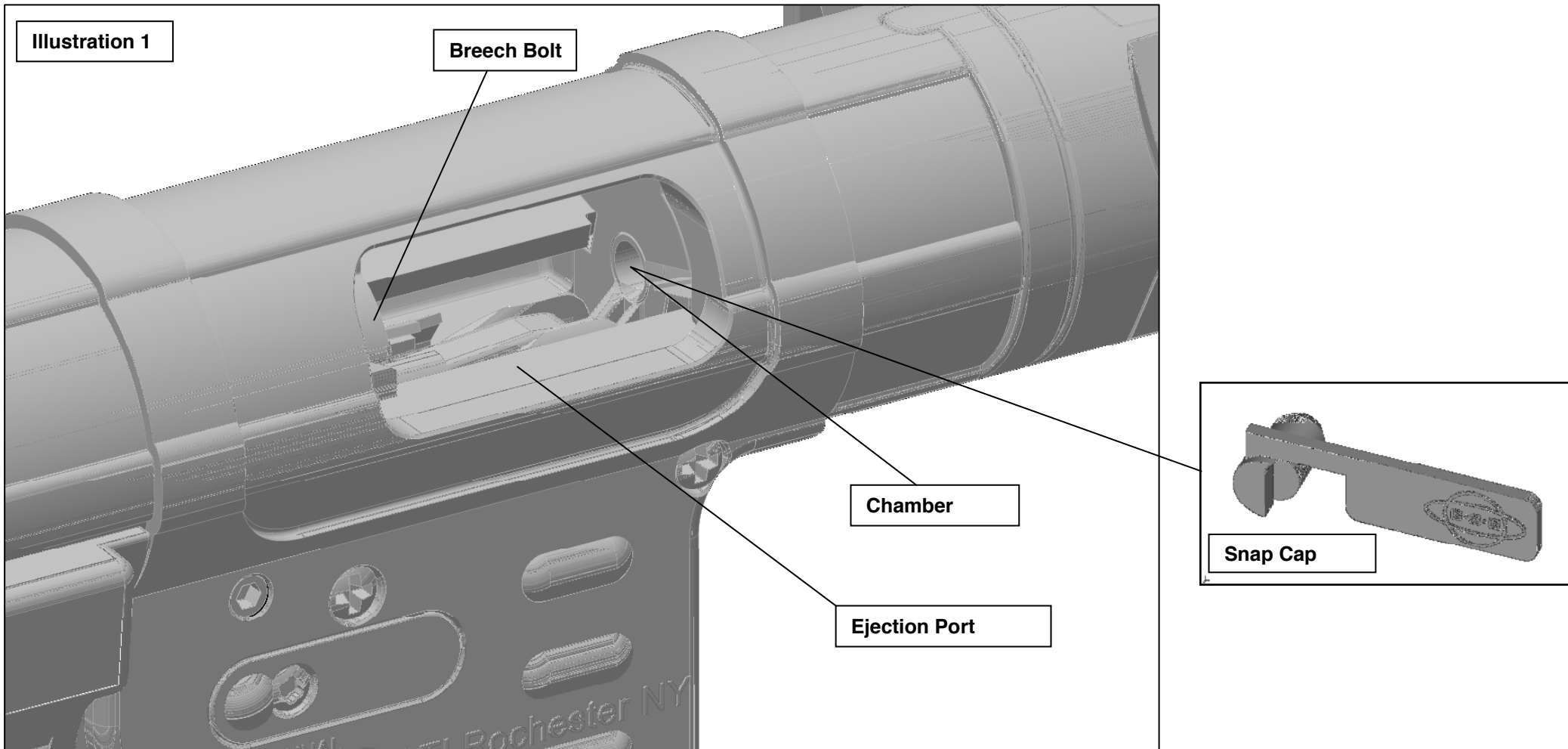

D-19: Decocking the rifle:

Procedure:

1. After you made sure that no round is left in the chamber, remove the empty magazine and put a snap cap in the chamber.
2. Put the safety lever into position "F".
3. Pull the cocking lever back and let it fly forward. The ejection port is now closed again.
4. Pull the trigger once, so that the hammer goes into its decocked position and the rifle is decocked. To be on the safe side, put the safety lever back into position "S".

Important: When you pull back the cocking lever after this procedure, the hammer goes back and the gun is cocked and ready for firing.

D-20: Setting the Sight:

Procedure:

1. The sight consists of a rigid rear sight and a foldable rear sight (ill. 1 and 2, p. 21)
If the rear sight is folded up, you will receive a higher shot while targeting (ill. 1, p. 21)
If the rear sight is folded down, you will receive a lower shot while targeting (ill. 2, p. 21)
2. With the attached Allen Key you can loosen the setscrew M3 and move the sight, right or left.
If you want to attach a mounting bar (accessories) you must first remove the sight (ill. 4, p. 21)

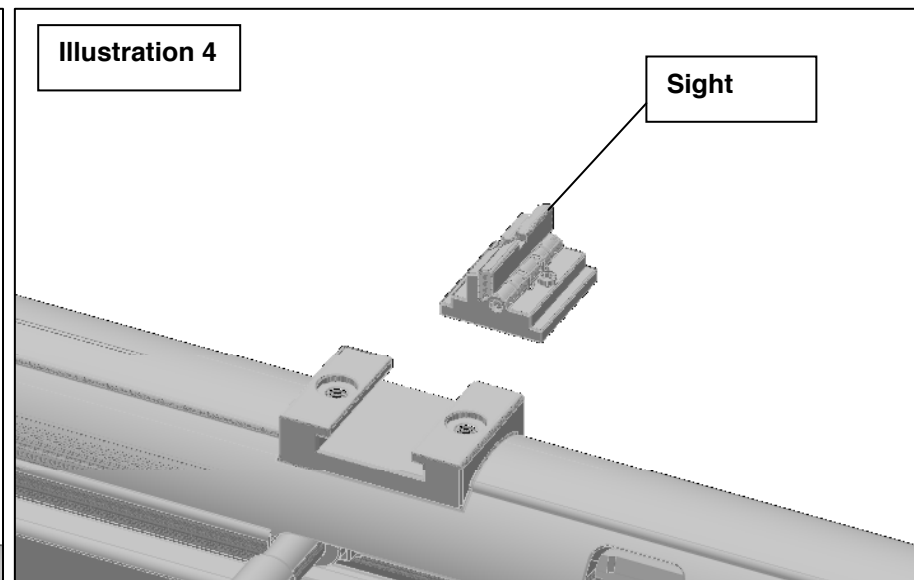
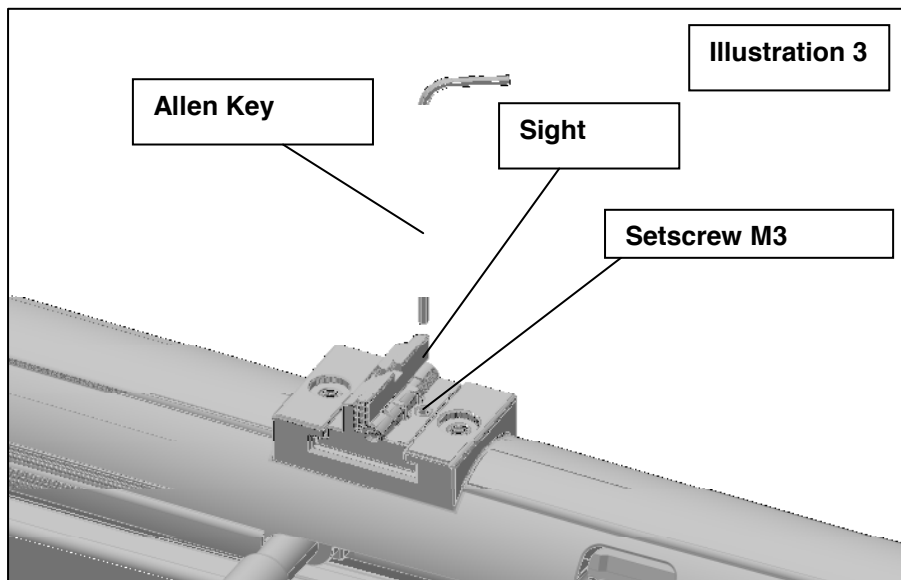
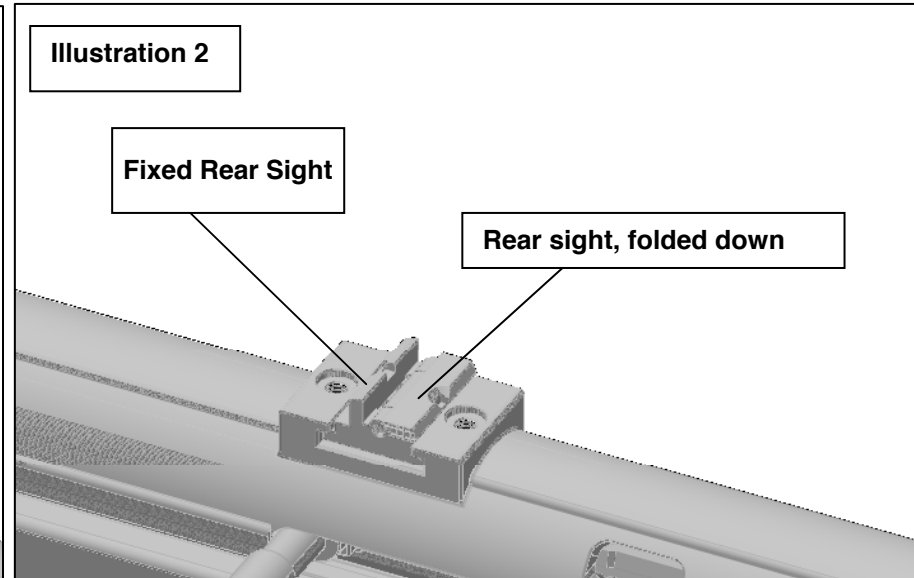
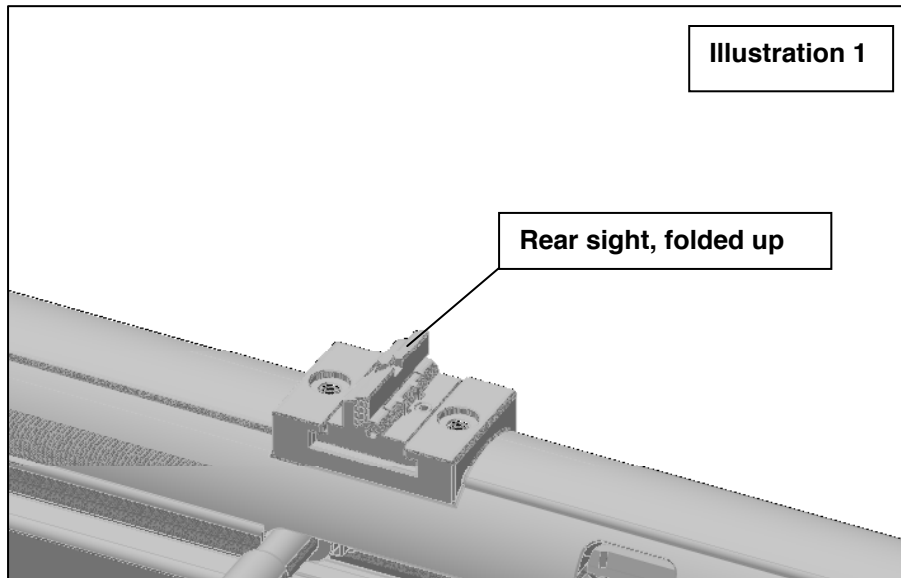

D-21: Exchange the front sights:

Advices:

4 additional, exchangeable front sights in different heights are enclosed.

Procedure:

1. Unscrew the barrel shroud counterclockwise and remove the front sight hood (ill. 1, p. 22)
2. Now you can push the present front sight out of the dove tail slot and can exchange it with a higher or lower front sight (ill. 2, p. 22)
3. In the next step, put the front sight hood back around the barrel and screw the barrel shroud on.

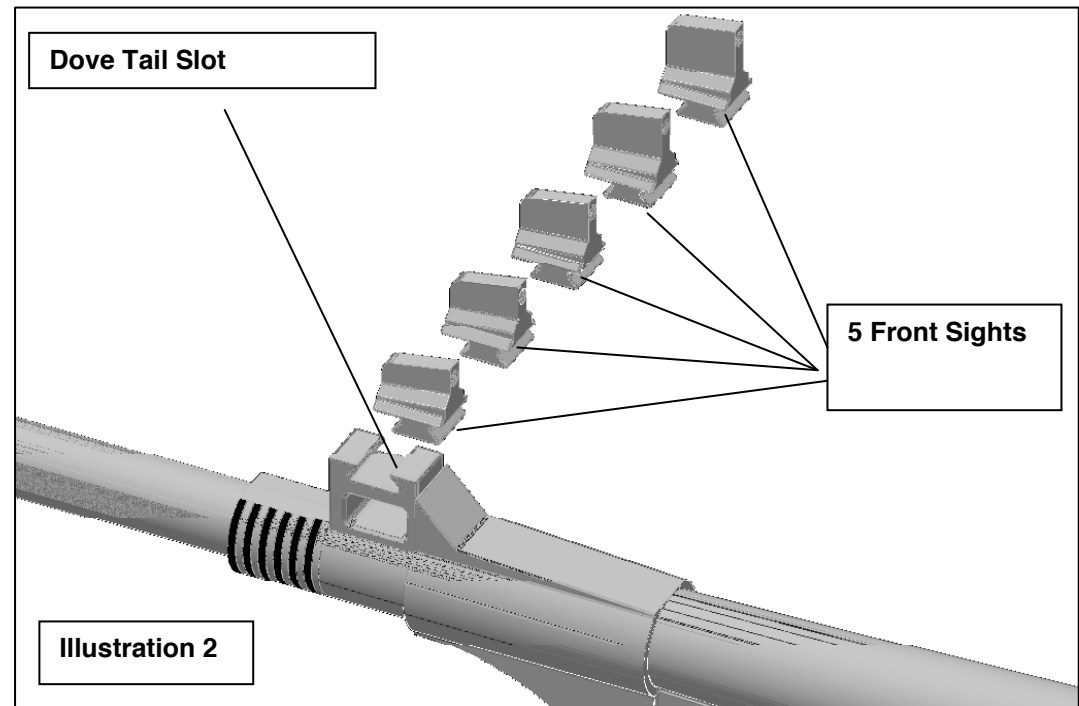
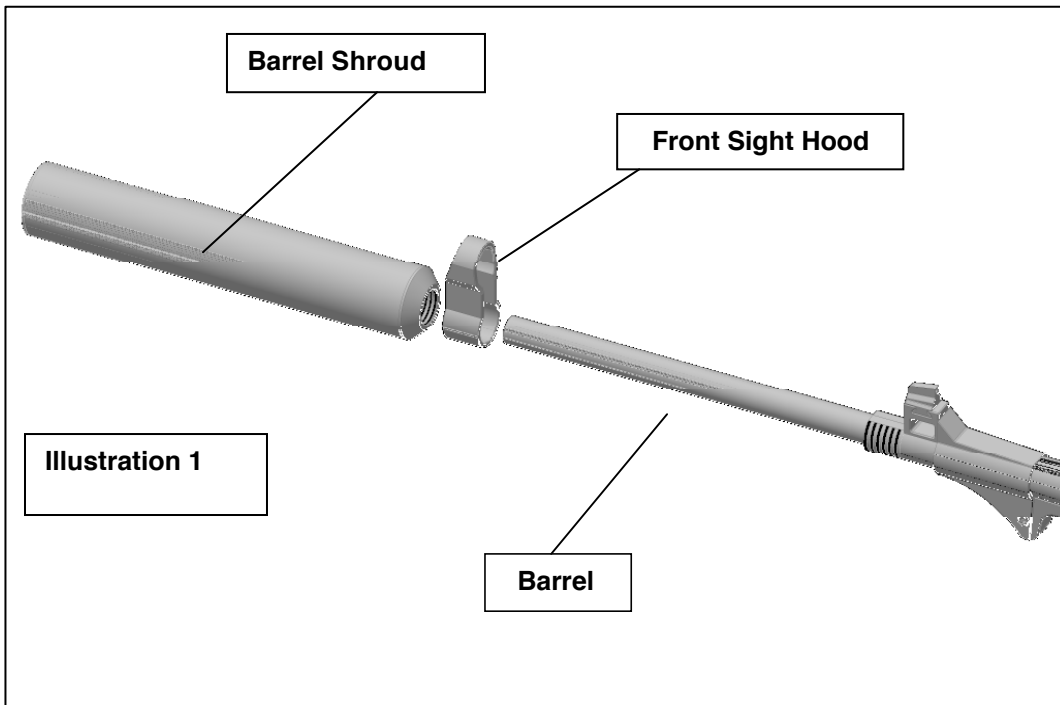

D-22: Maintenance :

D-23: Disassemble:

Advice:

- Before disassembling, remove the magazine.
- Check that the rifle is unloaded before you clean it.
- Check again, that no round is left in the chamber.

Procedure:

1. Unload the gun.
2. Loosen the setscrew M5 with the enclosed Allen Key and remove it. (ill. 1 and 2, p. 23)
3. Pull the grip first backwards then down (ill. 3, p. 24)
4. Remove Cocking Lever by unthreading it counterclockwise and remove the breech bolt carrier backwards (ill. 4, 5 and 6, p. 24)

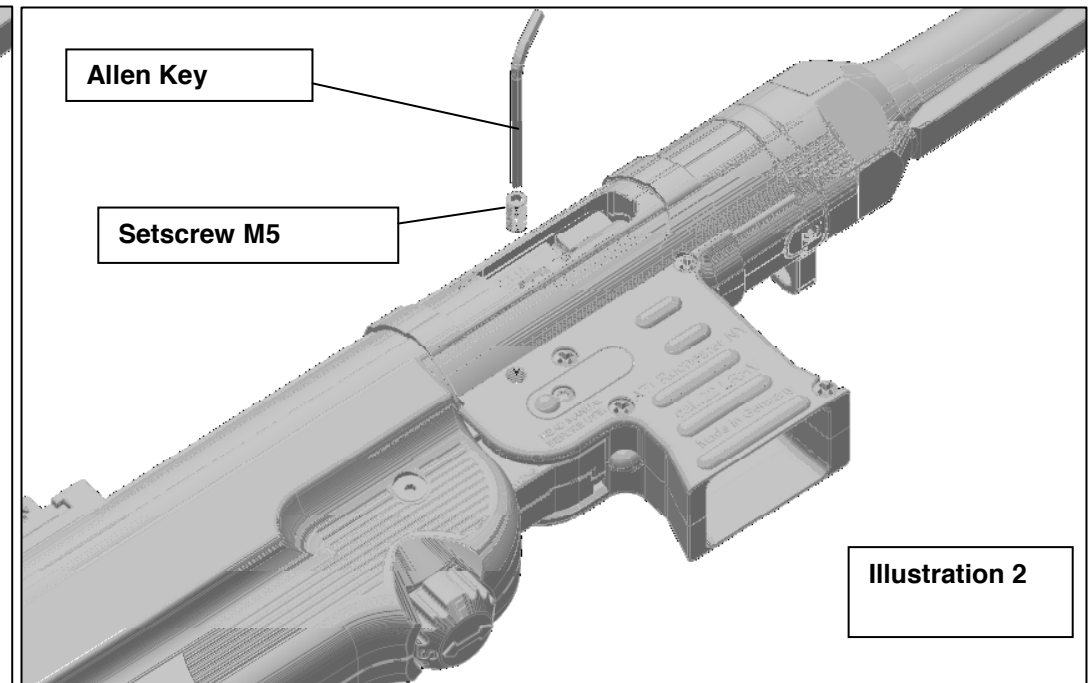
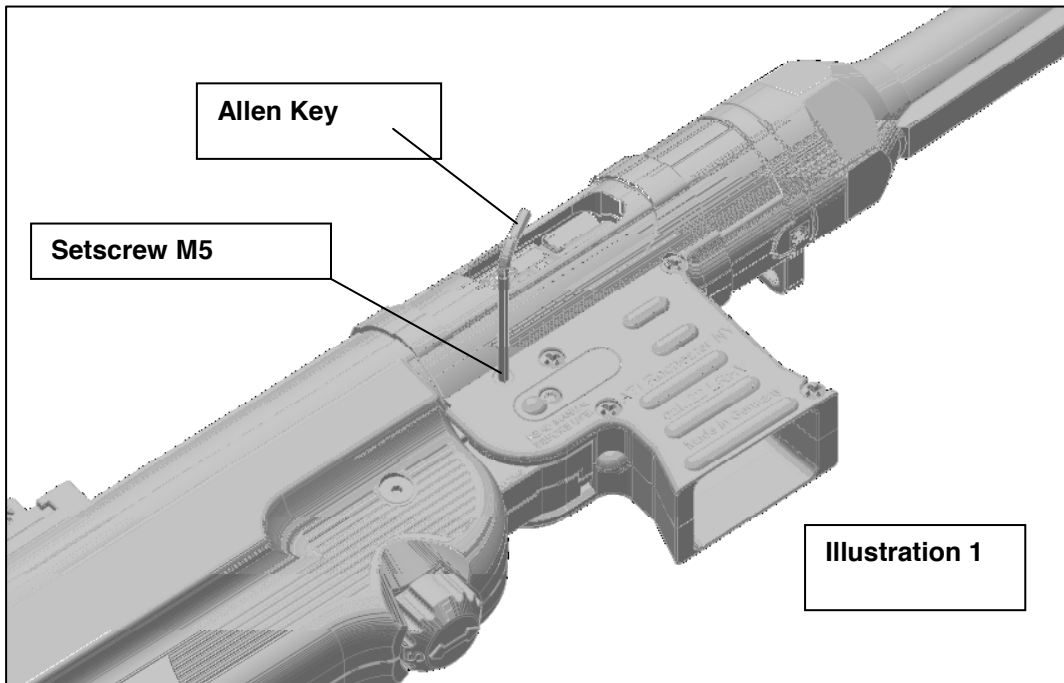

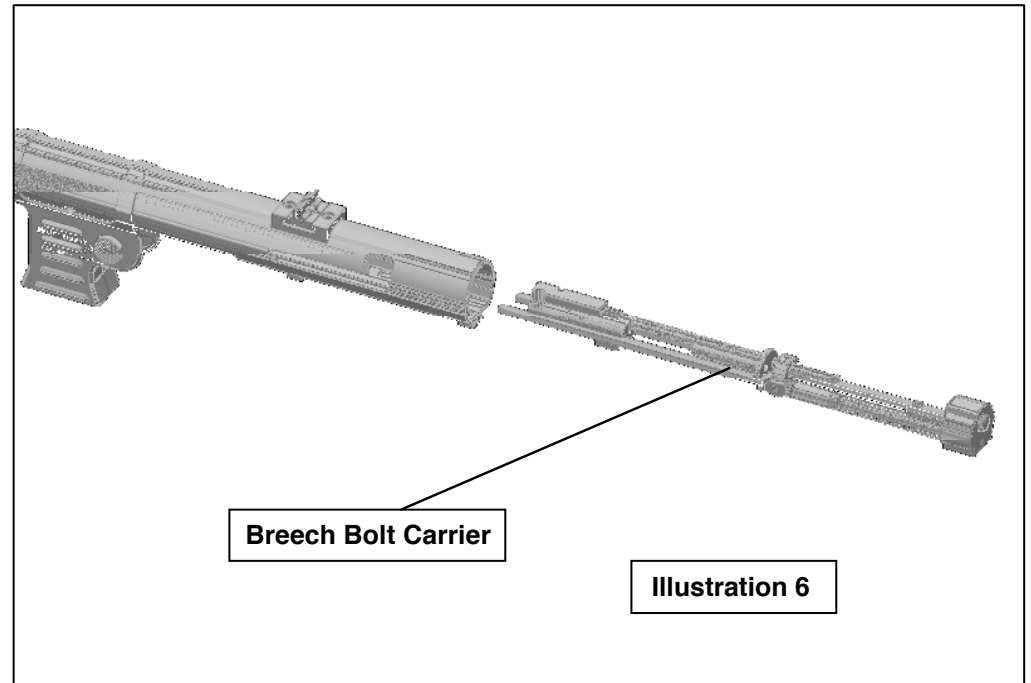
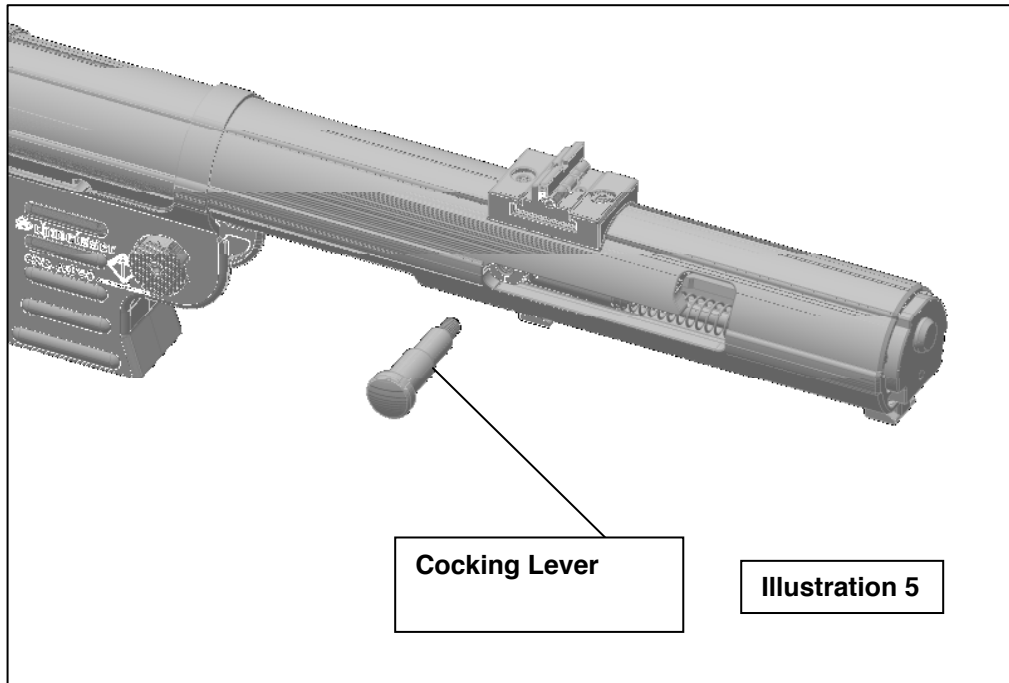
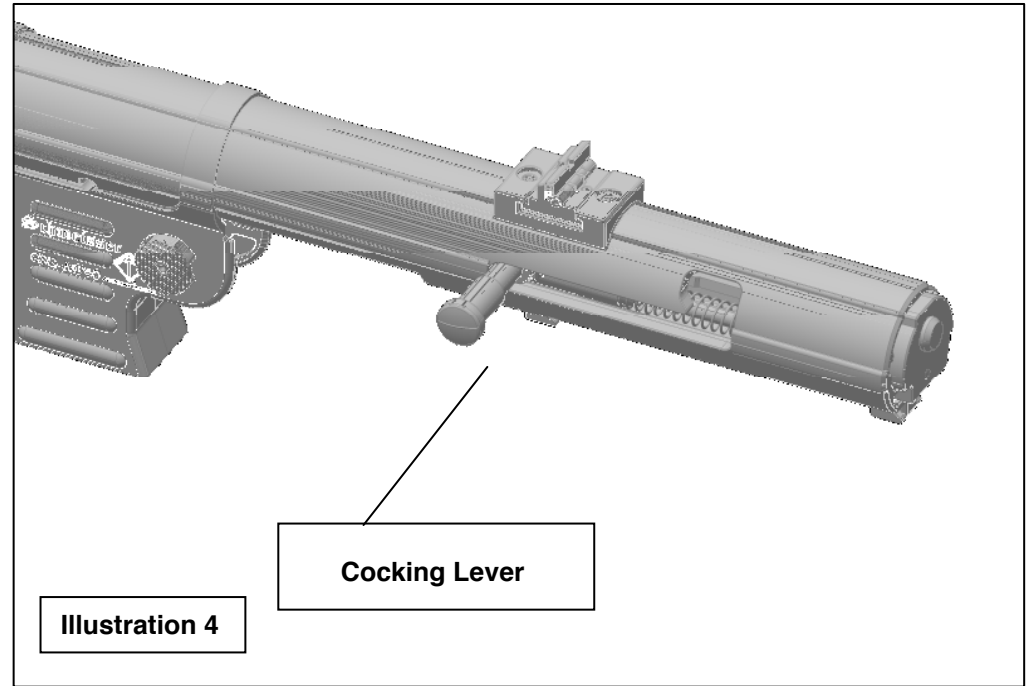
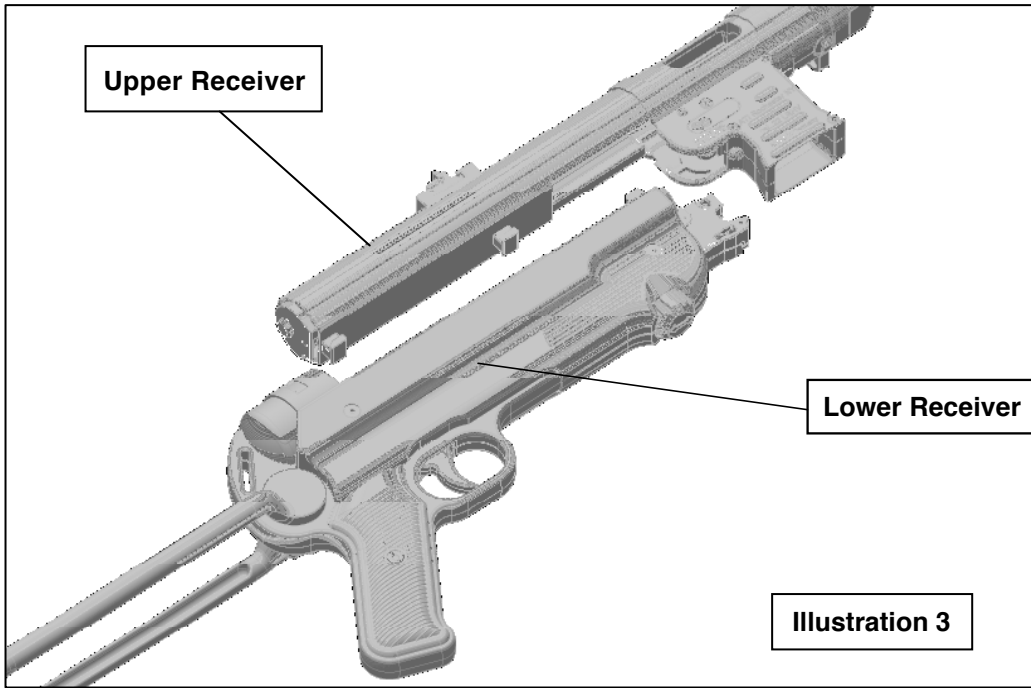

D-24: Cleaning the Breech System:

Advice:

The before shown disassembling is sufficient for cleaning.
A further disassembling of the rifle, must only be made by expert staff.
Do not use a steel brush or any other hard material to clean the barrel.
This could damage the flat surface of the barrel.
Use only a suitable cleaning rod and brushes of the right caliber.
Thinner or harsh chemicals could damage the surface of the rifle.

Procedure:

1. Use the brush to carefully remove all powder residues and dirt in the barrel and chamber.
2. Wipe powder residues and oil from the inside of the barrel bore and chamber with cleaning patches
3. Clean the Breech Guide and the Breech Bolt (ill. 1, p. 25)
4. Lightly oil bore of chamber.

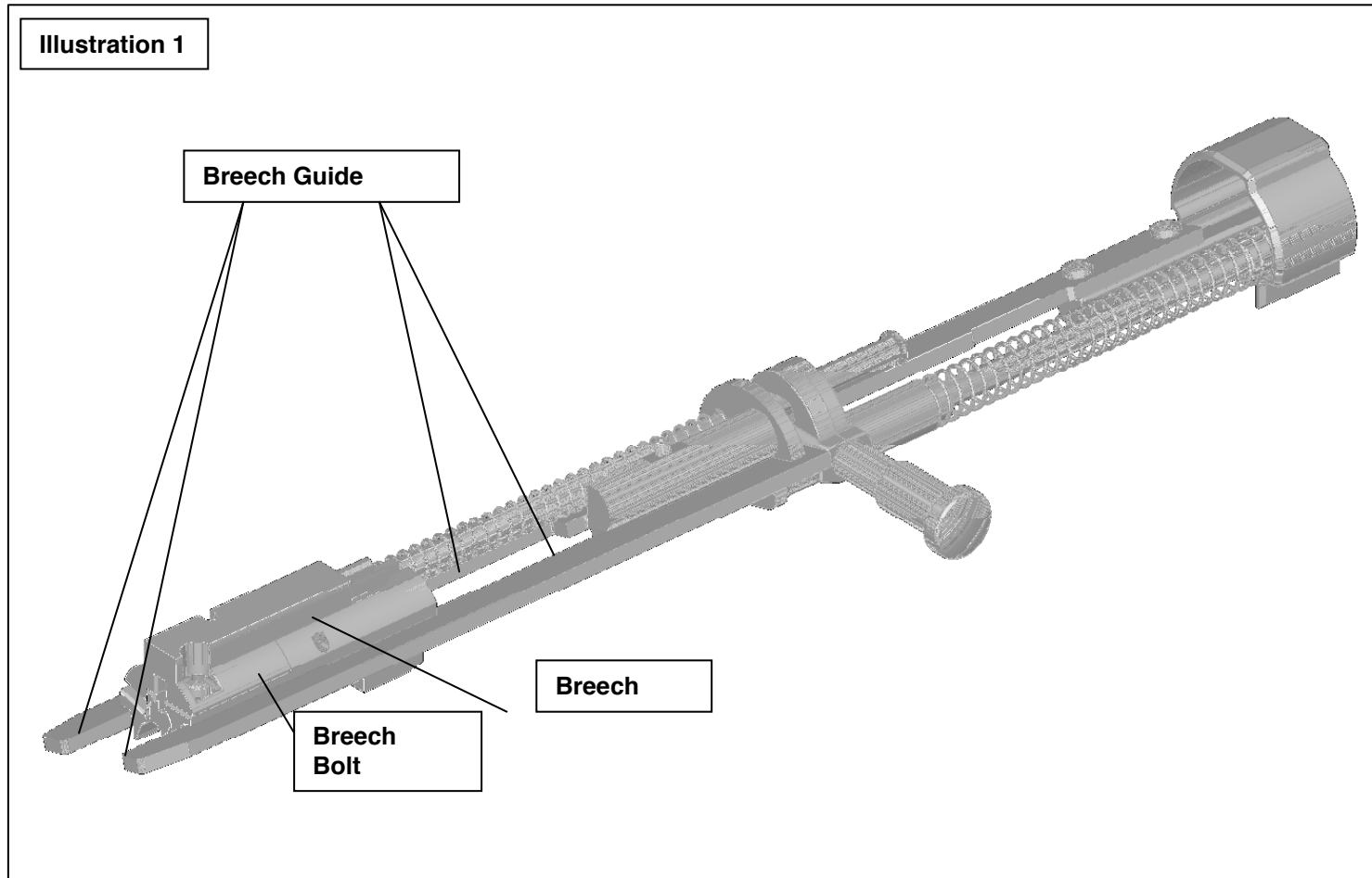

D-25: Fold up the Buttstock

Procedure:

1. Depress the buttstock release button (ill. 1, p. 26).
2. Fold the buttstock under the pistol grip toward the magazine well (ill. 2, p. 26)

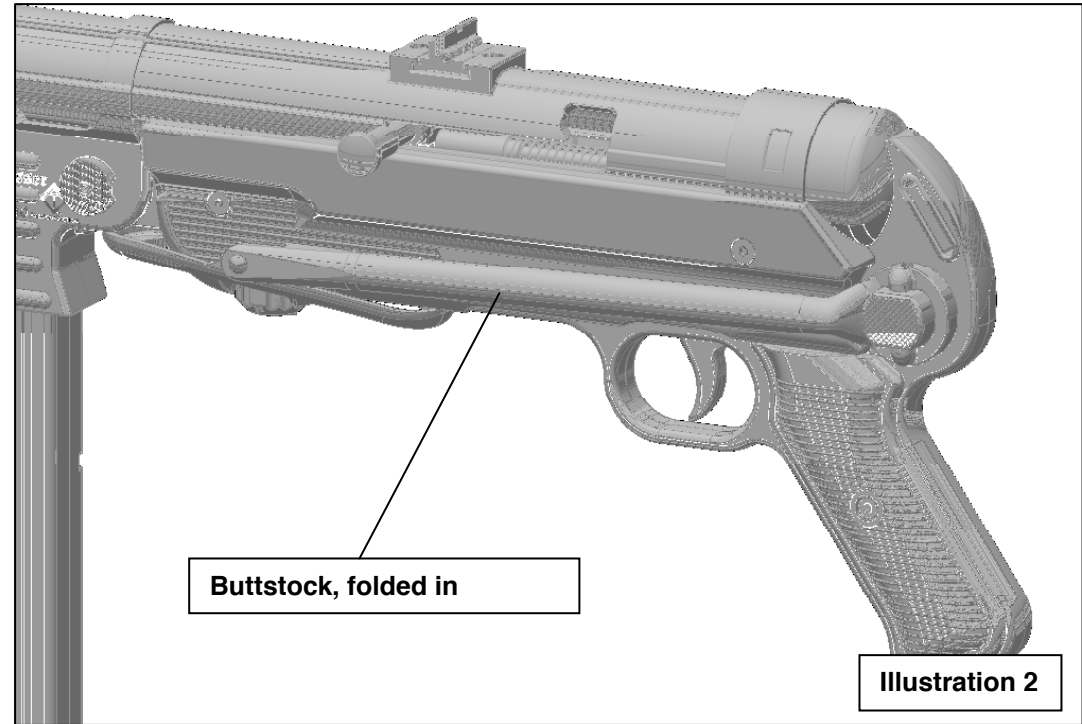
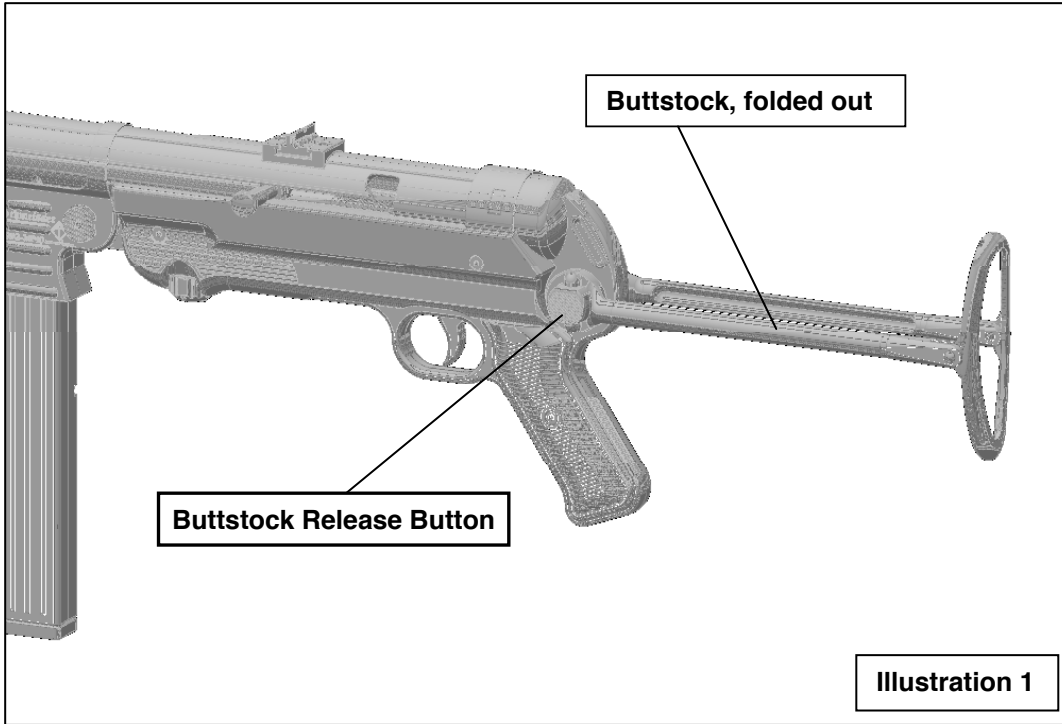

D-26: Adjust Trigger Pull Weight:

Advice:

The Trigger Pull of the GSG-MP40 can be adjusted with the enclosed Allen Key.

Procedure:

1. Disassemble the Gun.
2. In the front part of the lower receiver, right before the hammer, is a round cavity, in which you can find an allenhead setscrew (ill. 1, p. 27)
3. You can adjust the trigger pull by turning the setscrew with the help of the Allen key. (ill. 2, p. 27)
4. Turn setscrew clockwise to lighten pull and counter clockwise to stiffen pull.

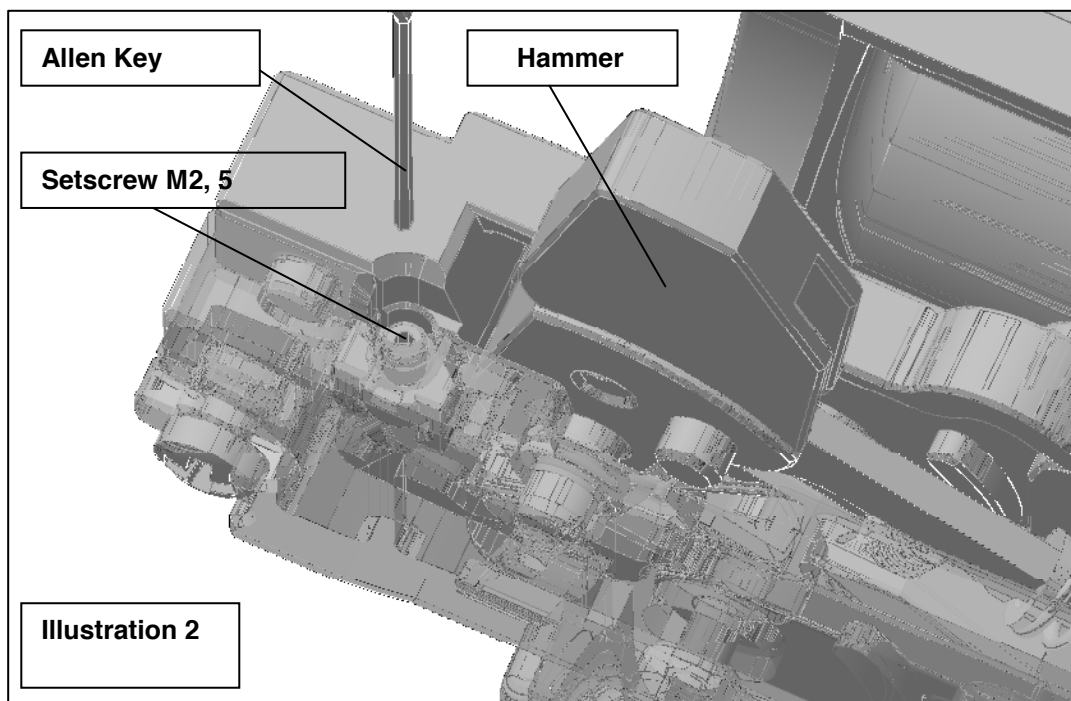
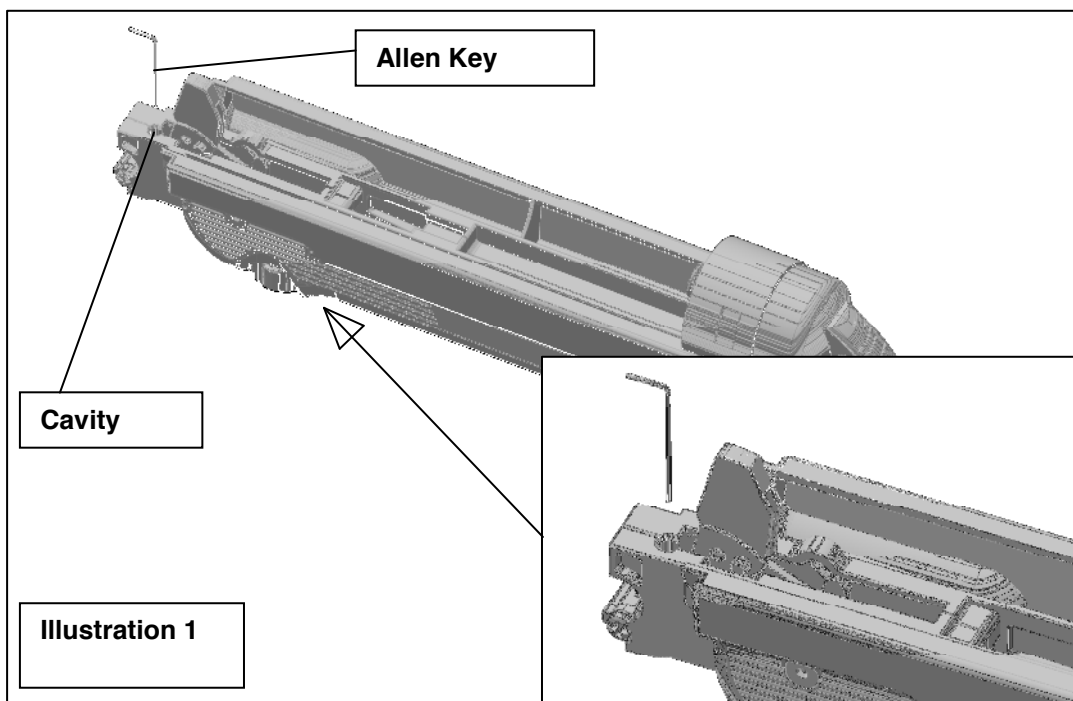

D-27: Care of the gun:

- Always keep the gun in immaculate condition and in good working order.
- Always clean and oil the gun after use.
- Never modify or repair parts of the gun by yourself
- Have your gun checked once every 12 months by a qualified gunsmith or armourer because defects, wear, corrosion, etc. are not always visible from the outside.
- If you order spare parts without returning the gun, you are responsible for ordering the correct part and its correct fitting by a qualified gunmaker or armourer.

D-28: Trouble shooting:

Gun maintenance (cleaning and inspection) according to the instructions can prevent malfunctions. Should, nevertheless, a malfunction occur during shooting, proceed as follows:



Advice:

Hold the gun pointed in the firing direction (safe direction) and keep your finger off trigger while you follow this list of operations:

Procedure:

1. Pull the cocking lever until the it stops, turn the cocking lever into the notch to hold the breech bolt back.
2. Put the safety lever into position "S".
2. Remove the magazine and store it safely.
3. Verify visually that there is no bullet, round, case or foreign object in the barrel bore or chamber.
4. If a projectile is locked in the bore, strip the rifle and have the blockage removed with a suitable tool by a qualified gunsmith.
5. Remove all rounds, cases or foreign subjects.
6. Clean, lubricate and assemble the rifle.
7. Have the gun inspected by a gunsmith.

D-606: Servicing

| Problem | Possible Cause of Problem | Possible Remedy or Solution |
|---|---|---|
| Not Feeding Ammunition | Magazine not properly inserted, deformed or dirty ammunition or magazine | Insert magazine properly or replace it. Replace ammunition |
| Breech Breech does not close correctly | Gun or round polluted or too heavily greased if gun is still defective  | Strip, clean and lubricate rifle Replace ammunition Repair by Manufacturer or Gunmaker |
| Case Ejection empty case stays in chamber or jams in case ejection port | Recoil insufficient because of fouling; Underloaded Ammunition if gun is still defective  | Strip, clean and lubricate rifle Replace Ammunition Repair by Manufacturer or Gunmaker |
| Misfire Hammer strikes, but no discharge | Fring Pin sticking in its guide Defective Ammunition if gun is still defective  | Strip, clean and lubricate rifle Have gun checked by gunmaker Manually load a new round Reparation by Gunmaker or Retailer |

D-30: Safekeeping and Storage of the Gun:

Advice:

- Always store your gun unloaded and in cleaned condition
- Store your gun separated from the ammunition and keep it locked in a gun safe that corresponds with the laws and regulations of your country.
- The gun and the ammunition are not allowed to be accessible to children or other unauthorized persons.

D-31: Shipping the gun:

Advice:

Familiarize yourself fully with regional laws and legislations governing shipping and transportation of firearms.

Procedure:

1. Check if the gun is unloaded and decocked.
2. Pack the gun well. If it is possible, use the original package, to prevent transport damage.
3. To prevent the gun being recognized as such during shipping, wrap the original packaging in a second outer layer
4. Do not put any accessories into the package.

Enclose a letter with the following data:

- Your name
 - Your address
 - Telephone number, under which you can be called during the day
 - A detailed explanation of the problems that occurred or the services that should be performed.
5. Send the gun properly insured and carriage-paid (packages without correct postage will not be accepted)
 6. Send the gun to:
 - The shop where you have bought your gun
 - The importer of your country. If your importer is American Tactical, please call 1-800-333-0695 for an RA#

D-32: Accessories:

01. Mounting Rail (Picatinny Design)
02. Sling
03. Magazine
04. Magazine Bag (Pouch)
05. Scope / Ring and Bead Sight
06. Drum Magazine

D-33: Disposal

- Strictly observe any current national legislation governing the disposal of firearms
- Provided this is not contrary to current national legislation, we recommend shipping the gun to one of the addresses listed under section “Shipping the gun to the manufacturer” for disposal.
- When shipping the gun, strictly observe the instructions listed under Sect. “Shipping the Gun”

D-34: Spare-Parts List ((you will find this list via www.gsg-mp40.de)

- Necessary information for ordering spare parts:
- Gun Model (Caliber, Designation)
- Gun serial Number