



Savage[®] Arms

The Definition of Accuracy

Safe ownership is your responsibility. Please thoroughly read and understand this manual before loading your firearm.

Keep firearms and ammunition away from children. Lock unloaded firearms and ammunition securely in separate locations.

This manual should always accompany your firearm and be transferred with it upon change of ownership. This is your responsibility and may protect you from future liability.

100 Springdale Road
Westfield, MA 01085

INSTRUCTION MANUAL

Model 42 Combination Rifle/Shotgun

IMPORTANT! DO NOT ATTEMPT TO LOAD AND SHOOT YOUR RIFLE UNTIL YOU HAVE THOROUGHLY READ THIS INSTRUCTION MANUAL AND ARE FULLY FAMILIAR WITH ITS CONTENTS

For more information, please visit our web site at www.savagearms.com

Download a QR Code reader app for your smart phone and
then snap this to go to the online registration page!



WWW.SAVAGEARMS.COM

Model 42 COMBINATION RIFLE/SHOTGUN

Congratulations on the purchase of your new firearm. You are now part of the Savage Sports Corporation family of quality firearms and archery equipment/accessories, which includes Savage Arms, Inc., Savage Arms (Canada), Stevens, Fox, and BowTech. With reasonable care, your firearm should deliver years of reliable service and perform to our “definition of accuracy”.

THIS MANUAL IS EXTREMELY IMPORTANT.

The safety warnings and instructions in this manual are very important. By understanding the dangers involved in the use of any firearm and by taking the necessary precautions, you can use your Savage firearm in complete safety. However, failure to read, understand, and obey any of the warnings may result in serious injury or death to you or others, as well as severe damage to the firearm or other property.

This manual should always accompany your firearm and be transferred with it upon change of ownership. This is your responsibility and may protect you from future liability.

*FOR MORE INFORMATION, PLEASE VISIT OUR WEB SITE AT: **WWW.SAVAGEARMS.COM***

SECTION 1: SAFETY FIRST – IT’S YOUR RESPONSIBILITY!	p.2
SECTION 2: TWO POSITION SAFETY	p.4
SECTION 3: LOADING / FIRING / UNLOADING / ADJUSTING THE REAR SIGHT.	p.5
SECTION 4: PARTS LIST AND DIAGRAM	p.9
SECTION 5: AMMUNITION BULLET WEIGHTS	p.11
SECTION 6: MOUNTING A SCOPE	p.12
SECTION 7: MAINTENANCE.	p.12
- Routine maintenance	
- Cleaning	
SECTION 8: STATEMENT OF LIMITED WARRANTY	p.14

Although considerable time and effort were put into assuring the accuracy of the information contained herein, human errors do occur. If an error is found, please let us know. As a ‘customer driven’ company, we appreciate and encourage feedback.

SECTION 1 - SAFETY FIRST – IT’S YOUR RESPONSIBILITY!

Above all – remember that a firearm is a mechanical device. It can not think, it can not act on its own – it only does what YOU MAKE IT DO. A mechanical device has no way to know if your actions are safe or if they will result in injury or death – THAT’S YOUR PART! It only takes one careless second to result in a tragedy that you will have to live with the rest of your life. MAKE NO DOUBT ABOUT IT, owning and/or using a firearm puts YOU in full control of its actions and THEIR CONSEQUENCES!

10 COMMANDMENTS OF SHOOTING SAFETY

*FOR MORE INFORMATION, PLEASE VISIT OUR WEB SITE AT: **WWW.SAVAGEARMS.COM***

(The following excerpts are from SAAMI bulletin #081. The entire booklet can be obtained by calling: NATIONAL SHOOTING SPORTS FOUNDATION, 11 MILE HILL ROAD, NEWTOWN, CT 06470)

FIREARMS SAFETY DEPENDS ON YOU!
FROM THE TIME YOU PICK UP A FIREARM, YOU BECOME PART OF A SYSTEM OVER WHICH YOU HAVE COMPLETE CONTROL. YOU ARE THE ONLY PART OF THE SYSTEM THAT CAN MAKE A GUN SAFE – OR UNSAFE.

You can help meet this responsibility by enrolling in hunter safety or shooter safety courses, if you have not already done so. You must constantly stress safety when handling firearms, especially

to children and non-shooters. Develop safe shooting habits and remember, firearms safety is up to you. Make no mistake about it.

ALCOHOL, DRUGS AND GUNS DON'T MIX

1. ALWAYS KEEP THE MUZZLE POINTED IN A SAFE DIRECTION

This is the most basic safety rule. If everyone handled a firearm so carefully that the muzzle never pointed at something they didn't intend to shoot, there would be virtually no firearm accidents. It's as simple as that, and it's up to you.

Never point your gun at anything you do not intend to shoot. A safe direction means a direction in which a bullet cannot possibly strike anyone, taking into account possible ricochets and the fact that bullets can penetrate walls and ceilings. Even when "dry firing" with an unloaded gun, you should never point the gun at an unintended target.

This is your responsibility, and only you can control it.

2. FIREARMS SHOULD BE UNLOADED WHEN NOT ACTUALLY IN USE

Firearms should be loaded only when you are in the field or on the target range or shooting area, ready to shoot. When not in use, firearms and ammunition should be secured in a safe place, separate from each other. It is your responsibility to prevent children and inexperienced adults from gaining access to firearms or ammunition. A loaded gun has no place in or near a vehicle or building.

Whenever you handle a firearm or hand it to someone, always open the action immediately, and visually check the chamber, receiver and magazine to be certain they do not contain any ammunition. Never assume a gun is unloaded – check for yourself! While in the field, there will be times when common sense and the basic rules of firearms safety will require you to unload your gun for maximum safety. When in doubt, unload your gun!

3. DON'T RELY ON YOUR GUN'S "SAFETY"

Treat every gun as though it can fire at any time, regardless of pressure on the trigger. The "safety" on any gun is a mechanical device, which, like any such device, can become inoperable at the worst possible time. The safety serves as a supplement to proper gun handling but cannot possibly serve as a substitute for common sense.

Never touch the trigger on a firearm until you actually intend to shoot.

Your firearm is a precision instrument. Regardless of the position of the safety, any bump strong enough to actuate the firing mechanism of a gun can cause it to fire. The only time you can be absolutely certain that a gun cannot fire is when the action is open and it is completely empty. You and the safe gun handling procedures you have learned are your gun's primary safeties.

4. BE SURE OF YOUR TARGET AND WHAT'S BEYOND IT

No one can call a bullet back. Don't shoot unless you know exactly what your bullet is going to strike. Be sure that your bullet will not injure anyone or anything beyond your target. You should keep in mind how far a bullet will travel if it misses your intended target or ricochets in another direction.

Be aware that even a .22 short bullet can travel over 1¼ miles and a high velocity shell, such as a 30-06, can project a bullet more than 3 miles. Shotgun pellets can travel 500 yards, and shotgun slugs have a range of over a half-mile.

5. USE CORRECT AMMUNITION

You must assume the serious responsibility of using only the correct ammunition for your firearm. Read and heed all warnings, including those that appear in the gun's instruction manual and on the ammunition boxes. Using improper or incorrect ammunition can destroy a gun and cause serious personal injury. It only takes one shell of improper caliber or gauge to wreck your gun, and only a second to check each one as you load it. Be absolutely certain that the ammunition you are using matches the specifications that are contained within the gun's instruction manual and the manufacturer's markings on the firearm barrel.

Hand loaded or reloaded ammunition deviating from pressures generated by factory loads or from competent recommendations specified in reputable hand loading manuals can be dangerous,

and can cause severe damage to guns and serious injury to the shooter.

Ammunition that has become very wet or has been submerged in water should be discarded in a safe manner. Do not spray oil or solvents on ammunition or place ammunition in excessively lubricated firearms.

Form the habit of examining every shell you put in your gun. Never use damaged, old or questionable ammunition – the money you save is not worth the risk of possible injury or a ruined gun.

DISCHARGING FIREARMS IN POORLY VENTILATED AREAS, CLEANING FIREARMS OR HANDLING AMMUNITION MAY RESULT IN EXPOSURE TO LEAD AND OTHER SUBSTANCES KNOWN TO CAUSE BIRTH DEFECTS, REPRODUCTIVE HARM AND OTHER SERIOUS PHYSICAL INJURY. HAVE ADEQUATE VENTILATION AT ALL TIMES. WASH HANDS THOROUGHLY AFTER EXPOSURE.

6. IF YOUR GUN FAILS TO FIRE WHEN THE TRIGGER IS PULLED, HANDLE WITH CARE!

Occasionally, a loaded gun may not fire when the trigger is pulled. If this occurs, keep the muzzle pointed in a safe direction. Keep your face away from the breech. Then, carefully open the action, unload the firearm and dispose of the shell in a safe way.

Any time there is a shell in the chamber, your gun is loaded and ready to fire - even if you've

tried to shoot and it did not go off. It could go off at any time, so you must always remember **RULE #1** and **WATCH THAT MUZZLE!**

7. ALWAYS WEAR EYE AND EAR PROTECTION WHEN SHOOTING

All shooters should wear protective shooting glasses and some form of hearing protectors while shooting. Exposure to shooting noise can damage hearing, and adequate vision protection is essential. Wearing eye protection when disassembling and cleaning any gun will also help prevent the possibility of springs, spring tensioned parts, solvents or other agents from contacting your eyes. No target shooter, plinker or hunter should ever be without them.

8. BE SURE THE BARREL IS CLEAR OF OBSTRUCTIONS BEFORE SHOOTING

Before you load your firearm, open the action and be certain that there is no shell in the chamber. Then glance through the barrel to be sure it is clear of any obstruction. Even a small bit of mud, snow, excess lubricating oil or grease in the bore can cause dangerously increased pressure, causing the barrel to bulge or even burst when firing, which can cause injury to the shooter and bystanders. Make it a habit to clean the bore with a cleaning rod and patch to wipe away anti-rust compounds in the gun each time immediately before you shoot it. If the noise or recoil on firing seems weak or doesn't seem quite "right", cease firing immediately and be sure to check that no obstruction or projectile has become lodged in the barrel.

9. DON'T ALTER OR MODIFY YOUR GUN, AND HAVE GUNS SERVICED REGULARLY

Firearms are complicated mechanisms, which are designed by experts to function properly in their original condition. Any alteration or change (other than adjusting the AccuTrigger™) made to a firearm after manufacture can make the gun dangerous and will usually void any factory warranties. Do not jeopardize your safety or the safety of others by altering the trigger, safety or other mechanism of any firearm or allowing unqualified person's to repair or modify a gun.

Your gun is a mechanical device, which will not last forever and is subject to wear. As such, it requires periodic inspection, adjustment and service.

10. LEARN THE MECHANISM AND HANDLING CHARACTERISTICS OF THE FIREARM YOU ARE USING

Not all firearms are the same. Consequently, never handle any firearm without first having thoroughly familiarized yourself with the particular type of firearm you are using, the safe gun handling rules for loading, unloading, carrying and handling that firearm, and the rules of safe gun handling in general. Locate the firearm's mechanical safety device and get familiar with the feel and "on/off" positions.

You should always read and refer to the instruction manual you received with your gun, or if you have misplaced the manual, simply contact the manufacturer for a free copy.

Having a gun in your possession is a full-time job. You cannot guess; you cannot forget. You must know how to use, handle, and store your firearm safely. Do not use any firearm without having a complete understanding of its particular characteristics and safe use. There is no such thing as a foolproof gun.

SECTION 2 – TWO POSITION SAFETY

PRIOR TO LOADING OR OPERATING, FAMILIARIZE YOURSELF THOROUGHLY WITH THESE OPERATING INSTRUCTIONS AND THE MAIN PARTS OF YOUR FIREARM.

YOUR GUN IS A MECHANICAL DEVICE WHICH WILL NOT LAST FOREVER AND IS SUBJECT TO WEAR. WHEN SOMETHING DOES NOT SOUND, FEEL, OR LOOK RIGHT, SEEK THE ADVICE OF A PROFESSIONAL GUNSMITH IMMEDIATELY. NEVER TAKE A CHANCE.

FAILURE TO OBEY A SAFETY WARNING MAY RESULT IN INJURY TO YOU OR OTHERS.

KNOW HOW TO LOCATE AND OPERATE THE SAFETY MECHANISM.

THOROUGHLY CLEAN THE INSIDE OF THE BARRELS AND CHAMBERS PRIOR TO LOADING WITH AMMUNITION.

THE USE OF RELOADS, HANDLOADS, MILITARY SURPLUS, OR ANY OTHER COMMERCIAL/ NONCOMMERCIAL AMMUNITION NOT MANUFACTURED TO SAAMI (SPORTING ARMS AND AMMUNITION MANUFACTURERS' INSTITUTE, INC.)/ ANSI (AMERICAN NATIONAL STANDARDS INSTITUTE) SPECIFICATIONS WILL VOID THE WARRANTY.

ALWAYS BE SURE THE FIREARM (ESPECIALLY THE BARRELS) ARE FREE AND CLEAR OF ANY OBSTRUCTIONS THAT MAY RESTRICT (OR SLOW DOWN) THE BULLET

FROM LEAVING THE MUZZLE AT ITS NORMAL RATE OF SPEED. THIS INCLUDES SNOW, WATER, BRUSH, SHRUBS, STICKS, LEAVES AND DEBRIS TO NAME A FEW. NEVER PLACE THE END OF A BARREL OR SUBMERGE A FIREARM UNDER WATER. RESTRICTING, SLOWING, OR STOPPING THE BULLET FROM LEAVING THE MUZZLE WILL CREATE AN EXCESSIVE AMOUNT OF PRESSURE TO BUILD UP BEHIND IT AND MAY LEAD TO EXTENSIVE DAMAGE TO THE FIREARM AND PERSONAL INJURY TO THE SHOOTER AND/OR BYSTANDERS. SAFE OPERATION IS YOUR RESPONSIBILITY AND CAN ONLY BE CONTROLLED BY YOU!

KNOW EXACTLY WHERE YOU ARE POINTING THE BARREL OF A FIREARM AND WHY!

IT IS SO IMPORTANT TO STRESS THAT A FIREARM IS NO MORE THAN AN ASSEMBLY OF MANY DIFFERENT COMPONENTS – A MECHANICAL DEVICE. AS SUCH, YOU ARE THE ONLY SAFETY MECHANISM THAT CAN PREVENT AN ACCIDENT.

The safety on your Model 42 has two positions:

- FULL SAFE - Push the safety button fully to the right covering the red band.
- SAFETY OFF - READY TO FIRE. Push the safety button fully to the left exposing the red band.

FULL SAFE

1. The safety is in the *FULL SAFE* position when it has been pushed fully to the right (holding the firearm in the normal shooting position with the barrel pointing down range), covering the red “band” (see FIGURE 1).



FIGURE 1

2. The safety should be moved to the *FULL SAFE* position when either one or both barrels are loaded and the action closed.
3. In the *FULL SAFE* position, the hammer is blocked from striking the firing pins.

WHEN CARRYING A LOADED FIREARM, THE SAFETY MUST ALWAYS BE IN THE FULL SAFE POSITION.

THE ONLY TIME YOU CAN BE ABSOLUTELY CERTAIN THAT A GUN CANNOT FIRE IS WHEN THE ACTION IS OPEN AND IT IS COMPLETELY EMPTY OF AMMUNITION.

SAFETY OFF – READY TO FIRE

1. The safety is in the SAFETY OFF – READY TO FIRE position when it has been pushed fully to the left (holding the firearm in the normal shooting position with the barrel pointing down range), exposing the red “band” (see FIGURE 2).



FIGURE 2

2. The safety should be moved to the SAFETY OFF – READY TO FIRE position only when you have clearly identified your target, sights lined up properly on what it is you intend to shoot, and verified that should the bullet miss or continue traveling through the target, the area is clear.
3. In the SAFETY OFF – READY TO FIRE position, the hammer will strike the firing pin when cocked and the trigger pulled.

NEVER TRANSPORT/CARRY A LOADED FIREARM WITH THE SAFETY OFF.

SECTION 3 – LOADING / FIRING / UNLOADING / ADJUSTING THE REAR SIGHT

LOADING

THE MODEL 42 BARREL ASSEMBLY CAN NOT BE REMOVED FROM THE FRAME. ATTEMPTING TO DO SO MAY RENDER THE FIREARM UNSAFE TO SHOOT AND ALSO VOID THE WARRANTY.

FIREARMS SHOULD BE LOADED ONLY WHEN YOU ARE IN THE FIELD, ON THE TARGET RANGE, OR AT A SHOOTING AREA READY TO SHOOT.

ALWAYS KEEP THE MUZZLE POINTED IN A SAFE DIRECTION.

USE ONLY THE CORRECT AMMUNITION THAT IS INDICATED (STAMPED) ON THE SIDE OF THE BARRELS (SEE FIGURE 3).

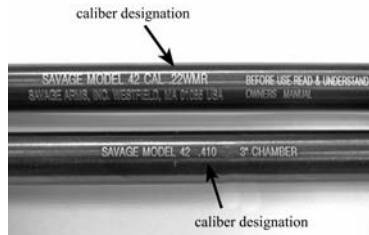

FIGURE 3

THOROUGHLY CLEAN THE INSIDE OF THE BARRELS AND CHAMBERS PRIOR TO LOADING WITH AMMUNITION.

ALWAYS BE SURE THE FIREARM (ESPECIALLY THE BARRELS) ARE FREE AND CLEAR OF ANY OBSTRUCTIONS THAT MAY RESTRICT (OR SLOW DOWN) THE BULLET FROM LEAVING THE MUZZLE AT ITS NORMAL RATE OF SPEED. THIS INCLUDES SNOW, WATER, BRUSH, SHRUBS, STICKS, LEAVES AND DEBRIS TO NAME A FEW. NEVER PLACE THE END OF A BARREL OR SUBMERGE A FIREARM UNDER WATER. RESTRICTING, SLOWING, OR STOPPING THE BULLET FROM LEAVING THE MUZZLE WILL CREATE AN EXCESSIVE AMOUNT OF PRESSURE TO BUILD UP BEHIND IT AND MAY LEAD TO EXTENSIVE DAMAGE TO THE FIREARM AND PERSONAL INJURY TO THE SHOOTER AND/OR BYSTANDERS. SAFE OPERATION IS YOUR RESPONSIBILITY AND CAN ONLY BE CONTROLLED BY YOU!

THE USE OF RELOADS, HANDLOADS,

MILITARY SURPLUS, OR ANY OTHER COMMERCIAL/ NONCOMMERCIAL AMMUNITION NOT MANUFACTURED TO SAAMI (SPORTING ARMS AND AMMUNITION MANUFACTURERS' INSTITUTE, INC.)/ANSI (AMERICAN NATIONAL STANDARDS INSTITUTE) SPECIFICATIONS WILL VOID THE WARRANTY.

KNOW YOUR GUN! IF ANYTHING 'FEELS' OR SOUNDS DIFFERENT WHEN LOADING OR SHOOTING - STOP - AND HAVE A QUALIFIED GUNSMITH TAKE A LOOK! NEVER TAKE A CHANCE WITH SOMETHING THAT YOU ARE UNSURE OF ... ALWAYS ASK A PROFESSIONAL.

1. With the muzzle pointed in a safe direction, place one hand under the forend and push the OPENING LEVER rearward to open the action (see FIGURE 4).



FIGURE 4

2. Insert the correct caliber/gauge cartridge/shell (stamped on the barrel) into its respective chamber (see FIGURE 5).

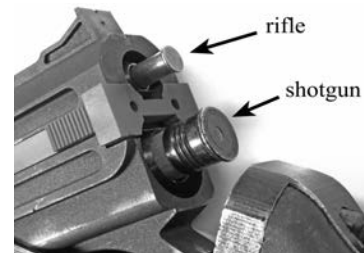

FIGURE 5

3. Move the safety to the FULL SAFE position (see FIGURE 1).
4. Rotate the forend upward, closing the action securely.
5. Position the barrel selector to fire the appropriate shell/cartridge (see FIGURE 6 and FIGURE 7).



FIGURE 6



FIGURE 7

ALWAYS KEEP THE MUZZLE POINTED IN A SAFE DIRECTION.

TO FIRE

SHOOTING A SHOTGUN IS DIFFERENT FROM SHOOTING A RIFLE. WITH THE RIFLE YOU MUST AIM PRECISELY. WITH A SHOTGUN YOU POINT AT THE TARGET. BECAUSE OF THIS, THE FUNDAMENTALS OF SHOTGUN SHOOTING ARE DIFFERENT.

DO NOT MOVE THE SAFETY TO THE SAFETY OFF – READY TO FIRE POSITION (SEE FIGURE 2) UNTIL YOU ARE READY TO SHOOT.

THE ONLY TIME YOU CAN BE ABSOLUTELY CERTAIN THAT A GUN CANNOT FIRE IS WHEN THE ACTION IS OPEN.

NEVER TOUCH THE TRIGGER ON A FIREARM UNTIL YOU ACTUALLY INTEND TO SHOOT.

NEVER POINT YOUR GUN AT ANYTHING YOU DO NOT INTEND TO SHOOT.

BE SURE TO WEAR ADEQUATE EYE AND HEARING PROTECTION (CONSULT MANUFACTURER FOR THEIR RECOMMENDATION) WHENEVER YOU INTEND TO SHOOT. HEARING LOSS AS WELL AS IRREPARABLE EYE DAMAGE CAN OCCUR UNLESS YOUR EYES AND EARS ARE PROPERLY PROTECTED .

ALWAYS KEEP THE MUZZLE POINTED IN A SAFE DIRECTION.

1. Keep your finger off the trigger and out of the trigger guard until you are ready to shoot.
2. Always look carefully around to be sure that no one will cross in front of you when you are ready to shoot.
3. Place the firearm to your shoulder and push the safety to the left **SAFETY OFF – READY TO FIRE** position and take aim.
4. Cock the hammer fully rearward, place your finger in the trigger guard, and when you are on target squeeze the trigger slowly.

NO ONE CAN CALL A BULLET BACK.

ALWAYS KEEP THE MUZZLE POINTED IN A SAFE DIRECTION.

5. With the hammer still uncocked, reposition the barrel selector to fire the other barrel (if loaded).
6. Place the firearm to your shoulder and take aim.

7. Place your finger in the trigger guard and when you are on target, squeeze the trigger slowly.

UNLOADING YOUR RIFLE

KEEP YOUR FINGERS AWAY FROM THE TRIGGER.

ALWAYS KEEP THE MUZZLE POINTED IN A SAFE DIRECTION.

THE MODEL 42 IS NOT EQUIPPED WITH AUTOMATIC EXTRACTORS OR EJECTORS! AFTER OPENING, YOU MUST MANUALLY GRASP THE EXTRACTOR BAR TO REMOVE THE CARTRIDGE/SHELL.

1. Be sure the safety is in the FULL SAFE position (see FIGURE 1).
2. Place one hand under the forend and push the OPENING LEVER rearward to open the action (see FIGURE 4).
3. Grasp the extractor bar from both sides and pull rearward (see FIGURE 8).



FIGURE 8

4. With your thumb and index finger, grab the rim of the cartridge/shell and pull rearward until it clears the chamber.

LOOK AND FEEL! BE SURE THE CHAMBERS ARE EMPTY – DO NOT ASSUME!

A LOADED GUN HAS NO PLACE IN OR NEAR A VEHICLE OR BUILDING.

ADJUSTING THE SIGHTS

SHOOTING A SHOTGUN IS DIFFERENT FROM SHOOTING A RIFLE. WITH THE RIFLE YOU MUST AIM PRECISELY. WITH A SHOTGUN YOU POINT AT THE TARGET. BECAUSE OF THIS, THE FUNDAMENTALS OF SHOTGUN SHOOTING ARE DIFFERENT.

1. For elevation, loosen the LOCK DOWN screw (see FIGURE 9).
2. Use a 1/16 inch Allen wrench to turn the rear sight ADJUSTMENT screw.
 - To raise the impact point, turn the screw

clockwise (holding the firearm in the normal shooting position with the barrel pointing down range).

- To lower the impact point, turn the screw counterclockwise (holding the firearm in the normal shooting position with the barrel pointing down range).

TURN THE SCREW $\frac{1}{4}$ TURN INCREMENTS UNTIL THE DESIRED BULLET IMPACT HAS BEEN ACHIEVED.

- To shift the impact point to the right, slightly move the rear sight to the right (holding the firearm in the normal shooting position with the barrel pointing down range).

DO NOT FORCE THE SIGHT, A SLIGHT NUDGE IS ALL THAT IS NEEDED UNTIL THE DESIRED BULLET IMPACT HAS BEEN ACHIEVED.

4. Tighten (just 'snug') the LOCK DOWN screw.



FIGURE 9

3. For windage, loosen the LOCK DOWN screw only – NOT the rear sight ADJUSTMENT screw.
 - To shift the impact point to the left, slightly move the rear sight to the left (holding the firearm in the normal shooting position with the barrel pointing down range).

SECTION 4 – PARTS LIST AND DIAGRAM

As a 'customer driven' company, some parts may now be ordered directly from our web site (within the continental United States) (WWW.SAVAGEARMS.COM) twenty four hours a day, needing only your serial number and credit card. For accessing our part finder via your Smartphone, please use the QR Code below. Should you not have access to our web site, parts can be ordered directly from Savage Arms [413-568-7001] between the hours of 9:00 a.m. and 4:00 p.m. (Eastern Time). There is a minimum order and please allow 2 weeks for delivery. Only the parts indicated may be purchased by an individual. All other parts/sub-assemblies are either 'factory fit' or available to qualified gunsmiths only.

Please be advised that some parts may require fitting. Savage Arms bears no responsibility for the function or performance of any firearm that has been repaired or modified by other than Savage Arms Service Department. As such, Savage Arms accepts no responsibility/liability for any direct and/or consequential damage and/or injury resulting from the use of a firearm repaired or modified by other than the Savage Arms Service Department.

QR Code for your Smartphone for purchasing parts directly from our website – no calls – no waiting – 24 hours a day.



STORE.SAVAGEARMS.COM/PARTFINDER

MODEL 42:

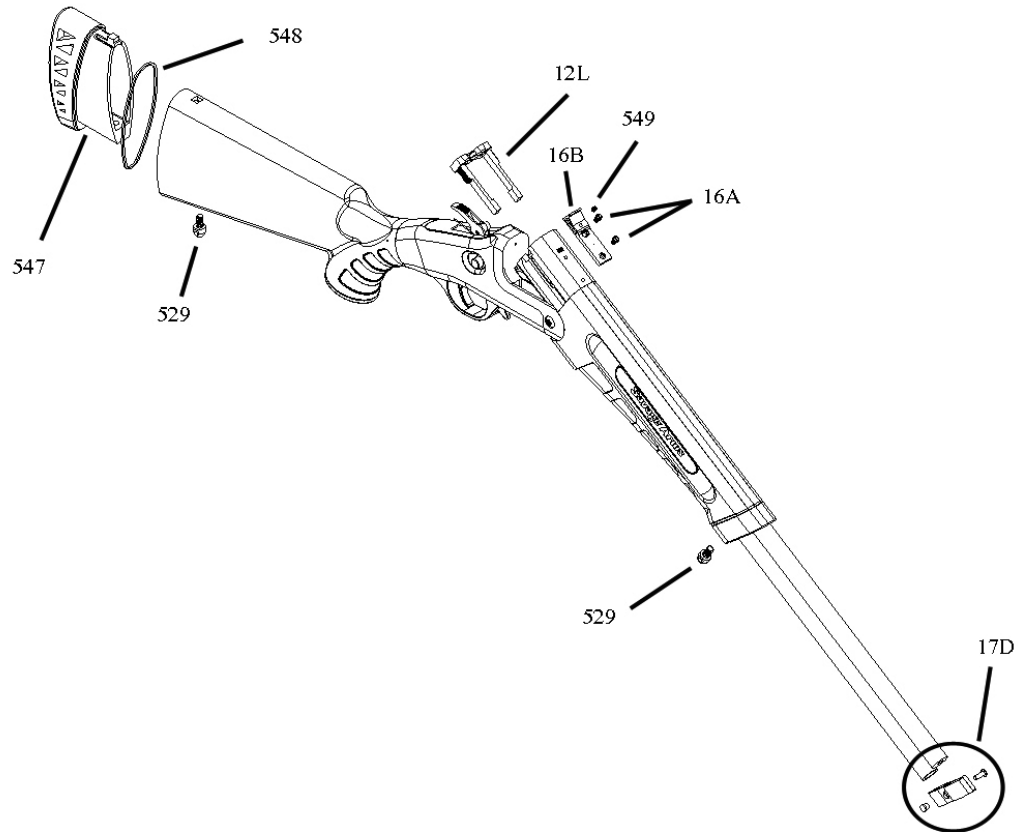

<u>Item #</u>	<u>Description</u>
12L	Extractor assembly
16A	Rear sight screw (2)
16B	Rear sight assembly
17D	Front sight assembly
529	Swivel stud (2)
547	Recoil pad
548	O-ring, recoil pad
549	Elevation adjustment screw

SECTION 5 - AMMUNITION BULLET WEIGHTS

Bullet specifications and trajectories are available directly from the ammunition manufacturer.

The following table lists the bullet weights used for 100 yard targeting evaluation at Savage Arms.

Performance may vary based on brand/type of ammunition, individual characteristics of the firearm, and/or shooting conditions.

USE ONLY THE CORRECT AMMUNITION THAT IS STAMPED ON THE SIDE OF THE BARRELS.

ATTEMPTING TO SHOOT A CENTERFIRE CARTRIDGE FROM THE SHOTGUN BARREL MAY RESULT IN DAMAGE TO THE FIREARM AND/OR SERIOUS INJURY OR DEATH TO THE SHOOTER OR A BYSTANDER.

THE USE OF RELOADS, HANDLOADS, MILITARY SURPLUS, OR ANY OTHER COMMERCIAL / NONCOMMERCIAL AMMUNITION NOT MANUFACTURED TO SAAMI (SPORTING

ARMS AND AMMUNITION MANUFACTURERS' INSTITUTE, INC.)/ ANSI (AMERICAN NATIONAL STANDARDS INSTITUTE) SPECIFICATIONS WILL VOID THE WARRANTY.

Caliber	Bullet Weight (Grains)
22 Long Rifle	Federal American Eagle 40 grain (lead soft point)
22 WMR	Federal 50 grain (jacketed hollow point)
.410 Bore	Winchester AA

SECTION 6 - MOUNTING A SCOPE

Never attempt to work on, disassemble, clean, or oil a loaded firearm!

1. Using a straight blade screw driver, remove the rear sight mounting screws (see FIGURE 10).



FIGURE 10

2. Using 6 X 48 screws, install a EVOLUTION GUN WORKS (EGW-41942) or equivalent scope mount.
3. Attach Weaver style rings following the manufacturer's instructions.
4. Install the scope, reading the manufacturer's instructions carefully to reduce the possibility of damage or an injury should it become loose or hit your head during recoil.

SHOULD A PROBLEM ARISE MOUNTING THE BASE, RINGS, OR SCOPE, CONTACT THE RESPECTIVE MANUFACTURER OR SAVAGE ARMS SERVICE DEPARTMENT FOR GUIDANCE.

SECTION 7 – MAINTENANCE

ROUTINE MAINTENANCE:

YOUR GUN IS A MECHANICAL DEVICE WHICH WILL NOT LAST FOREVER AND IS SUBJECT TO WEAR. AS WITH ANY PRECISION TUNED MECHANICAL DEVICE, PERIODIC INSPECTION/ MAINTENANCE IS REQUIRED – AND YOUR RESPONSIBILITY!

THE MODEL 42 BARREL ASSEMBLY CAN NOT BE REMOVED FROM THE FRAME. ATTEMPTING TO DO SO MAY RENDER THE FIREARM UNSAFE TO SHOOT AND ALSO VOID THE WARRANTY.

1. TIMEFRAMES: It is difficult to establish a time period or number of rounds as the basis for when a firearm should be examined, cleaned, and thoroughly inspected. Different shooting conditions, weather patterns, and types of ammunition, to list a few, all play a significant role in answering the questions 'when' and 'how often'. As a general rule, 'more often' is much safer than 'not enough'.
 - As a start, the TWO POSITION SAFETY should be checked prior to loading live ammunition. This is an important step that should be done **every time** the firearm is prepared for use.
 - Verify the OPENING LEVER opens the action freely/smoothly and the barrel assembly locks securely when closed.
 - Open the action, look down the barrels to

be sure they are clear of any obstructions, and that there are no signs of damage (nicks, scratches, etc.), rust, or pitting.

- Function the extractor lever making sure that it moves without binding.
- Check the outer surface of the barrels, running your fingers gently down their length, feeling for any bulges or signs of damage.
- While the action is open, inspect the frame and firing pin face for signs of damage or excessive wear.
- Carefully examine the stock and studs that secure the carrying strap.
- Check the scope mount/rings to be sure they have not loosened.

2. WHO SHOULD DO THE CHECKING: As the owner – or user – it is your primary responsibility to assure the firearm is safe prior to using it. Although we know its condition when it leaves the factory, we have no control or insight as to what has or has not been done once it leaves our hands.

After reading and understanding this INSTRUCTION MANUAL – and **prior to** loading with live ammunition - you should be very familiar and capable of handling the items noted above. In depth mechanical issues or questions as well as periodic examinations should be referred to a qualified gunsmith or Savage Arms Service Department. Mechanical devices will by the nature of their design, wear and as such may

require very specific adjustments. In the wrong hands, a 'simple' adjustment could result in serious damage to the firearm or even worse, injury or death to the shooter or bystander.

KNOW YOUR GUN! IF ANYTHING 'FEELS' OR SOUNDS DIFFERENT - STOP - AND HAVE A QUALIFIED GUNSMITH TAKE A LOOK! NEVER TAKE A CHANCE WITH SOMETHING THAT YOU ARE UNSURE OF ... ALWAYS ASK A PROFESSIONAL.

CLEANING AND CARE OF YOUR FIREARM

DISASSEMBLE ONLY ONE FIREARM AT A TIME TO AVOID INTERCHANGING COMPONENTS.

LOOK AND FEEL! BE SURE THE CHAMBERS ARE COMPLETELY EMPTY – DO NOT ASSUME!!!

NEVER ATTEMPT TO DISASSEMBLE, CLEAN, OR OIL A LOADED FIREARM!

BE SURE TO READ AND UNDERSTAND ALL OF THE CAUTIONS AND WARNINGS ON ALL SOLVENTS AND CHEMICALS PRIOR TO USE. FOLLOW THE MANUFACTURER'S INSTRUCTIONS FOR BEST CLEANING RESULTS.

CLEANING

1. Prepare an area for cleaning the firearm with a suitable surface, adequate ventilation, correct caliber cleaning rod, brush, patches, powder solvent, and oil.
 2. Open the action.
 3. Lay the firearm horizontally.
- ALWAYS STARTING FROM THE CHAMBER END, PUSH THE CLEANING ROD THROUGH THE BORE AND OUT THE MUZZLE END.**
4. Using a small amount of powder solvent on the brush, push the cleaning rod through the barrel several times.
 5. Unscrew the brush from the cleaning rod and replace it with a patch tip.
 6. Push a new patch through the bore starting from the chamber end and out the muzzle.
 7. Repeat the prior step (# 6) several times.
 8. Push a new patch saturated with gun oil through the bore.
 9. Push a new dry patch through the bore to remove the excess oil.
 10. When done, always verify that the "TWO POSITION SAFETY" is operational as explained in the beginning of SECTION 2.

CHECK THE BORES CAREFULLY WHEN DONE TO BE SURE THERE ARE NO OBSTRUCTIONS (I.E. PIECES OF CLEANING PATCH, ETC.).

A VERY THIN FILM OF OIL IS SUFFICIENT PROTECTION – DO NOT OVER OIL!!!

FAILURE TO PROPERLY MAINTAIN YOUR FIREARM MAY LEAD TO DAMAGE AND/OR SERIOUS INJURY TO THE SHOOTER OR BYSTANDER.

PROTECTING METAL SURFACES

1. In order to be able to reach all surfaces, open the action prior to cleaning and oiling.
2. With a soft cloth, remove any foreign matter (i.e. mud, twigs, grass).
3. Apply a thin coat of gun oil on all cleaned metal surfaces. Rubbing may be necessary to remove any signs of rust.
4. Where accessible, clean and lightly oil interior metal surfaces.
5. When done, always verify that the "TWO POSITION SAFETY" is operational as explained in the beginning of SECTION 2.

CHECK THE BORES CAREFULLY WHEN DONE TO BE SURE THERE ARE NO OBSTRUCTIONS (I.E. PIECES OF CLEANING PATCH, ETC.).

ALWAYS MAKE SURE THE TWO POSITION SAFETY IS FUNCTIONAL. THIS IS AN IMPORTANT STEP THAT SHOULD BE DONE EVERY TIME THE FIREARM IS PREPARED FOR USE.

VERIFY THE OPENING LEVER OPENS THE ACTION FREELY/SMOOTHLY AND THE BARREL ASSEMBLY LOCKS SECURELY WHEN CLOSED.

OPEN THE ACTION, LOOK DOWN THE BARRELS TO BE SURE THEY ARE CLEAR OF ANY OBSTRUCTIONS, AND THAT THERE ARE NO SIGNS OF DAMAGE (NICKS, SCRATCHES, ETC.), RUST, OR PITTING.

FUNCTION THE EXTRACTOR LEVER MAKING SURE THAT IT MOVES WITHOUT BINDING.

SECTION 8 - STATEMENT OF LIMITED WARRANTY

FOR MORE INFORMATION, PLEASE VISIT OUR WEB SITE AT: WWW.SAVAGEARMS.COM

STATEMENT OF LIMITED WARRANTY

For your convenience, registration may now be completed directly from our web site (WWW.SAVAGEARMS.COM) twenty four hours a day. Should you not have access to our web site, please complete the WARRANTY REGISTRATION CARD and return it to Savage Arms, Inc. within ten (10) days from the date of purchase.

WHO IS COVERED?

- The original owner (with proof of purchase).

WHAT IS COVERED?

- Any defect in materials or workmanship (performed by Savage Arms) encountered during normal use.

HOW LONG IS THE WARRANTY PERIOD?

- One (1) year from the date of purchase.

WHAT IS NOT COVERED?

PERSONAL INJURY, PROPERTY DAMAGE, AND/OR DAMAGE TO THE FIREARM CAUSED BY:

- Improper maintenance or negligence to provide proper care and maintenance.
- Alterations/modifications performed without the written authorization of Savage Arms, Inc. Service Department.
- Normal wear; tear; and/or corrosion.

- Accidental discharge, careless handling, and/or misuse.
- Barrel obstructions.

EXCLUSIONS AND LIMITATIONS:

This WARRANTY and the remedies set forth herein are exclusive and take the place of all other expressed or implied WARRANTIES (including any implied WARRANTY of merchantability or fitness for any particular purpose which are disclaimed). No other representations or claims of any nature shall be binding on or obligate Savage Arms, Inc.

Savage Arms, Inc. excludes any incidental and consequential damages under this warranty. Some states do not allow exclusions or limitations on how long an implied warranty lasts, so the above limitations may not apply to you.

This WARRANTY gives you specific legal rights. You may have other rights, which will vary from state to state.

RETURNING A FIREARM:

For WARRANTY claims, proof of purchase must accompany the firearm.

It is a violation of Federal Law to ship a firearm with live ammunition either in the detachable box magazine, chamber, or placed in the box. For the safety of all involved PLEASE be sure there is no ammunition in either the chamber, detachable box magazine, or box.

Savage Arms, Inc. is not responsible for the loss

or damage to any accessories shipped with the firearm.

If there is a question whether the firearm should be returned or parts could be purchased, please call 1-413-568-7001 between 9:00 am and 4:00 p.m. Eastern Time and ask for the Service/Warranty Department.

All firearms are to be sent to Savage Arms, Inc. at the owner's expense. Warranty repairs will be returned to the owner at Savage Arms' expense.

1. Pack the firearm in its original box if possible. If a similar suitable box is used, care should be taken to protect the barrel/muzzle from breaking through. Always pack with the assumption that the firearm will undergo rough handling during transit to Savage Arms.

2. Enclose a brief note including:

- name, address and phone number of the sender
- serial number of the firearm
- description of the problem you are having
- bullet weight, bullet type, and manufacturer of the ammunition you are using
- any other information which you feel may be helpful.

3. Return to:

Savage Arms, Inc.
100 Springdale Road
Westfield, MA 01085
Attn: Service Department

4. If there will be a charge involved for the repair, a quote will be sent within fourteen (14) working days.

- If there is no response from the quote within thirty (30) days, the firearm will be returned COD (\$20.00 Shipping/Handling).

Firearms will be repaired typically 3 weeks after receipt of payment in the order they were received.

109389 – (05/12)

Download a QR Code reader application for your Smartphone and then snap this to complete your WARRANTY REGISTRATION on-line.



WWW.SAVAGEARMS.COM/CUSTOMERSERVICE/WARRANTYREGISTRATION



WARNING

Children are attracted to and can operate firearms that can cause severe injury or death. Prevent child access by always keeping guns locked away and unloaded when not in use. If you keep a loaded firearm where a child obtains and improperly uses it, you may be fined or sent to prison.



ADVERTENCIA

A los niños los atraen las armas de fuego y las pueden hacer funcionar. Ellos pueden causarse lesiones graves y la muerte. Evite que los niños tengan acceso a las armas de fuego guardándolas siempre con llave y descargadas cuando no las esté utilizando. Si usted tiene un arma de fuego cargada en un lugar en que un niño tiene acceso a ella y la usa indebidamente, le pueden dar una multa o enviarlo a la cárcel.



Savage Arms
The Definition of Accuracy

109389 (05/12) Rev. 0

100 Springdale Road
Westfield, MA 01085
www.savgearms.com