

# Owner's Manual

# *Marlin*<sup>®</sup>

## SELF-LOADING RIMFIRE

### Rifle (22 L.R. and 17 Mach 2)

### With Clip Magazine



## IMPORTANT

*This manual contains operating, care and maintenance instructions. To assure safe operation, any user of this firearm must read this manual carefully. Failure to follow the instructions and warnings in this manual can cause accidents resulting in injury or death. This manual should always accompany this firearm, and be transferred with it upon change of ownership.*

*The warranty card bound into this manual must be filled out and mailed within 10 days of purchase.*

**WARNING: KEEP THIS FIREARM OUT OF THE REACH OF CHILDREN, UNAUTHORIZED INDIVIDUALS, AND OTHERS UNFAMILIAR WITH THE SAFE HANDLING OF FIREARMS.**

## COMES WITH MARLIN'S 5-YEAR WARRANTY

# How Your Rifle is Made

---

Your rifle has been made to Marlin's strictest standards of safety and reliability. It has been proof tested with a high pressure load, function fired, and checked for accuracy at the factory. Built with tradition and engineered to last, your rifle is the product of over 135 years of Marlin technology.

## Before You Use This Firearm

---

It is very important that you read and understand this manual before using your new rifle. Warnings should be read and heeded carefully. Also follow the safety rules listed in "Marlin's Guide to Gun Safety", printed on this page.

- **WARNING:** Marlin firearms are designed and manufactured to handle standard factory-loaded ammunition which conforms to SAAMI (Sporting Arms and Ammunition Manufacturers' Institute Inc.) standards with dependability and safety. Due to the many bullet and load options available, the element of judgement involved, the skill required, and the fact that serious injuries have resulted from dangerous handloads, Marlin does not make any recommendations with regard to handloaded ammunition.
- **WARNING:** Your rifle should not be assembled, used or disassembled without fully reading and understanding the instructions in this manual.
- **WARNING:** It is a violation of federal law to alter or deface the serial number of any firearm.

### Marlin's Guide to Gun Safety

1. Read and understand the owner's manual before using a firearm.
2. If you are unfamiliar with firearms, attend a firearms safety class taught by a certified instructor.
3. Handle every firearm as if it were loaded and ready to fire.
4. Control the muzzle, and never point a firearm at anything you don't want to shoot.
5. Keep the safety on SAFE until you are ready to shoot.
6. Unless you are hunting, carry your firearm empty, with the action open.
7. Before shooting, be sure you have an adequate backstop. All ammunition is dangerous beyond your line of sight.
8. Avoid ricochets by never shooting at water or any hard, flat surface.
9. Do not run, climb, or jump over an obstacle with a loaded firearm.
10. Do not climb into or out of a tree or tree stand with a loaded firearm. Do not allow others to pass loaded firearms to you while in a tree stand.
11. Do not enter or ride in a motor vehicle with loaded firearms.
12. Do not lean a loaded firearm against anything.
13. Do not bump, drop or jar a loaded firearm.
14. Do not pull a firearm toward you by the muzzle.
15. Wear hearing protectors when shooting.
16. Wear impact-protective glasses when shooting, disassembling or cleaning firearms.
17. Avoid alcoholic beverages and drugs before and during shooting.
18. Use only ammunition of the correct gauge, caliber, size and bullet shape for your firearm.
19. Do not use damaged, dirty, modified, or improperly handloaded ammunition.
20. Keep the barrel and mechanism of the firearm free of obstructions.
21. Do not use a firearm that fails to function properly. Do not try to force a jammed action.
22. Be sure no one is in the path of ejecting shells or cartridges.
23. Do not interchange parts between firearms, and be sure disassembly and reassembly are correct and complete.
24. Before cleaning, be sure the chamber, action and magazine are completely unloaded.
25. Unload firearms before storing, transporting, or leaving unattended.
26. Store firearms and ammunition separately, locked and out of the reach of children.

***Failure to follow these rules, or other instructions in this manual, can result in personal injury.***

The instructions in this shaded section apply to the 70PSS only. The rest of this manual applies to all models.

## How to Assemble the 70PSS

The 70PSS was shipped “taken-down” in two parts. The stock, action and magazine comprise one part, the barrel the other (See 1).

Match the flat surface on the rear (chamber) end of the barrel with the flat surface in the front end of the receiver, and insert the barrel into the receiver as far as it will go. (See 2).

Turn the knurled takedown nut clockwise with your fingers until tight. If you are going to shoot extensively, tighten the nut securely with the spanner wrench (provided), or a coin (See 3).

**•WARNING:** Check the takedown nut frequently to be sure it remains tight. If it loosens, the rifle may not fire.

To disassemble the 70PSS for reinsertion into its case, reverse the above instructions.

## Transportation and Storage Instructions for the 70PSS

If your 70PSS will be subjected to rough handling while in its case, we recommend that you use the foam insert provided, for maximum protection.

Do not store the 70PSS in its case for long periods of time, since moisture can be trapped and condense inside, causing rust or corrosion. For long term storage, it should be lightly oiled and kept in a dry, ventilated area, under lock and key.

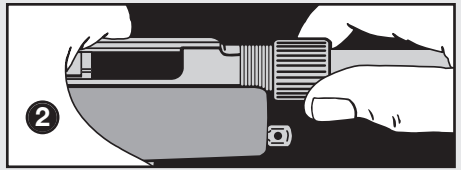
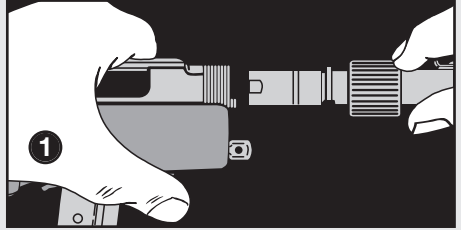

Inserting the barrel

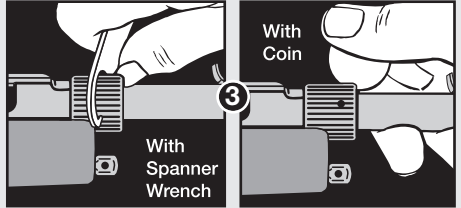

Tightening the takedown nut

## How to Operate the Safety

**•WARNING:** Prior to firing, know and understand the operation of the safety by practicing with the rifle unloaded.

The safety mechanism is a round button located behind the trigger. To put your rifle on SAFE, hold it in the normal shooting position, pointed in a safe direction, and push the safety button from left to right as far as it will go. The safety is now on SAFE (See A).

To move the safety to the FIRE position, push the safety button from right to left as far as it will go. A red ring around the safety button will be visible when the safety is in the FIRE position (See B). If the magazine is in place and the bolt is forward and the trigger is pulled with the safety in this position, the gun will fire.



Safe Position

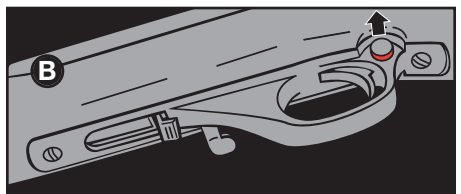

Fire (Off Safe) Position

**NOTE:** This rifle is equipped with a magazine disconnect. It will not fire if the magazine is not in place. Do not, however, use the magazine disconnect as the primary safety *and never as a reason for unsafe firearm handling.*

- **WARNING:** Never disassemble the safety. It has been correctly designed, fitted and tested. Any mechanical device can fail, however, so never rely on the safety to justify careless handling. Never use a firearm with a safety that does not function properly. (See instructions for factory maintenance in this manual.)

## How to Load

---

- **WARNING:** Never attempt to load your rifle with ammunition that does not meet the cartridge designation stamped on the barrel. Use only clean, dry, factory-loaded ammunition which conforms to industry standards.

### Rifles chambered for 22 L.R. ammunition:

- **WARNING:** Your rifle is a self-loading .22 caliber designed for .22 Long Rifle High Velocity cartridges only (not Hyper-Velocity); it will not function with Shorts, Longs or Shot cartridges, and damage or injury may result from their use.

**NOTE:** Our testing has shown that the following types of 22 L.R. ammunition produce the most consistent functioning and the best accuracy in our self-loading 22 rifles:

- CCI Mini-Mag
- CCI Mini-Mag Hollow Point
- Federal Classic High Velocity
- Remington High Velocity (Not Thunderbolt)
- Winchester Super X High Velocity

The following brands of 17 Mach 2 ammunition produce the most consistent functioning in the Model 717M2: Hornady, CCI.

Use of other brands is not recommended.

- **WARNING:** Before loading your rifle, always check the bore and chamber to be sure they are free of grease, oil or any other obstruction.
- **WARNING:** Your self-loading rifle is not designed to be single-loaded and **IT WILL NOT FIRE** unless the magazine is locked in place. Always load cartridges through the magazine as directed. Never use the magazine disconnect as the primary safety or as an excuse for unsafe firearm handling.

1. Place safety on "SAFE".
2. Depress the magazine release latch (See C) and remove the magazine from the rifle.
3. Pull bolt charging handle back and hold.
4. Push the bolt control lever up to the "OPEN" position as indicated on the trigger guard (See G, page 5).
5. Insert up to 10 cartridges (7 for the 70PSS) as shown in D. With the rifle pointed in a safe direction, replace the loaded magazine, being sure it locks in place.

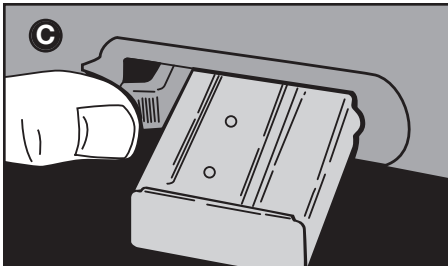

Releasing the magazine

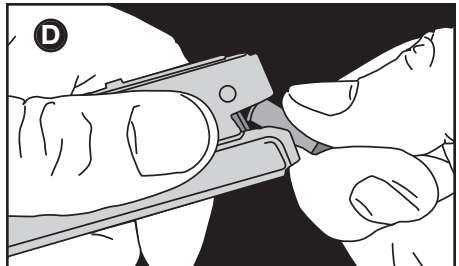

Loading the magazine

6. Keeping fingers away from the trigger, push the bolt control lever down to the "CLOSE" position as indicated on the trigger guard (See H, page 6).

**NOTE:** Allow bolt to slam shut freely. Do not attempt to assist the closing of the bolt with your hand.

## Cocked and Ready

1. Your self-loading rifle is cocked for firing as soon as the bolt is closed during the loading operation as described above.
2. The rifle is ready to fire as soon as the safety is pushed to the "FIRE" position (off "SAFE") position.

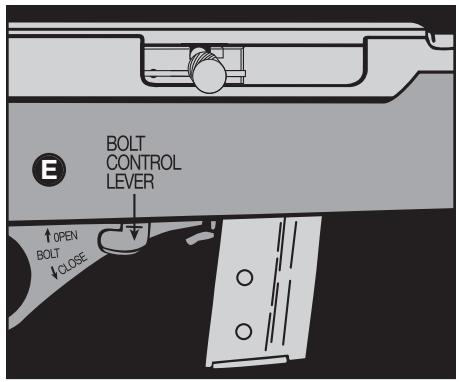

Action locked open

## How to Fire

1. Push the safety to the "FIRE" position and, with the rifle pointed at the target, squeeze the trigger. Since your rifle is self-loading, it is ready to fire again after each shot.
2. If you have not fired all cartridges in the magazine at the target, be sure to move the safety to the "SAFE" position until you are ready to shoot again.

• **WARNING:** Because of its self-loading action, if the bolt of your rifle is completely closed, you must assume that it is cocked and loaded.

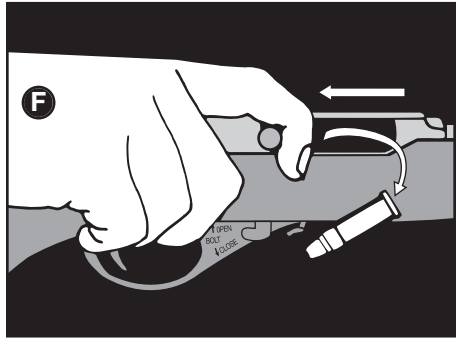

Clearing the action

## How to Unload

• **WARNING:** Before you unload, be sure that the safety is on "SAFE" and the rifle is pointed in a safe direction. Also, keep your fingers away from the muzzle of the rifle.

1. Depress the magazine release latch as shown in C, on page 4, and pull the magazine out of the rifle.
2. Pull the bolt to the rear and lock it in the open position (see "Manual" Bolt Hold-Open Feature.)
3. Inspect the chamber and magazine well.

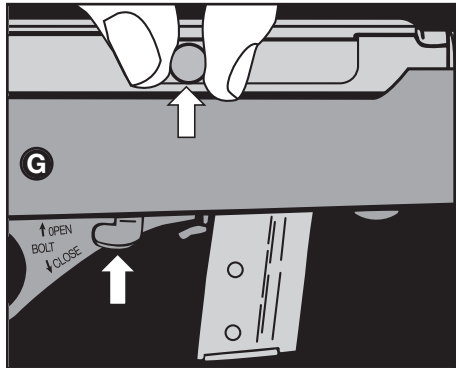

Manual bolt hold-open feature

**NOTE:** If the bolt is in the closed position, pull the bolt charging handle back manually to eject the cartridge left in the chamber (See F).

## Bolt Hold-Open Features

---

### Automatic “Last Shot” Bolt Hold-Open Feature

This safety feature, as shown in F, on page 5, is activated when the last shot in the rifle has been fired (i.e. when the magazine and chamber are empty). The bolt will lock fully open. With the bolt in this position, you should visually check to be sure that the chamber and clip magazine are empty (See E, page 5).

**NOTE:** The “automatic” bolt hold-open will not function unless the empty magazine is still in the rifle.

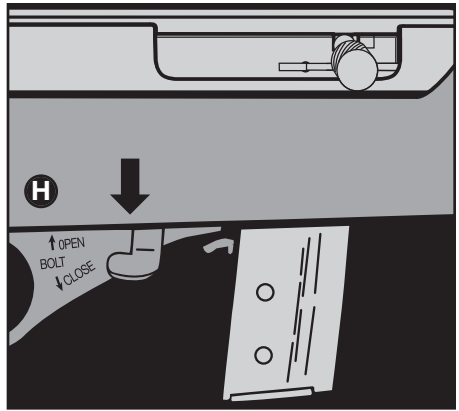

*Closing the bolt*

### Manual Bolt Hold-Open Feature

1. This feature enables you to lock the action open with live rounds in the magazine or with the magazine out of the rifle.
2. With the safety on “SAFE” and the rifle pointed in a safe direction, pull the bolt charging handle all the way back and hold it.
3. Engage the lock by pushing the bolt control lever up and, while holding it up, release the bolt charging handle (See G, page 5).
4. To close the bolt, push the bolt control lever down. (NOTE: If the magazine is loaded, this will chamber a round.) (See H)

## What to do if Rifle Fails to Fire

---

### Misfires

If you have squeezed the trigger and nothing happens, remain in shooting position, pointing the gun in a safe direction. Count to 10, then unload the rifle completely (See “How to Unload” on this page).

### Underpowered Shot

A “squib” or underpowered shot, should not occur if the ammunition is clean, dry, and factory loaded. You can tell if a shot is underpowered by the unusually low sound it makes.

• **WARNING:** Because the bullet may actually still be in the barrel, you must unload completely, and determine, with a cleaning rod, if there is an obstruction. If there is, it should be removed by a qualified gunsmith. Otherwise, personal injury or damage could result.

## Sighting

---

Your rifle has been sighted-in and test-fired at the factory. Due to individual shooting characteristics, however, sighting should be range verified.

**NOTE:** Since the Model 7000 was designed for varmint hunters, who use telescopic sights almost exclusively, it was made with a receiver grooved for the appropriate rings. If you would like to have open sights installed, see a competent gunsmith.

### Vertical Correction (Elevation)

To raise the point of impact, raise the rear sight, by moving the sight elevator rearward. To lower the point of impact, lower the rear sight, by moving the sight elevator forward.



## Horizontal Correction (Windage)

To move the point of impact to the left, tap the rear sight base to the left. To move the point of impact to the right, tap the rear sight base to the right.

**NOTE for the 70PSS:** During assembly or disassembly of the rifle, if the takedown nut moves the rear sight elevator, it will change the point of impact.

## Scope Mounting

---

Your rifle has a grooved receiver designed to handle tip-off-type 22 scope bases. They are made by several manufacturers in various heights, to accommodate different objective diameters, and are available through your local gun dealer. You may also order directly from Marlin Gun Service. Call 1-800-544-8892 for more information.

## How to Clean Your Rifle

---

• **WARNING:** Never attempt to wipe down or clean a loaded firearm. Follow instructions under “How to Unload” before cleaning.

**CAUTION:** Before using any solvent or other gun cleaning product, read the label carefully to be sure it will not damage either the finish, or any parts of this firearm.

**NOTE for stainless steel models:** Although stainless steel is corrosion-resistant, it can rust. If the rifle gets wet, dirty, or is subject to excessive handling, wipe down metal parts with oil or a rust-inhibitor.

Minor scratches can be “buffed out” of stainless steel with a “Scotch-Brite™ Very Fine” pad, available in hardware and automotive supply stores.

## Cleaning the bore

---

Since modern ammunition burns very cleanly, with normal use it is not necessary to clean the bore of your rifle. However, if it gets wet, or if any foreign material gets into the action or barrel, cleaning as described below is recommended.

With the safety on SAFE, remove the magazine and clear the action several times to be doubly sure no cartridges remain. Pull the charging handle back and lock the action open.

To clean the bore and barrel, use any standard .22 caliber commercial cleaning rod and cleaning patches. Clean the barrel with powder solvent and wipe lightly with gun oil after cleaning.

## Cleaning the action

---

We recommend that you wear safety glasses while disassembling this rifle.

We recommend cleaning the inside of the receiver, bolt face, extractors, and breech end of the barrel (around the chamber) after firing each 250 rounds. (Frequency of cleaning may depend on brand of ammunition used.) A toothbrush and commercial gun cleaning solvent will simplify the job. (Be sure to follow manufacturer of gun cleaner’s directions, as some chemicals may damage the synthetic trigger guard.)

The steps listed below should be followed carefully to assure proper disassembly, cleaning and reassembly.

**Step #1** — With the safety on SAFE, remove the magazine and clear the action several times to be sure the chamber is empty. Close the bolt (See H, page 6).

**Step #2** — Unscrew takedown screws A and B as shown in I, on page 8. (For the 70PSS, one end of the spanner wrench is a screw driver.) Remove the trigger guard assembly. Separate the rifle into two segments, the stock and the barreled action.

Release assembly post by squeezing and pushing in slotted end. Pull post free of action. (See J). Remove action by sliding it to the rear and up (See K).

**Step #3** — With the action removed, the bolt, charging handle, recoil spring and spring guide may now be removed.

•**WARNING:** Recoil spring is compressed at this point and, if not handled properly, can fly from the receiver.

Pull the charging handle back slightly and, with the forefinger of your other hand, lift the muzzle end of the bolt from the receiver (See L, page 9).

As you begin to lift the bolt out, the charging handle will become free and can be removed. The recoil spring and spring guide are now within easy reach for removal (See M, page 9).

**Step #4** — The barrel, receiver and action are now ready for thorough cleaning. The action should be cleaned in solvent, dried, and oiled sparingly prior to reassembly.

Further disassembly of the action is not recommended and should only be attempted by a qualified gunsmith or the factory.

**Step #5** — (Reassembly is easier if gun is secured in a padded vise, or held by an assistant.) To reassemble, place recoil spring guide into one end of the recoil spring, then place opposite end of spring into breech bolt. Next, put recoil spring guide into hole at the rear of the receiver. To prevent kinking the spring, hold breech bolt and recoil spring in one hand and use the other hand to support the spring as shown in N, on page 9, while compressing spring until guide enters breech bolt.

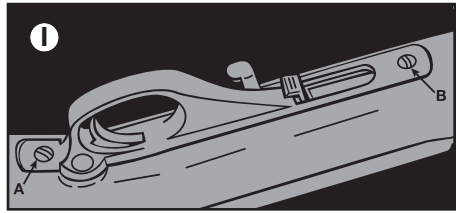

*Remove takedown screws*

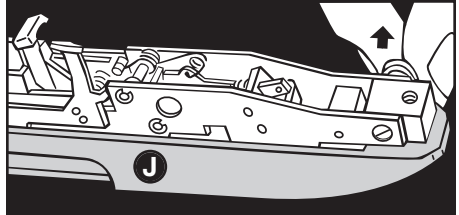

*Remove assembly post*

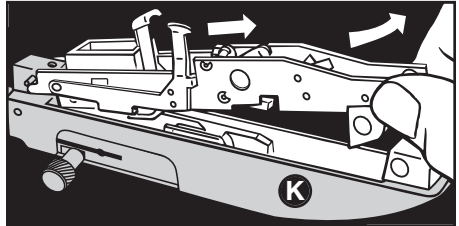

*Remove action*



**Step #6** — The charging handle can now be positioned through the ejection port. To complete the insertion of the breech bolt, be sure the charging handle fits into the slot provided for it in the bolt.

Reinstall the action by pulling the charging handle all the way back and locking it in the open position, and reversing the action disassembly procedure (See O).

When reassembling the barreled action and stock, be sure the receiver is seated as far back in the stock as it will go while tightening the takedown screw. Otherwise, the rifle may not fire.

Reinstall the trigger guard assembly and tighten takedown screws.

When reassembling the barreled action to the stock, take care not to bend or damage the magazine release lever as you insert it through the slot in the trigger guard.

•**WARNING:** Never attempt to wipe down or clean a loaded rifle.

For the 70PSS, if you intend to use your rifle after cleaning, replace the barrel as described in “How to Assemble the 70PSS.”

Use a very thin coat of light oil during below freezing conditions. Condensation droplets will form soon after the rifle is brought into a warm room, or it may become wet during inclement weather. In any case, all moisture should be removed. Exterior metal finishes may be wiped down with a slightly oiled cloth. For long term storage, lightly oil the bore, barrel and action with gun oil. Your rifle should be completely unloaded and stored in a dry area. Never store your rifle in a carrying case.

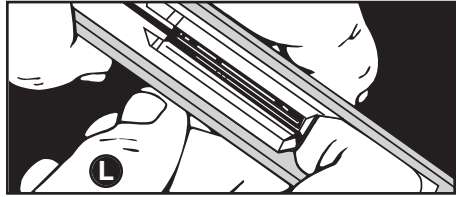

*Lift muzzle end of bolt from receiver*

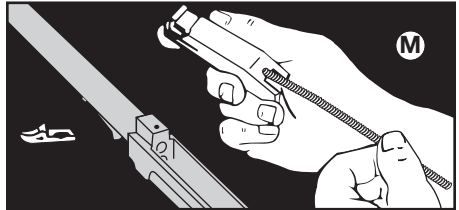

*Remove charging handle, recoil spring, and spring guide*

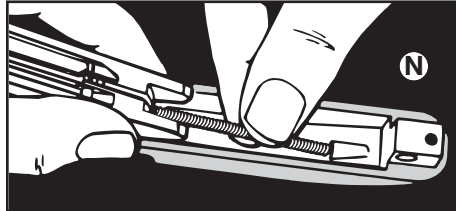

*Support recoil spring to prevent kinking*

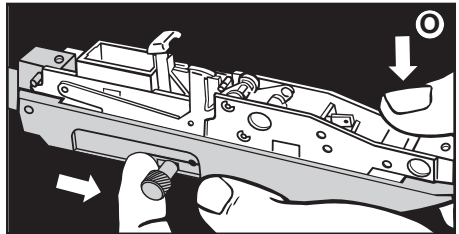

*Pulling charging handle back to replace action*

# Marlin®

## SELF-LOADING RIMFIRE

### Rifle With Clip Magazine (22 L.R. and 17 Mach 2)

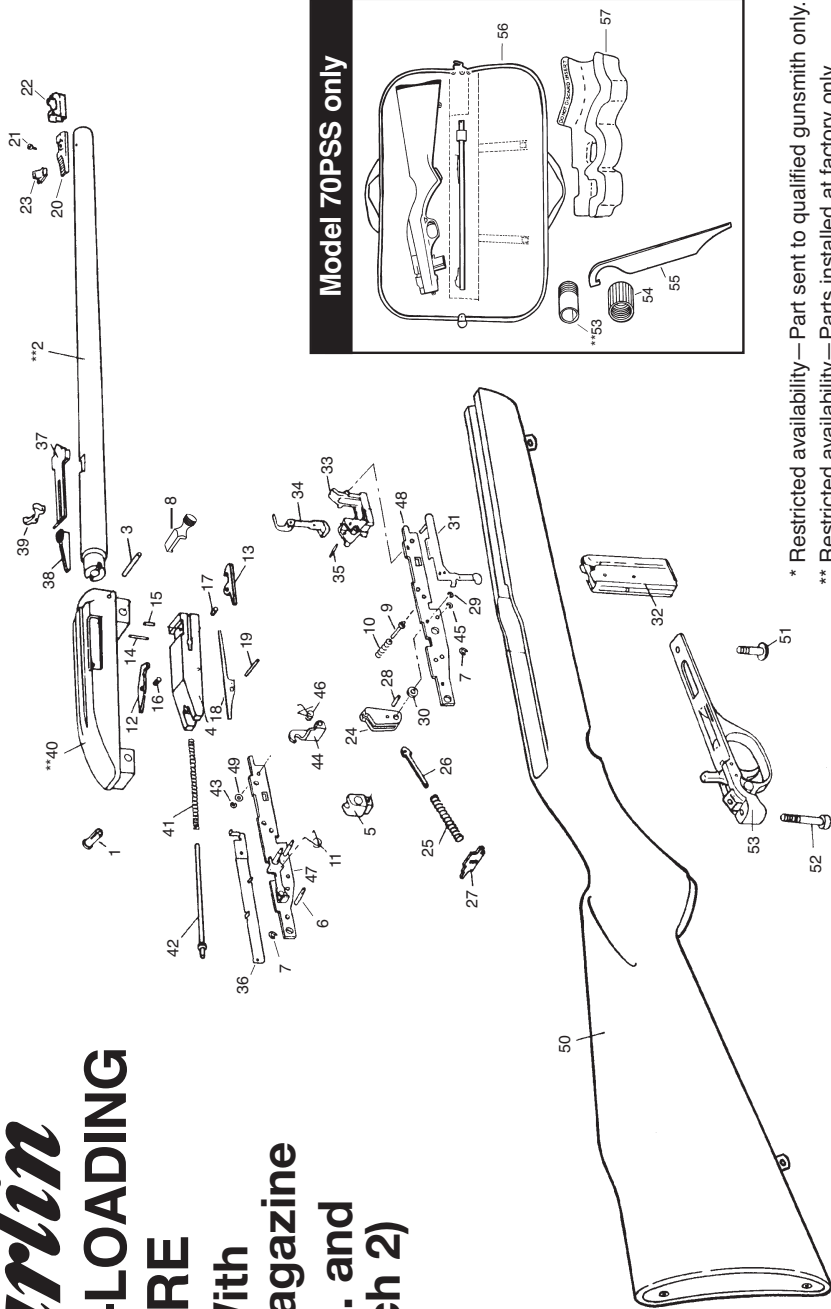

**Model 70PSS only**

- \* Restricted availability—Part sent to qualified gunsmith only.
- \*\* Restricted availability—Parts installed at factory only.
- \*\*\* Non-restricted availability—Part may require some final fitting sanding or filing.

# PARTS LIST BOLT ACTION RIMFIRE RIFLE

For parts prices, call 1-800-544-8892  
 Be sure to mention gun serial number when ordering parts

ILL. NO.	PART NAME	PART NUMBER	ILL. NO.	PART NAME	PART NUMBER
1	Assembly Post		37	Rear Sight Base	
**2	Barrel		38	Rear Sight Elevator	
3	Barrel Retaining Pin		39	Rear Sight Folding Leaf	
4	Breech Bolt Only		**40	Receiver	
5	Buffer		41	Recoil Spring	
6	Buffer Pin		42	Recoil Spring Guide	
7	Buffer Pin Rings (2)		43	Retaining Ring	
8	Charging Handle		44	Sear	
9	Detent		45	Sear Pin Ring	
10	Detent Spring		46	Sear Spring	
11	Disconnector Spring		47	Sideplate Sub-Assembly, Left Hand	
12	Extractor, Left Hand		48	Sideplate, Right Hand	
13	Extractor, Right Hand		49	Spring Washer	
14	Extractor Pin, Left Hand		50	Stock	
15	Extractor Pin, Right Hand		51	Takedown Screw, Front	
16	Extractor Spring, Left Hand		52	Takedown Screw, Rear	
17	Extractor Spring, Right Hand		53	Trigger Guard Complete	
18	Firing Pin				
19	Firing Pin Retaining Pin				
20	Front Sight Ramp Base				
21	Front Sight Ramp Base Screw				
22	Front Sight Ramp Hood				
23	Front Sight Ramp Insert				
24	Hammer				
25	Hammer Spring				
26	Hammer Strut				
27	Hammer Strut Bridge				
28	Hammer Strut Pin				
29	Hammer Pin Ring				
30	Hammer Spacer				
31	Last Shot Hold Open Assembly				
32	Magazine Complete				
33	Magazine Guide				
34	Magazine Latch & Ejector				
35	Magazine Latch Pin				
36	Magazine Lever Assembly				

\*Restricted availability—Part sent to qualified gunsmith only.      \*\*Restricted availability—Parts installed at factory only.

\*\*\*Non-restricted availability—Part may require some final fitting sanding or filing.

ILL. NO.	PART NAME	Model 795SS	Model 795	Model 7000
		Part No.	Part No.	Part No.
1	Assembly Post	407997	407997	407997
**2	Barrel	107371	107370	107070
3	Barrel Retaining Pin	307897	307897	307897
4	Breech Bolt Only	107014	107013	107013
5	Buffer	407182	407182	407182
6	Buffer Pin	307698	307698	307698
7	Buffer Pin Rings (2)	407178	407178	407178
8	Charging Handle	207006	207005	207005
9	Detent	407753	407753	407753
10	Detent Spring	407294	407294	407294
11	Disconnecter Spring	407196	407196	407196
12	Extractor, Left Hand	320269	320269	307269
13	Extractor, Right Hand	320369	320369	307369
14	Extractor Pin, Left Hand	320798	320798	320798
15	Extractor Pin, Right Hand	307097	307097	307097
16	Extractor Spring, Left Hand	407895	407895	407895
17	Extractor Spring, Right Hand	407895	407895	407895
18	Firing Pin	407699	407599	407599
19	Firing Pin Retaining Pin	307198	307198	407198
20	Front Sight Ramp Base	220939	330144	NA
21	Front Sight Ramp Base Screw	321091	320593	NA
22	Front Sight Ramp Hood	316145	NA	NA
23	Front Sight Ramp Insert	407444	NA	NA
24	Hammer	407173	407173	407173
25	Hammer Spring	407094	407094	407094
26	Hammer Strut	407179	407179	407179
27	Hammer Strut Bridge	307075	307075	307075
28	Hammer Strut Pin	407199	407199	407199
29	Hammer Pin Ring	407178	407178	407178
30	Hammer Spacer	420176	420176	420176
31	Last Shot Hold Open Assembly	507483	507683	507683
32	Magazine Complete	407135	407135	407135
33	Magazine Guide	207449	207449	207449
34	Magazine Latch & Ejector	307348	307348	307348
35	Magazine Latch Pin	320797	320797	320797
36	Magazine Lever Assembly	507583	507583	507583
37	Rear Sight Base	520041	220641	NA
38	Rear Sight Elevator	330442	320942	NA
39	Rear Sight Folding Leaf	214142	NA	NA
**40	Receiver	107260	107160	107160
41	Recoil Spring	307496	307496	307496
42	Recoil Spring Guide	307071	307071	307071
43	Retaining Ring	407178	407178	407178
44	Sear	307151	307151	307151
45	Sear Pin Ring	407178	407178	407178
46	Sear Spring	407995	407995	407995
47	Sideplate Sub-Assembly, Left Hand	507464	507464	507464
48	Sideplate, Right Hand	207763	207763	207763
49	Spring Washer	416052	416052	416052
50	Stock	407630	407638	407738
51	Takedown Screw, Front	307191	307091	307091
52	Takedown Screw, Rear	307792	307392	307392
53	Trigger Guard Complete	507758	507278	507278

\*Restricted availability—Part sent to qualified gunsmith only.

\*\*Restricted availability—Parts installed at factory only.

\*\*\*Non-restricted availability—Part may require some final fitting sanding or filing.

Model 70PSS			Model 717M2		
ILL. NO.	PART NAME	Part No.	ILL. NO.	PART NAME	Part No.
1	Assembly Post	407997	1	Assembly Post	407997
**2	Barrel	107119	**2	Barrel	107018
3	Barrel Retaining Pin	307897	3	Barrel Retaining Pin	307897
4	Breech Bolt Only	107014	4	Breech Bolt Only	107019
5	Buffer	407182	5	Buffer	407007
6	Buffer Pin	NA	6	Buffer Pin	307698
7	Buffer Pin Rings (2)	407178	7	Buffer Pin Rings (2)	407178
8	Charging Handle	207006	8	Charging Handle	207007
9	Detent	407753	9	Detent	407753
10	Detent Spring	407294	10	Detent Spring	407294
11	Disconnecter Spring	407196	11	Disconnecter Spring	407196
12	Extractor, Left Hand	307269	12	Extractor, Left Hand	320269
13	Extractor, Right Hand	307369	13	Extractor, Right Hand	320369
14	Extractor Pin, Left Hand	320798	14	Extractor Pin, Left Hand	320798
15	Extractor Pin, Right Hand	307097	15	Extractor Pin, Right Hand	307004
16	Extractor Spring, Left Hand	407895	16	Extractor Spring, Left Hand	407495
17	Extractor Spring, Right Hand	407895	17	Extractor Spring, Right Hand	407495
18	Firing Pin	407699	18	Firing Pin	407699
19	Firing Pin Retaining Pin	307198	19	Firing Pin Retaining Pin	307198
20	Front Sight Ramp Base	207039	20	Front Sight	330144
21	Front Sight Ramp Base Screw	320991	21	Front Sight Screw	320593
22	Front Sight Ramp Hood	316145	22	Front Sight Ramp Hood	NA
23	Front Sight Ramp Insert	230744	23	Front Sight Ramp Insert	NA
24	Hammer	407173	24	Hammer	407173
25	Hammer Spring	407094	25	Hammer Spring	407094
26	Hammer Strut	407179	26	Hammer Strut	407179
27	Hammer Strut Bridge	307075	27	Hammer Strut Bridge	307075
28	Hammer Strut Pin	407199	28	Hammer Strut Pin	407199
29	Hammer Pin Ring	407178	29	Hammer Pin Ring	407178
30	Hammer Spacer	420176	30	Hammer Spacer	420176
31	Last Shot Hold Open Assembly	507483	31	Last Shot Hold Open Lever	307003
32	Magazine Complete	404046	32	7 Shot Magazine	407246
33	Magazine Guide	207449	33	Magazine Guide	207449
34	Magazine Latch & Ejector	307048	34	Magazine Latch & Ejector	307005
35	Magazine Latch Pin	320797	35	Magazine Latch Pin	320797
36	Magazine Lever Assembly	507583	36	Magazine Lever Assembly	507583
37	Rear Sight Base	520142	37	Rear Sight	220641
38	Rear Sight Elevator	330442	38	Rear Sight Elevator	320942
39	Rear Sight Folding Leaf	214142	39	Rear Sight Folding Leaf	NA
**40	Receiver	107360	**40	Receiver	107023
41	Recoil Spring	307496	41	Recoil Spring	307496
42	Recoil Spring Guide	307071	42	Recoil Spring Guide	307071
43	Retaining Ring	407178	43	Retaining Ring	416252
44	Sear	407151	44	Sear	307151
45	Sear Pin Ring	407178	45	Sear Pin Ring	407178
46	Sear Spring	407995	46	Sear Spring	407995
47	Sideplate Sub-Assembly, Left Hand	507464	47	Sideplate Sub-Assembly, Left Hand	207014
48	Sideplate, Right Hand	207763	48	Sideplate, Right Hand	207013
49	Spring Washer	416052	49	Spring Washer	416000
50	Stock	407226	50	Stock	120523
51	Takedown Screw, Front	307191	51	Takedown Screw, Front	307191
52	Takedown Screw, Rear	307792	52	Takedown Screw, Rear	307792
53	Trigger Guard Complete	507758	53	Trigger Guard Complete	507758
**53	Receiver Adapter	307366	54	Last Shot Hold Open Pivot Pin	407009
54	Takedown Nut	307766			
55	Spanner Wrench	207012			
56	Case Only	807005			
57	Foam Packing	445705			

\*Restricted availability—Part sent to qualified gunsmith only.

\*\*Restricted availability—Parts installed at factory only.

\*\*\*Non-restricted availability—Part may require some final fitting sanding or filing.

## Repair Instructions

---

Your firearm has been designed and manufactured in accordance with Marlin's rigid quality control standards. However, any mechanical device may occasionally require adjustment or repair.

Questions regarding the performance and serviceability of your firearm should be addressed to our Gun Service Division at 1-800-544-8892. You should include the Serial Number, Model Number and a full description of the conditions and problems involved.

## Warranty Repairs

---

Our Warranty policy covers all our firearms against defects in workmanship or material for a period of five years from the date of purchase to the original owner. See the inside front cover of this manual for warranty details.

Guns requiring warranty repairs should be returned to the factory. Be sure to follow the "Shipping and Handling" instructions on this page.

## Non-Warranty Repairs

---

A competent gunsmith may be able to repair your gun. If not, ship it to the factory, following the "Shipping and Handling" instructions on this page.

After receiving your firearm, we will send you an estimate of the repair cost. Repairs will begin upon receipt of your check or money order. If repairs are not possible, your gun will be returned.

## Shipping and Handling

---

When sending your firearm to the factory, you must follow these instructions:

1. Prior to mailing, be absolutely certain that the chamber and magazine of your firearm are not loaded.
2. Pack your gun carefully. Use ample cushioning and a sturdy outer cardboard box. Do not ship in a special container which you want returned.
3. Accessories such as scopes, scope mounts, gun case, quick detach type swivels, sling straps and other special appointments should be removed prior to returning the firearm.
4. Inside the box, include a sheet with the following information: model number, serial number, description of damage or problem, and under what conditions difficulty occurs.
5. ***Keep a record of your serial number when returning a firearm.***
6. Clearly mark your return address on the outside of the box and on your instruction sheet.
7. Do not ship live ammunition under any circumstances.
8. Ship your firearm via insured Parcel Post or U.P.S. prepaid and addressed to:

**MFC INC.  
ATTN: SERVICE DEPT.  
100 KENNA DRIVE  
NORTH HAVEN, CONN. 06473**

# The Fascinating History of Marlin

**W**ritten by the late William S. Brophy, Marlin's Senior Technical Manager and Official Company Historian for many years, this prodigious book details the history of the Marlin Firearms Co. and its products. The hardbound volume contains more than 600 pages and over 1000 illustrations. Must reading for anyone interested in all the models — pistols, rifles and shotguns — made by Marlin, and in the story of more than a century of firearms production in America.

For more information, write:

**Marlin Firearms Co.  
Department OM  
100 Kenna Drive  
North Haven, CT 06473**

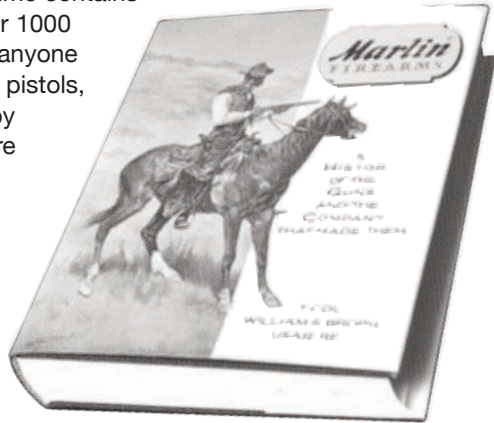



## IMPORTANT

If you have any questions or problems relating to your new Marlin, would like additional information on safe operation, or wish to order parts or accessories, just call our Customer Service Center. A Service Representative can be reached at the number listed below, between 8 A.M. and 4:30 P.M. (Eastern Time), Monday through Friday.

**1-800-544-8892 (Toll Free)**

**Please record the firearm serial number, date of purchase and where purchased below.**

Serial #: \_\_\_\_\_

Date of Purchase: \_\_\_\_\_

Purchased From: \_\_\_\_\_

**In case of loss or theft, supply this information to the proper authorities.**



### WARNING

**Children are attracted to and can operate firearms that can cause severe injuries or death.**

**Prevent child access by always keeping guns locked away and unloaded when not in use. If you keep a loaded firearm where a child obtains and improperly uses it, you may be fined or sent to prison.**



### ADVERTENCIA

**A los niños los atraen las armas de fuego y las pueden hacer funcionar. Ellos pueden causarse lesiones graves y la muerte.**

**Evite que los niños tengan acceso a las armas de fuego guardándolas siempre con llave y descargadas cuando no las esté utilizando. Si usted tiene un arma de fuego cargada en un lugar en que un niño tiene acceso a ella y la usa indebidamente, le pueden dar una multa o enviarlo a la cárcel.**

**Health Warning:** Discharging of firearms in poorly ventilated areas and handling ammunition may cause exposure to lead and/or lead compounds. Exposure may cause cancer, birth defects or damage to the kidney, nervous, blood forming and reproductive systems. Have adequate ventilation at all times, especially in confined areas. Wash hands thoroughly after shooting, handling ammunition, or cleaning a firearm. Do not eat or smoke during these activities.

**Safety Warning:** Marlin strongly recommends that you take a hunter safety course, taught by a certified instructor, before you use this firearm. Your State Fish & Game Dept. or a local gun shop can suggest courses in your area.

**Safety Warning:** Keep this firearm out of the reach of children, unauthorized individuals, and others unfamiliar with the safe handling of firearms.