

# READ THESE INSTRUCTIONS BEFORE USING THIS GUN

MODEL  
SHOWN  
C22LRB

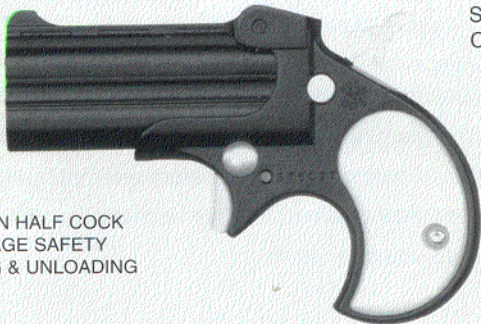

## WARNING

PLACE HAMMER IN HALF COCK  
POSITION & ENGAGE SAFETY  
BEFORE LOADING & UNLOADING



COBRA ENTERPRISES, INC.

## GUN SAFETY

# WARNINGS

Do not use this derringer until you have completely read this instruction manual. We strongly recommend that you seek competent firearms instruction before attempting to use this gun. Failure to follow these gun safety instructions may result in injury or death to you or another.

## WARNINGS

1. *ALWAYS* use proper shooting glasses to prevent eye injury!
2. *ALWAYS* use hearing protection to prevent ear damage!
3. **Never carry a gun loaded** while walking, or climbing or anywhere you might slip and fall, dropping the gun. A gun that is dropped, bumped or jarred with a live round in the chamber it might accidentally discharge even with the safety on causing injury to you or someone else.
4. **Never carry a loaded gun** in a motor vehicle and never carry a loaded gun into a dwelling.

5. **Never rely on the safety** to prevent accidental discharge. The safety may not prevent an accidental discharge due to dropping, jarring or bumping of the gun.
6. **Never alter any part in your gun.** Only use Cobra Enterprises replacement parts.
7. **Only use factory loaded ammunition** for which the gun is chambered as indicated on the barrel to prevent excessive pressure and possible serious personal injury.
8. **Reloaded ammunition can cause serious injury** and damage to the firearm due to stress failure and/or excessive pressure.
9. **Always check the barrel to insure that it is free of obstructions** before loading and firing the firearm. If you experience a light recoil or "off" sound, CHECK THE BARREL.

10. **Never point a gun at anything you do not intend to shoot.**
11. **Always keep your gun pointed in a safe direction** while loading and unloading to prevent serious injury in case of accidental discharge.
12. **Never place your finger on the trigger** unless you are ready to shoot.
13. **Never shoot at a hard flat surface or at any water surface** to avoid a ricochet and possible serious injury to yourself or a bystander.
14. **Always store guns unloaded in a safe or lock box** separate from ammunition and in a clean dry place **out of reach of children.**

### **LEAD WARNING**

Discharging firearms in a poorly ventilated area, cleaning firearms or handling ammunition may result in exposure to lead, a substance known to cause birth defects, reproductive harm and other serious physical injury. Have adequate ventilation at all times. Wash hands thoroughly after exposure or prior to eating and or drinking.

### **PRECAUTIONS BEFORE USING**

We strongly advise that you familiarize yourself with all the mechanisms of this gun, or any gun, before using it. We provide reasonable care in the manufacture of this pistol, but assume no responsibility for its care, handling and use!

**ALL FIREARMS ARE DANGEROUS**  
**PLEASE BE CAREFUL!**

### **LOADING INSTRUCTIONS**

1. Place hammer in **HALF-COCK POSITION**, and **SAFETY ENGAGED, TO SAFE POSITION**.
2. Disengage the locking lever by turning forward to the unlocked position.
3. Pull the barrel back exposing the breach.
4. Insert a cartridge into each chamber. **Only use standard factory ammunition that the derringer was chambered for. Do not load or fire reloaded, hot loaded, or plus "P" cartridges. These types of ammunition can be dangerous to you or your derringer.**
5. Be sure the hammer is still in HALF-COCK position, and SAFETY ENGAGED, lower the barrel into the frame, pointing in a safe direction and re-engage the locking lever to the lock position.

## **FIRING INSTRUCTIONS**

1. Make sure you are wearing your proper hearing and eye protection.
2. Make sure that your target is clear of any person or hard surfaces, including water to avoid a ricochet and possible serious injury to yourself or a bystander.
3. Point the gun in a safe position while cocking the hammer into the fully cocked position.
4. Disengage the safety to the fire position.
5. Aim the pistol at your intended target with your finger off the trigger until you are ready to fire.
6. Before firing make sure all fingers and hands are away from the muzzle.

7. Once fired the selector automatically selects to the next barrel.
8. To fire the other barrel repeat procedures 3, 5 and 6.
9. DO NOT DRY FIRE!

## **UNLOADING INSTRUCTIONS**

1. Place hammer in **HALF-COCK POSITION**, and **SAFETY ENGAGED, TO SAFE POSITION.**
2. Disengage the locking lever by turning forward to the unlocked position.
3. Pull the barrel back exposing the breach.
4. Remove the cartridges by sliding the extractor away from the Barrel allowing you to remove the cartridges from the barrel chambers.

### CLEANING

Cobra Enterprises recommends cleaning all guns after use. Avoid using powerful gun solvents. We recommend using WD40 or other similar light oil products.

### STORING

**Always store guns unloaded in a safe or lock box** separate from ammunition and in a clean dry place **out of reach of children.**

### AMMUNITION NOTES

1. FOR BEST SHOOTING AND FUNCTION WE RECOMMEND FEDERAL, AMERICAN EAGLE AND PMC AMMUNITION (ON ALL COBRA PRODUCTS).
2. C-22M Derringer we recommend using Federal .22mag ammunition.
3. To load or unload the CB9 you must first push the extractor all the way out and hold it in that position while inserting or removing ammunition.
4. Cobra .32 H&R Magnum Derringer is designed to fire Federal .32 H&R Magnum ammunition ONLY.

## ALWAYS REMEMBER

1. Always keep this derringer in the **half-cock** hammer position and **safety engaged**.
2. Keep all firearms out of reach from children.
3. Keep all firearms stored in a safe or lock box and separate from ammunition.
4. Do not drop or mishandle this gun when loaded, as it may fire if dropped.
5. Never point this gun at anything you do not intend to shoot.
6. Never shoot any firearms while on any type of drug or alcohol.

## STANDARD SERIES

MODEL SHOWN C22LR



MODEL C022, C22M, C-25, AND C-32

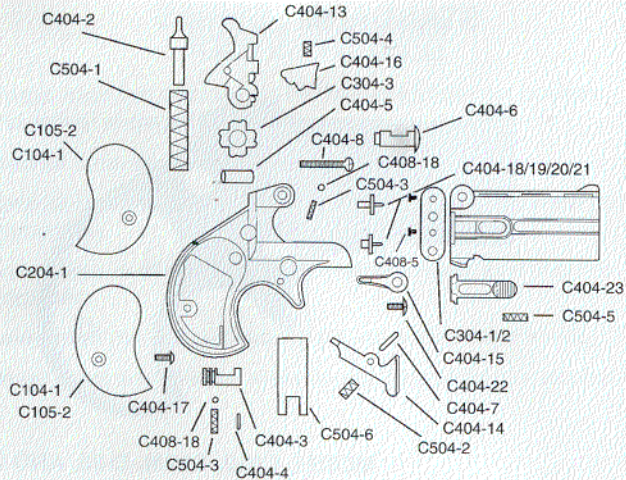

## Standard Series Parts

STOCK NO.	Part Name	Price	STOCK NO.	Part Name	Price
C204-1	Frame	N.A.	C404-15	Locking Lever	1.50
C405-1	Barrel	N.A.	C105-2	Wood Grip	8.00
C404-13	Hammer	8.00	C104-1	Pearl Grip	7.00
C404-16	Selector	6.00	C504-6	Cam Spring	1.00
C304-3	Cam	3.00	C404-23	Extractor	N.A.
C404-14	Trigger	7.00	C404-5	Hammer Pivot Pin	1.50
C404-20	Firing Pin, Top (for D-25, D-32 only)	3.50	C404-7	Trigger Pin	1.50
C404-6	Lock	4.00	C404-4	Safety Pin	1.00
C404-21	Firing Pin, Btm (for D-22, DM-22 only)	3.50	C404-8	Hinge Screw	1.50
C404-3	Safety	4.00	C404-22	Lock Screw	1.00
C404-2	Guide Pin	2.00	C404-17	Grip Screw	1.50
C504-1	Main Spring	2.00	C408-18	Safety Ball	1.00
C304-1	Firing Pin Plate (center fire)	3.50	C504-4	Selector Spring	1.00
C404-24	Firing Pin Plate Scew	1.00	C504-2	Trigger Spring	1.00
C304-2	Firing Pin Plate (rim fire)	3.50	C504-5	Extractor Spring	1.00



# BIG BORE & LONG BORE SERIES

MODEL  
SHOWN  
CB38

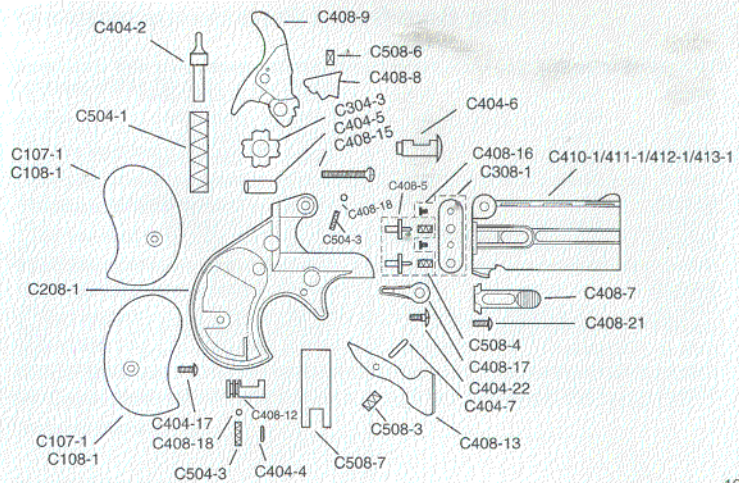
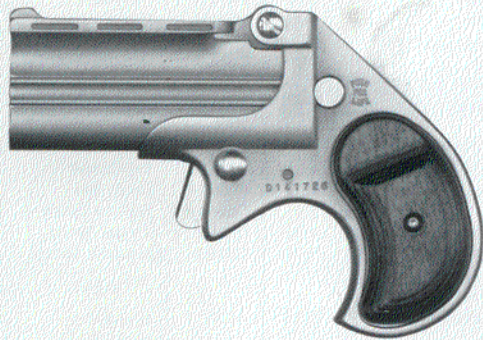

# Big Bore Series Parts

STOCK NO.	Part Name	Price	STOCK NO.	Part Name	Price
C208-1	Frame	N.A.	C408-17	Locking Lever	1.50
C410-1	Barrel	N.A.	C105-2	Wood Grip	8.00
C408-9	Hammer	8.00	C108-1	Black Grip	4.00
C408-8	Selector	6.00	C508-7	Cam Spring	1.00
C304-3	Cam	3.00	C408-7	Extractor	N.A.
C408-13	Trigger	7.00	C404-5	Hammer Pivot Pin	1.50
C408-5	Firing Pin	3.50	C404-7	Trigger Pin	1.50
C504-1	Main Spring	2.00	C404-4	Safety Pin	1.00
C404-2	Guide Pin	2.00	C408-15	Hinge Screw	1.50
C404-22	Lock Screw	1.00	C404-17	Grip Screw	1.50
C408-18	Lock & Safety Ball	1.00	C404-6	Lock	4.00
C504-4	Selector Spring	1.00	C408-21	Extractor Screw	1.50
C408-12	Safety	4.00	C508-3	Trigger Spring	1.00
C308-1	Firing Pin Plate	3.50	C504-3	Lock & Safety Spring	1.00
C508-4	Firing Pin Spring	1.00	C408-16	Firing Plate Screw	1.00

## YOUR LIFETIME WARRANTY

To activate this warranty you must complete this card and mail, with proper postage, within 30 days of purchase.

MODEL \_\_\_\_\_ CALIBER \_\_\_\_\_ DATE PURCHASE \_\_\_\_/\_\_\_\_/\_\_\_\_

1. Is this your first purchase of a firearm? YES/NO
2. Did you receive this pistol in a DAVIS INDUSTRIES box with the operating instructions for the pistol you purchased? YES/NO
3. Did you read and understand all of the operating instructions? YES/NO
4. Did you receive any verbal instruction from a competent firearms instructor, on the safe handling of this pistol? YES/NO

IF YOU ANSWERED NO TO 4. OR 5., IT IS OUR **STRICT RECOMMENDATION** FOR YOUR SAFETY AND THE SAFETY OF OTHERS, THAT YOU DO NOT ATTEMPT TO LOAD, OR OPERATE, THIS PISTOL UNTIL YOU HAVE OBTAINED SAFE HANDLING INSTRUCTIONS BY A QUALIFIED FIREARMS INSTRUCTOR!

Customer Name (Print) \_\_\_\_\_

Customer Signature \_\_\_\_\_

CUT AND MAIL

**THIS IS YOUR LIFETIME  
WARRANTY CARD**

PLEASE MAIL IN AN ENVELOPE

**COBRA ENTERPRISES, INC.**  
1960 S. MILESTONE DRIVE SUITE F  
SALT LAKE CITY, UT 84104  
801-908-8300

**SAFETY GLASSES SHOULD BE WORN AT ALL TIMES  
REMEMBER, CARELESSNESS CAUSES CALAMITY.  
LEARN TO BE A SAFE SHOOTER SO THAT YOU CAN  
ENJOY YOUR PISTOL FOR MANY YEARS.  
THERE ARE NO SAFE GUNS... THERE ARE ONLY**

**SAFE GUN OWNERS.**

**RESPECTFULLY**





**1960 S. MILESTONE DRIVE, SUITE F**

**SALT LAKE CITY, UT 84104**

**801-908-8300**

**[www.cobrapistols.com](http://www.cobrapistols.com)**