



PRECISION TURRET SHOOTING REST

Assembly, Use and Care Instructions

Product #821400 Instruction #1080868 Rev. A



Thank you for purchasing the Caldwell® Precision Turret Shooting Rest. We have provided the necessary tools to make your assembly as convenient as possible. To ensure proper function of your new rest, please follow these instructions carefully.

STOP!

If you have a problem with this product, **DON'T RETURN IT TO THE STORE WHERE YOU PURCHASED IT.** Contact customer service at...

Battenfeld
Technologies, Inc.

2501 LeMone Industrial Blvd. / Columbia, MO 65201

573-445-9200 / Email: sales@btibrands.com

Or visit our website @ www.BTibrands.com

NOT WARRANTED AGAINST MISUSE, ABUSE, OR COMMERCIAL USE.

Limited Warranty

Every Caldwell product is warranted to be free of defects in materials and workmanship for a period of one (1) year from the date of original purchase. Caldwell will, at its option, repair or replace without charge, except for transportation costs, parts that fail under normal use and service when operated and maintained in accordance with our Instructions. This warranty does not apply to normal wear or to items whose life is dependent upon their use and care. This warranty is in lieu of all other warranties, expressed or implied and releases Caldwell, its affiliates, and its vendors from all other obligations and liabilities.

ASSEMBLY INSTRUCTIONS:

Lay out all of the components to ensure everything has been included.
See reference parts photo below. Some components may vary slightly in appearance.

1. Front Rest Clamp Assembly
2. (4) M6 Screws
3. Pivot Hub Assembly
4. Pan Control Knob
5. Front Leg Assembly
6. Left Rear Leg Assembly
7. Universal Grip Rest Assembly
8. Right Rear Leg Assembly
9. (5) M8 Screws

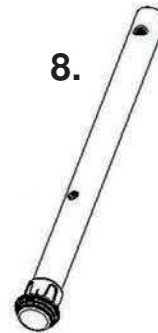
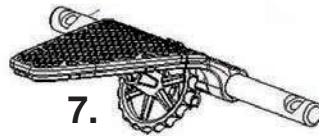
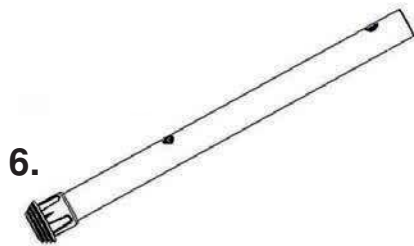
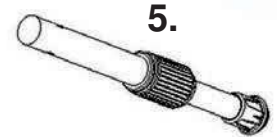
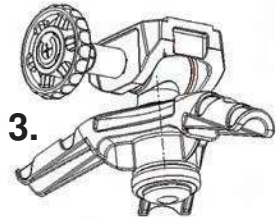
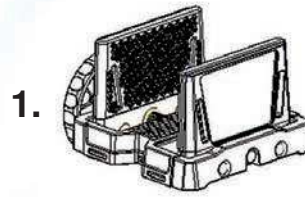

STEP 1: FRONT REST CLAMP ASSEMBLY AND PIVOT HUB ASSEMBLY

1. Remove the (4) M6 Screws from the clamp base (these are pre-installed for quality purposes).
2. Rotate the Pivot Hub Assembly to enable the insertion of each M6 Screw. (Fig. A)
3. Secure all four screws using the supplied L-Key.
4. Thread the Pan Control Knob into the Pivot Hub Assembly until secure. (Fig. B)

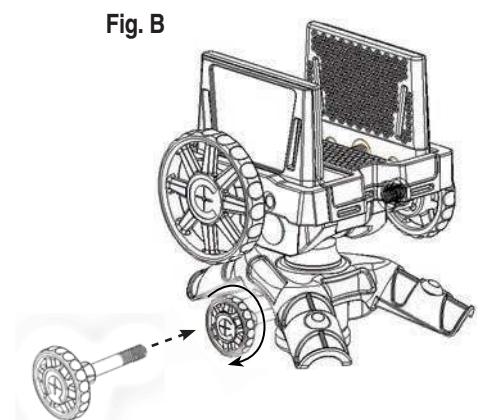
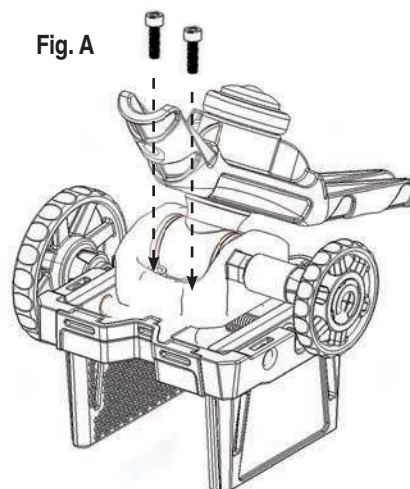
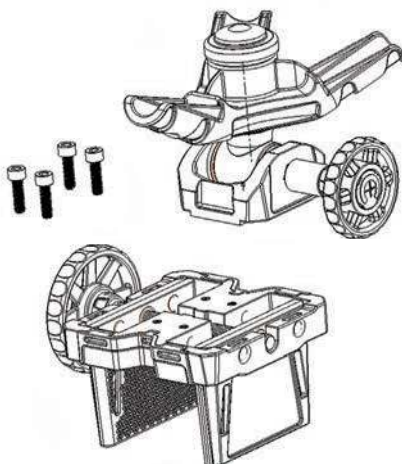

STEP 2: LEG ASSEMBLY

1. Notice the rear legs are stamped with an "L" or "R" for placement opposite of one another.
2. Position each leg as shown below and secure using the M8 Screws with the supplied L-Key.

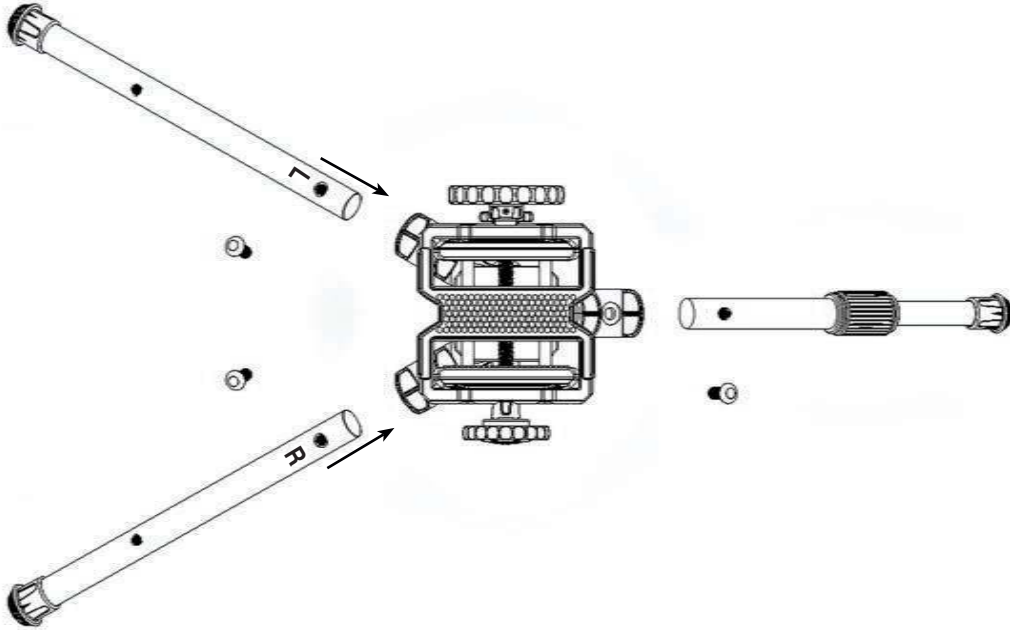

STEP 3 (OPTIONAL): UNIVERSAL GRIP REST ASSEMBLY

1. Position the Universal Grip Rest Assembly as shown and secure using (2) M8 Screws.

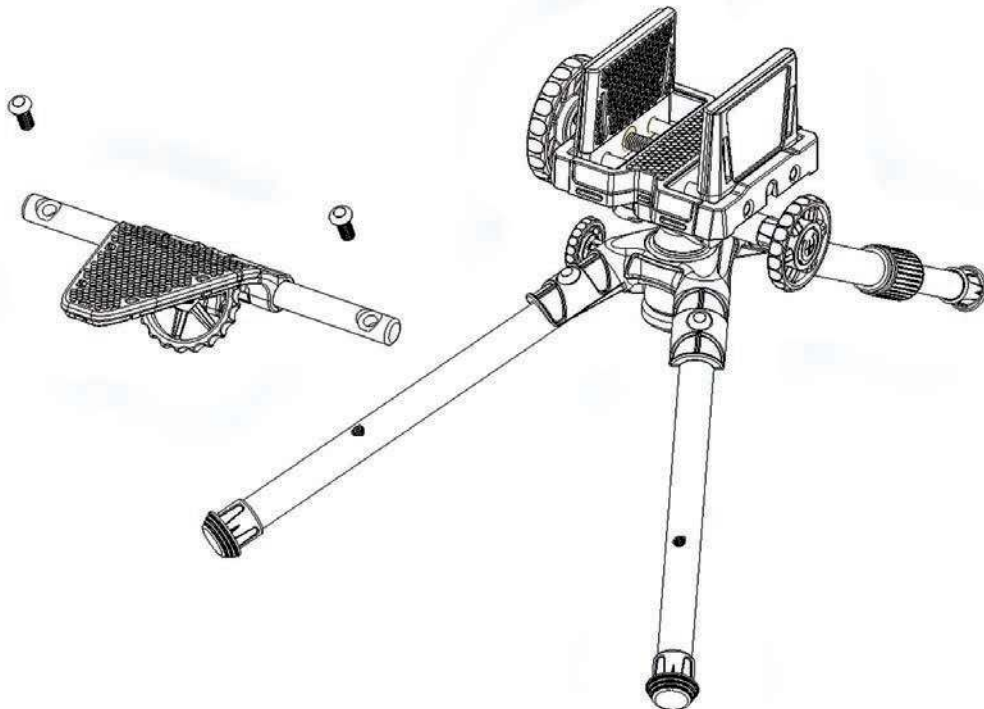

BEFORE USE:

Become familiar with the following features before using your new rest

- **Adjustable clamp feature**

- **Firearm fitment and adjustments**

1. When placing your firearm into the clamp jaw mechanism, position the firearm as far forward as possible. This will help balance the firearm during use. Avoid accessories that can cause unequal clamp pressure and or damage to the clamp jaw pads. **DO NOT OVER CLAMP AS THE FOREND CAN BE DAMAGED.**
2. Use the forend clamp knob to sufficiently apply clamp force to the firearm.
3. Once the firearm has been secured in the clamp, pivot the firearm to rest onto the Grip Rest Assembly.

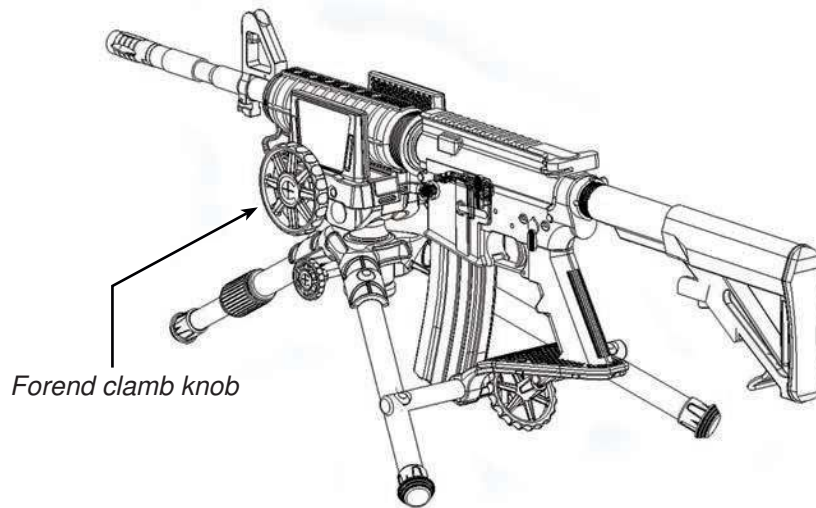

- **Turret Style plinking action configuration**

(uninstall the Grip Rest Assembly)

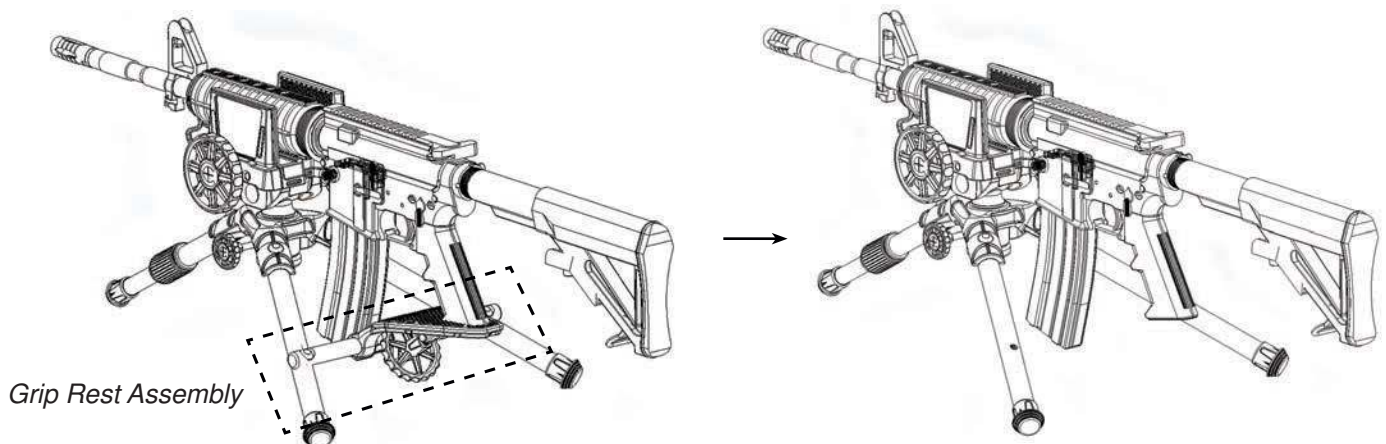

- **Front leg coarse elevation adjustment**

ALWAYS UNLOAD AND REMOVE FIREARM BEFORE MAKING ADJUSTMENT TO THE FRONT LEG ELEVATION.

1. Rotate the turnbuckle to loosen.
2. Pull or push the front leg to set the desired height.
3. Rotate the turnbuckle to lock the leg in place, using sufficient force to maintain a desired setting

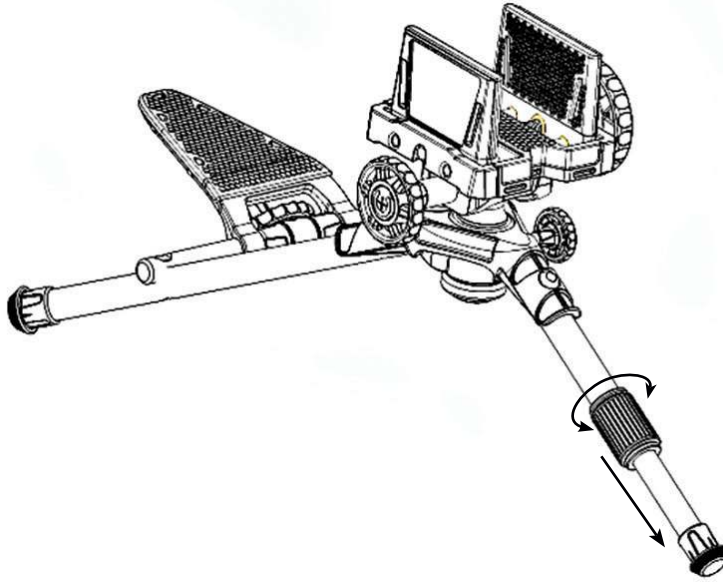

- **Elevation Tilt feature**

1. Adjust tension or lock the elevation tilt using the knob as shown below.
2. Clockwise to tighten, counterclockwise to loosen.

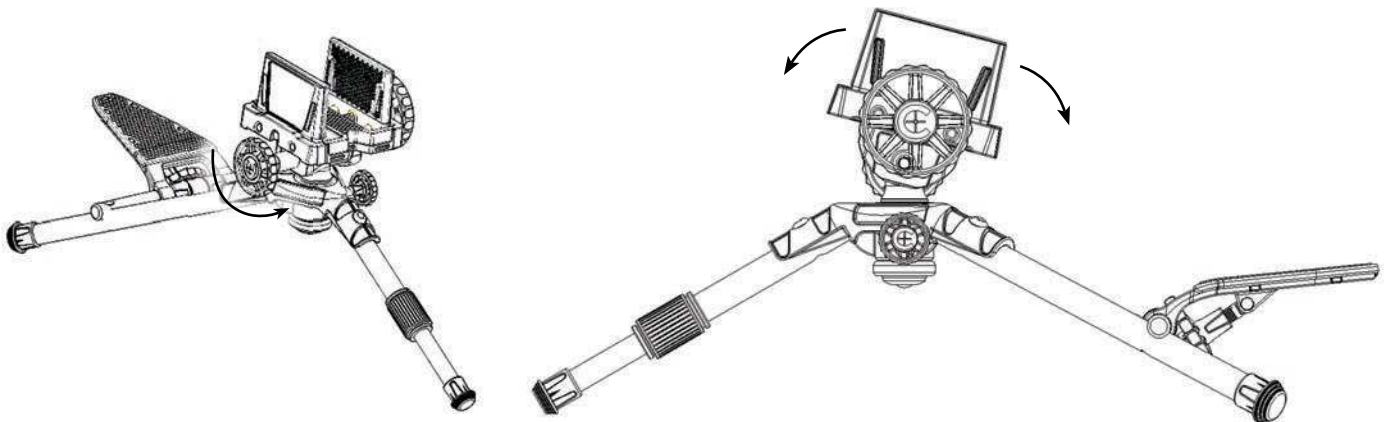

- **Pan feature**

1. Adjust tension or lock the panning movement using the knob as shown below.
2. Clockwise to tighten, counterclockwise to loosen.

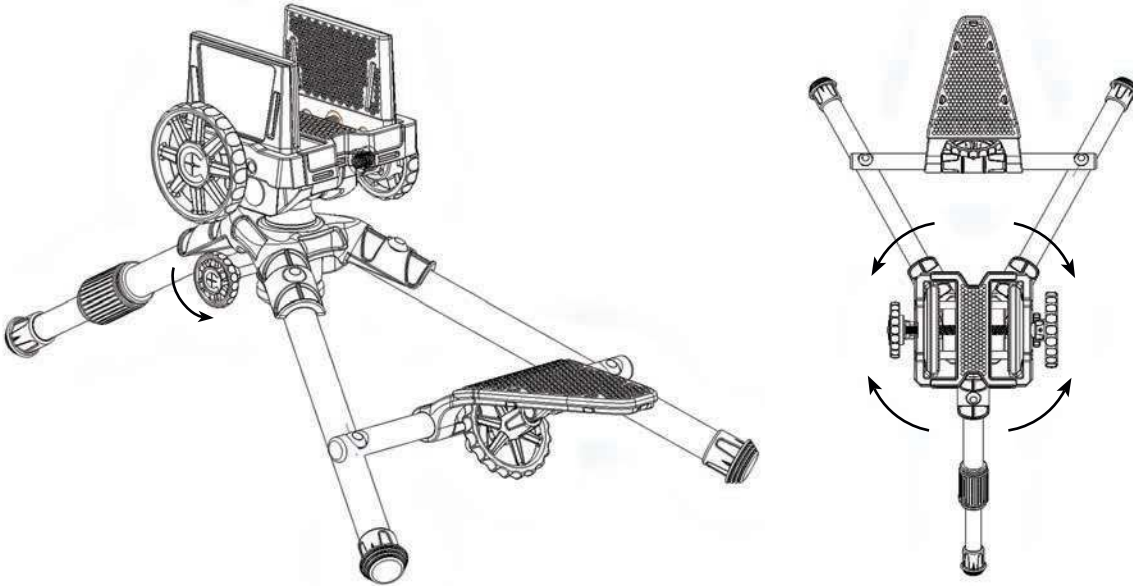

- **Rear fine elevation adjustment**

1. When making adjustments to the rear fine elevation knob, it may be necessary to reduce tension or unlock the tilt and pan mechanisms.

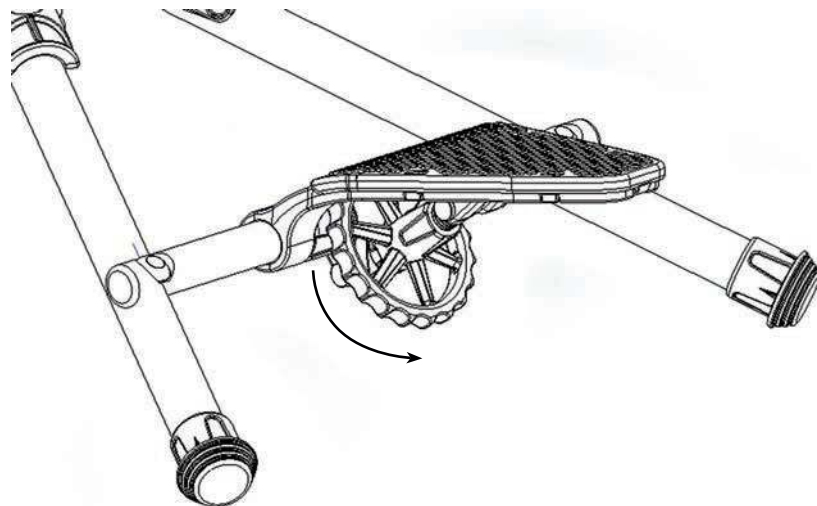

USAGE:

⚠ IMPORTANT SAFETY INFORMATION ⚠

- Always practice safe firearm handling.
 - Always unload and remove the firearm before adjusting the front leg.
1. Place the Precision Turret Shooting Rest on a stable surface.
 2. Loosen the Elevation Tilt Knob to allow easy placement and adjustment of your firearm into the adjustable Forend Clamp. Evaluate the target site picture.
 3. Remove the firearm and make necessary adjustments to the Front Leg Coarse Elevation. Be sure to use adequate force when tightening the leg.
 4. Place the firearm into the adjustable Forend Clamp and secure. Remember to place the firearm as far forward as possible and for the best results avoid unequal clamping surfaces.
 5. Once the firearm has been secured into the Forend Clamp, make the necessary adjustment to the Elevation Tilt Knob feature to allow the grip to rest on the Universal Grip Rest.
 6. Make final adjustments to the Elevation Tilt Knob, Pan Control Knob and Rear Fine Elevation.

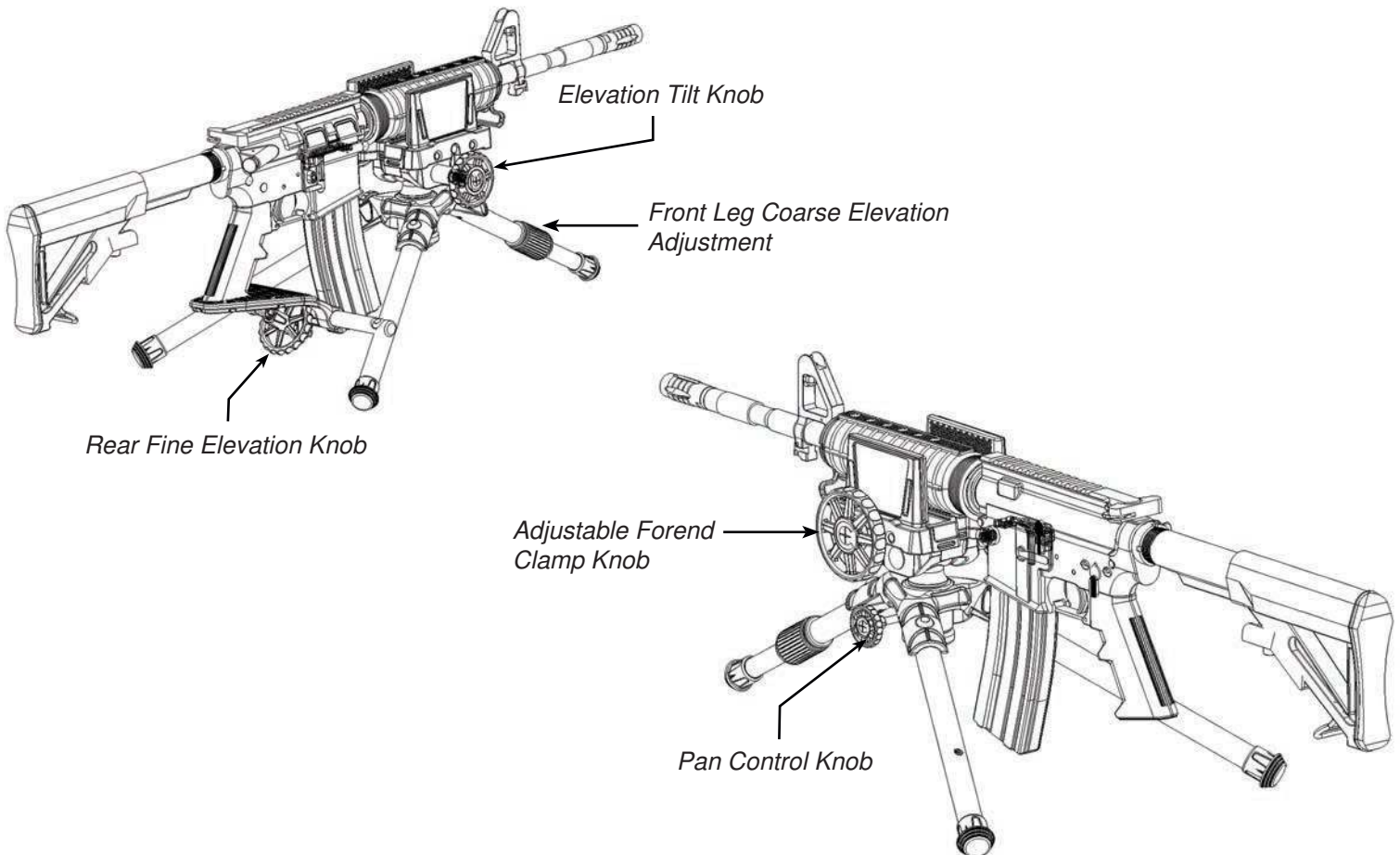



PRECISION TURRET

SHOOTING REST



2501 LeMone Industrial Blvd. / Columbia, MO 65201
573-445-9200 / Email: sales@btibrands.com